

skala 1:2

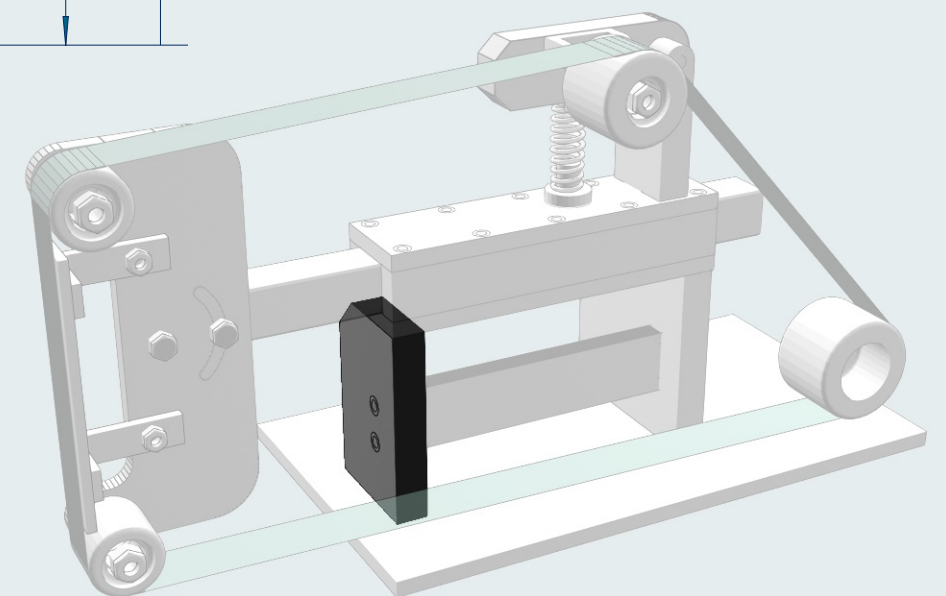

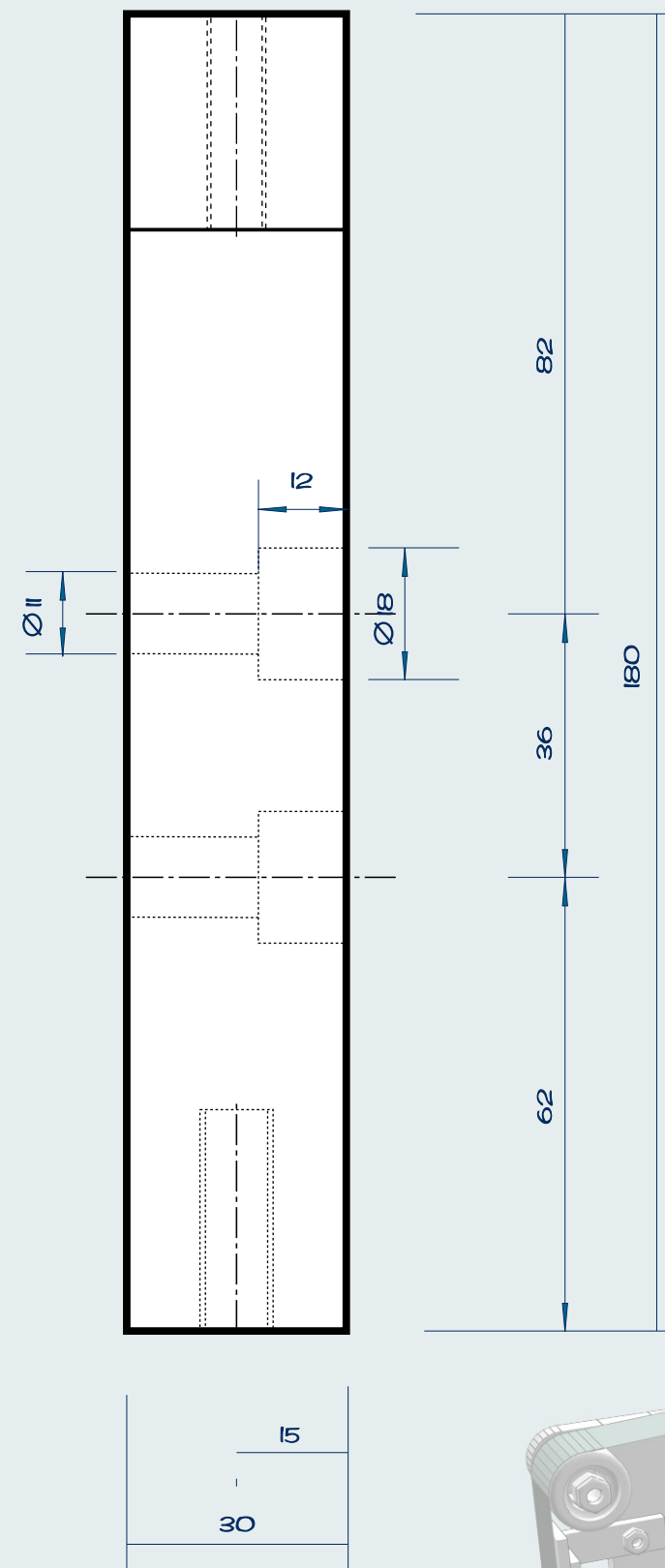

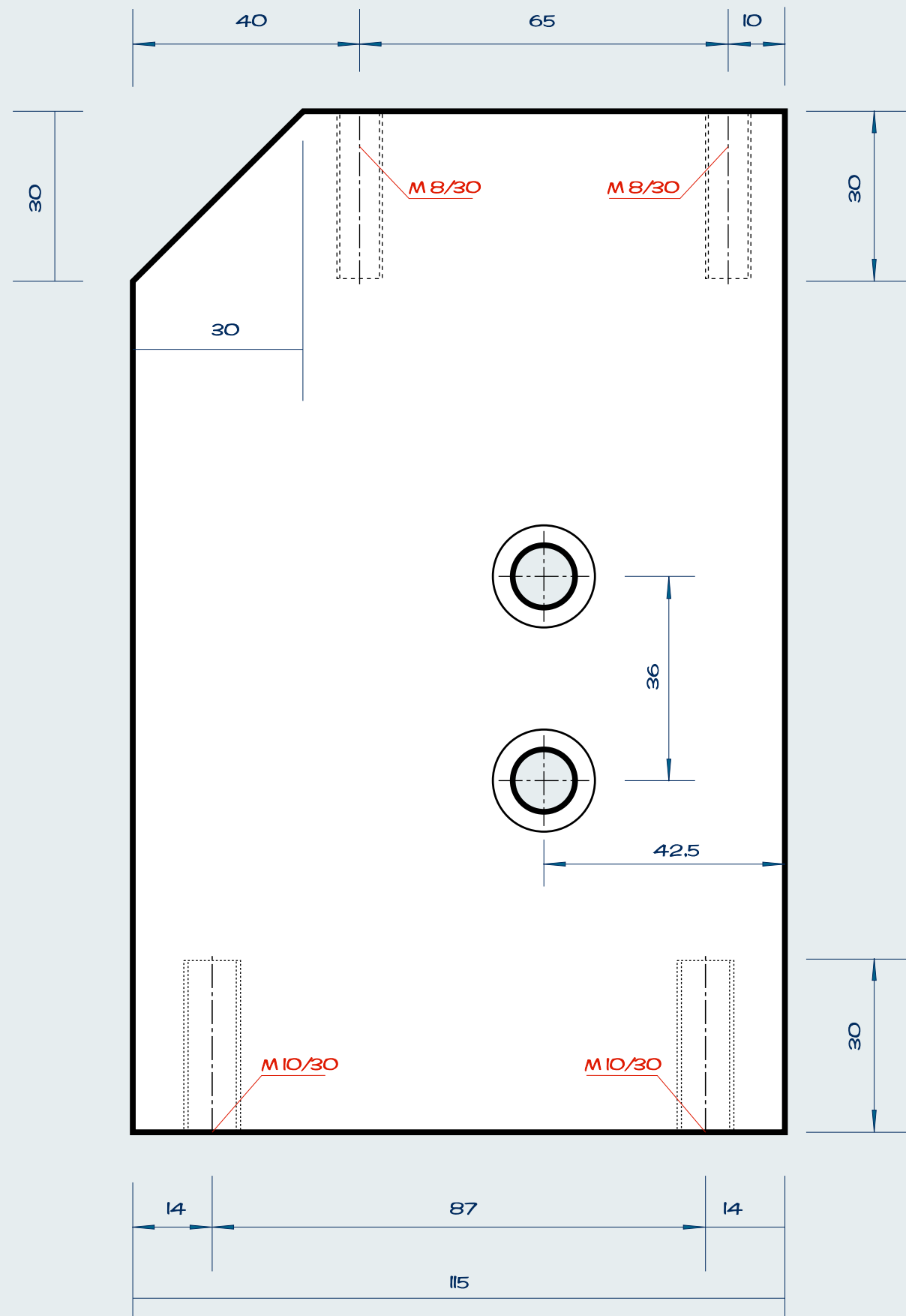
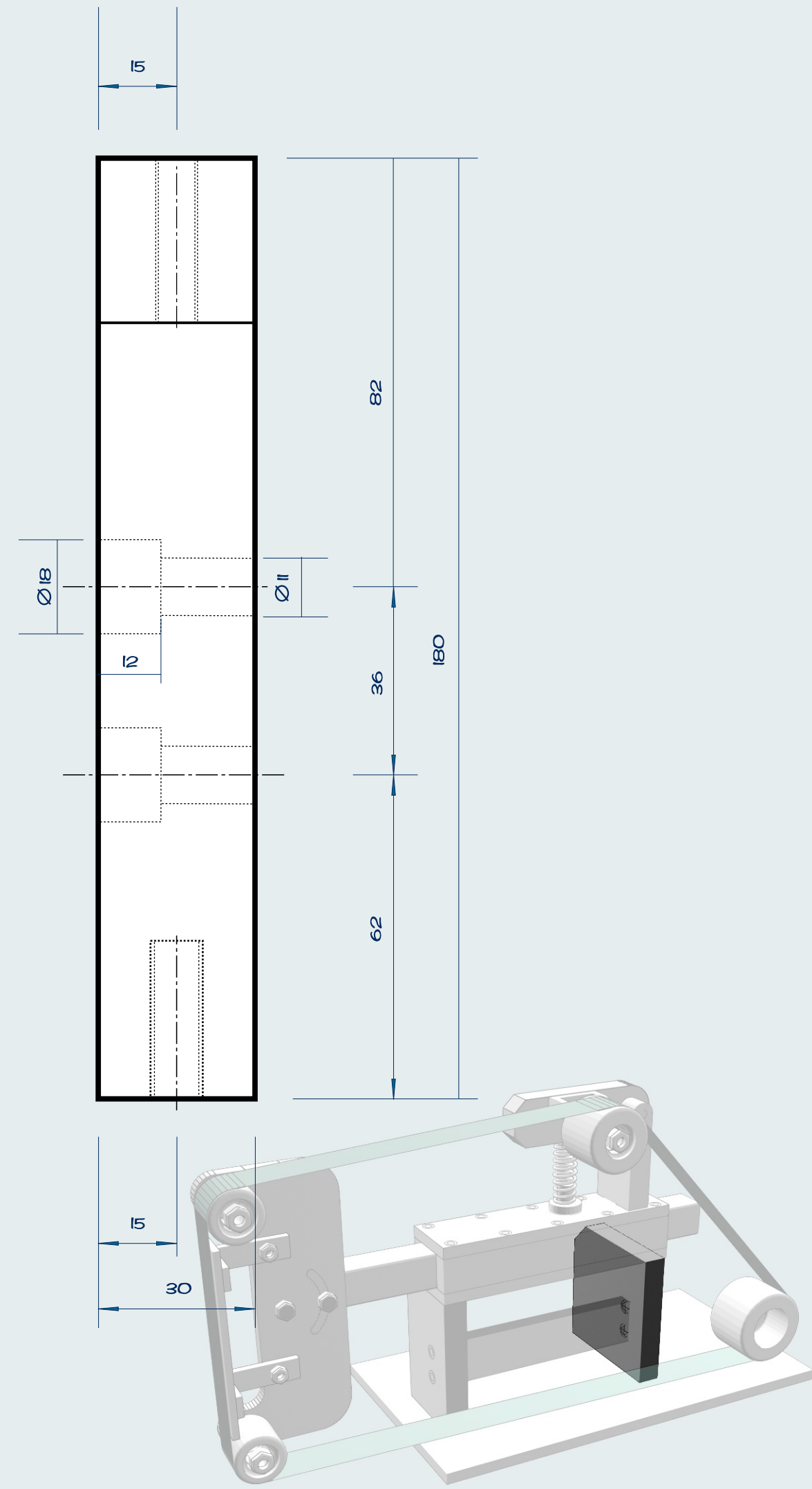
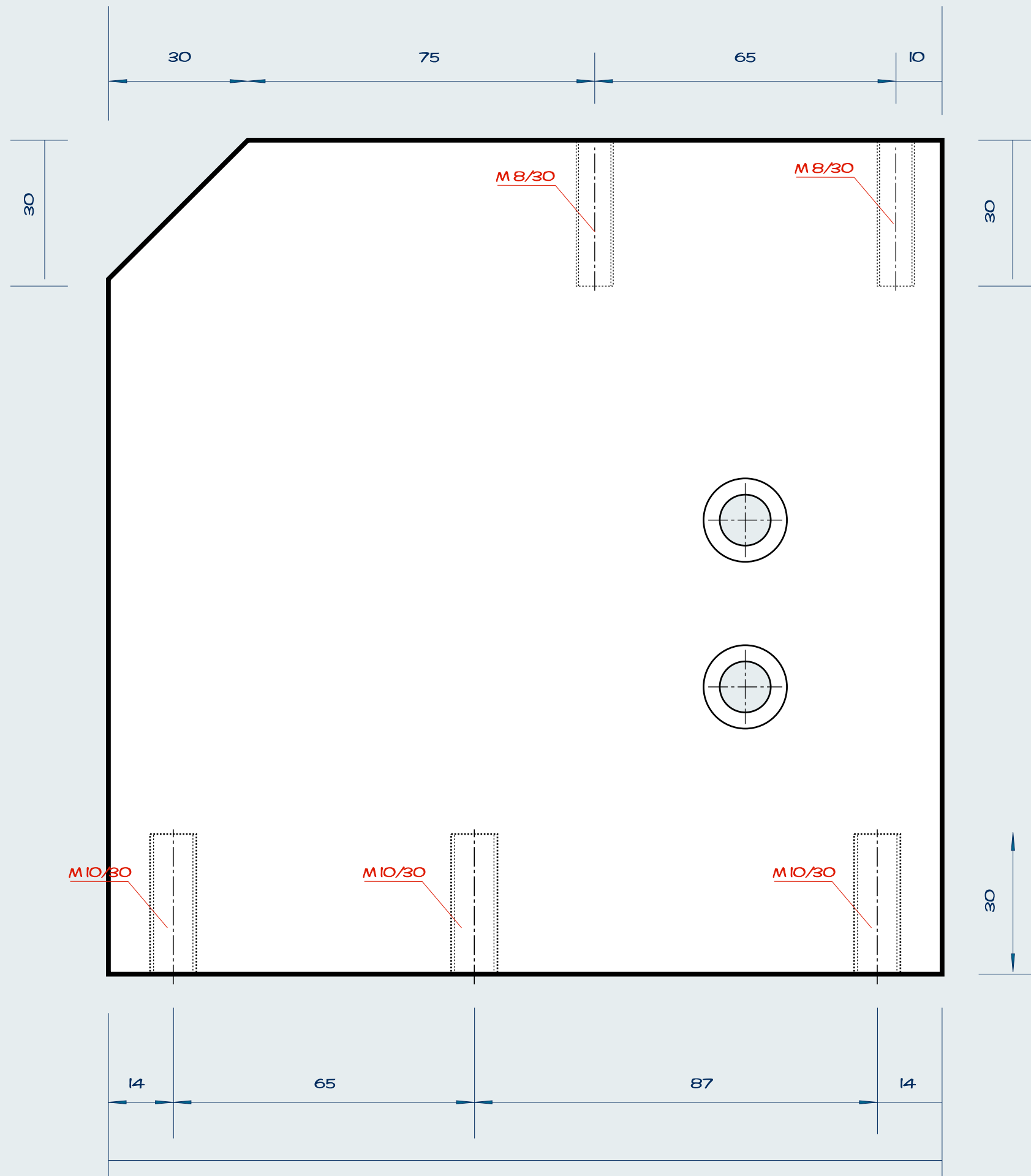
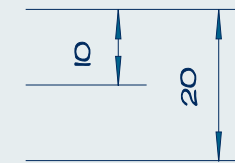

M 10/30



M 10/30

M 10/30

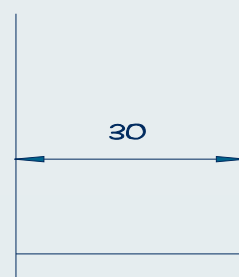
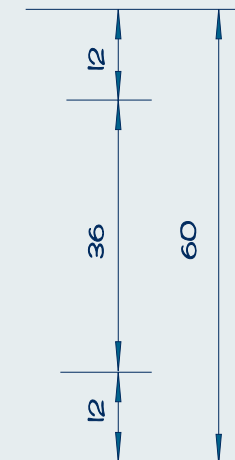

265

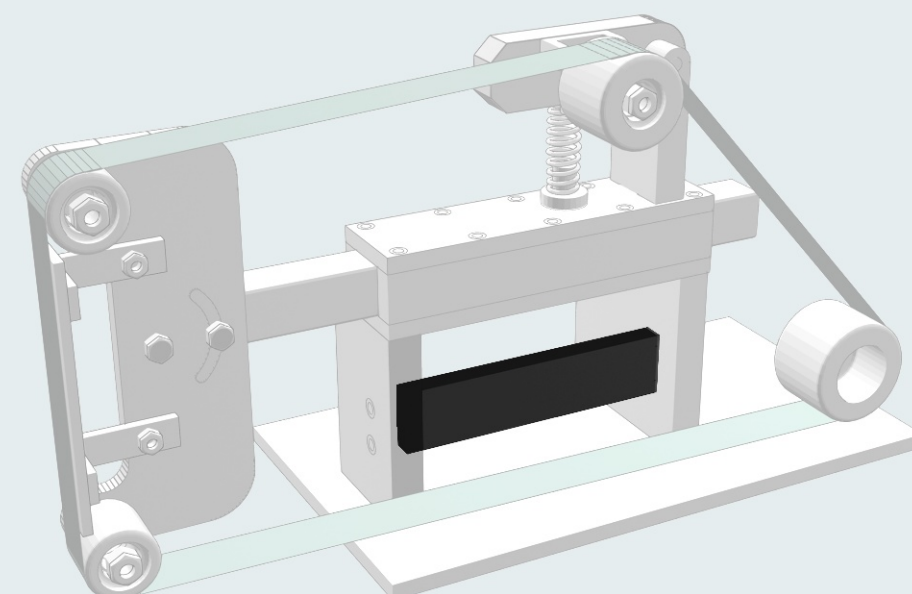

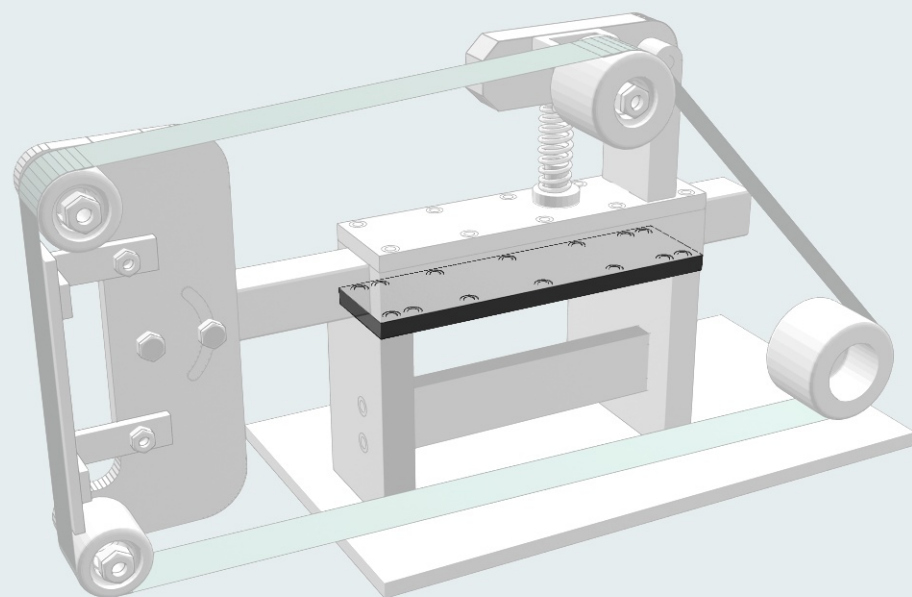
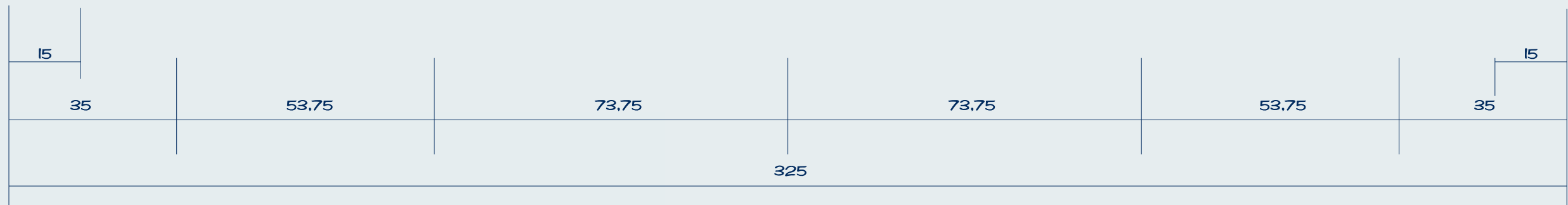
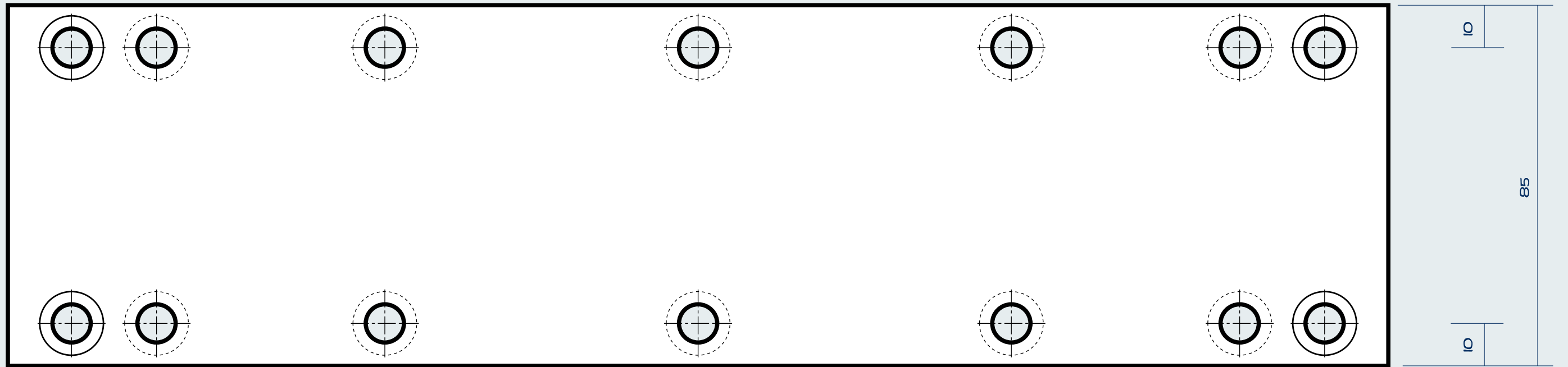
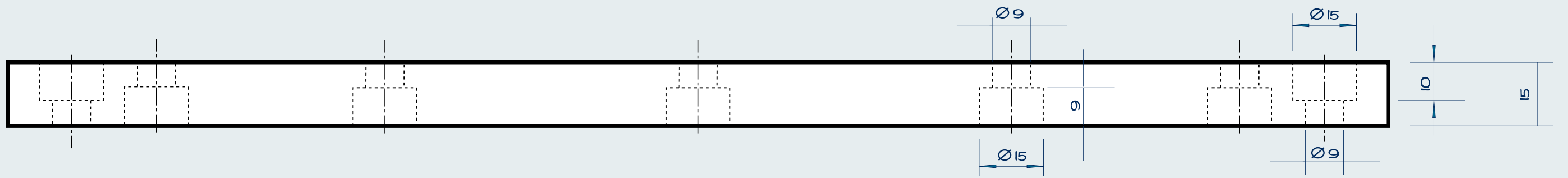

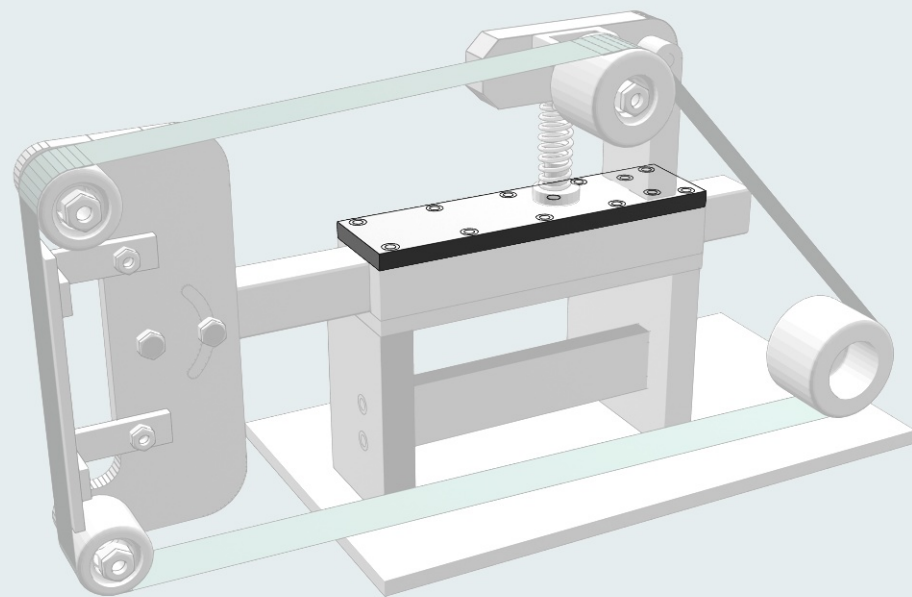
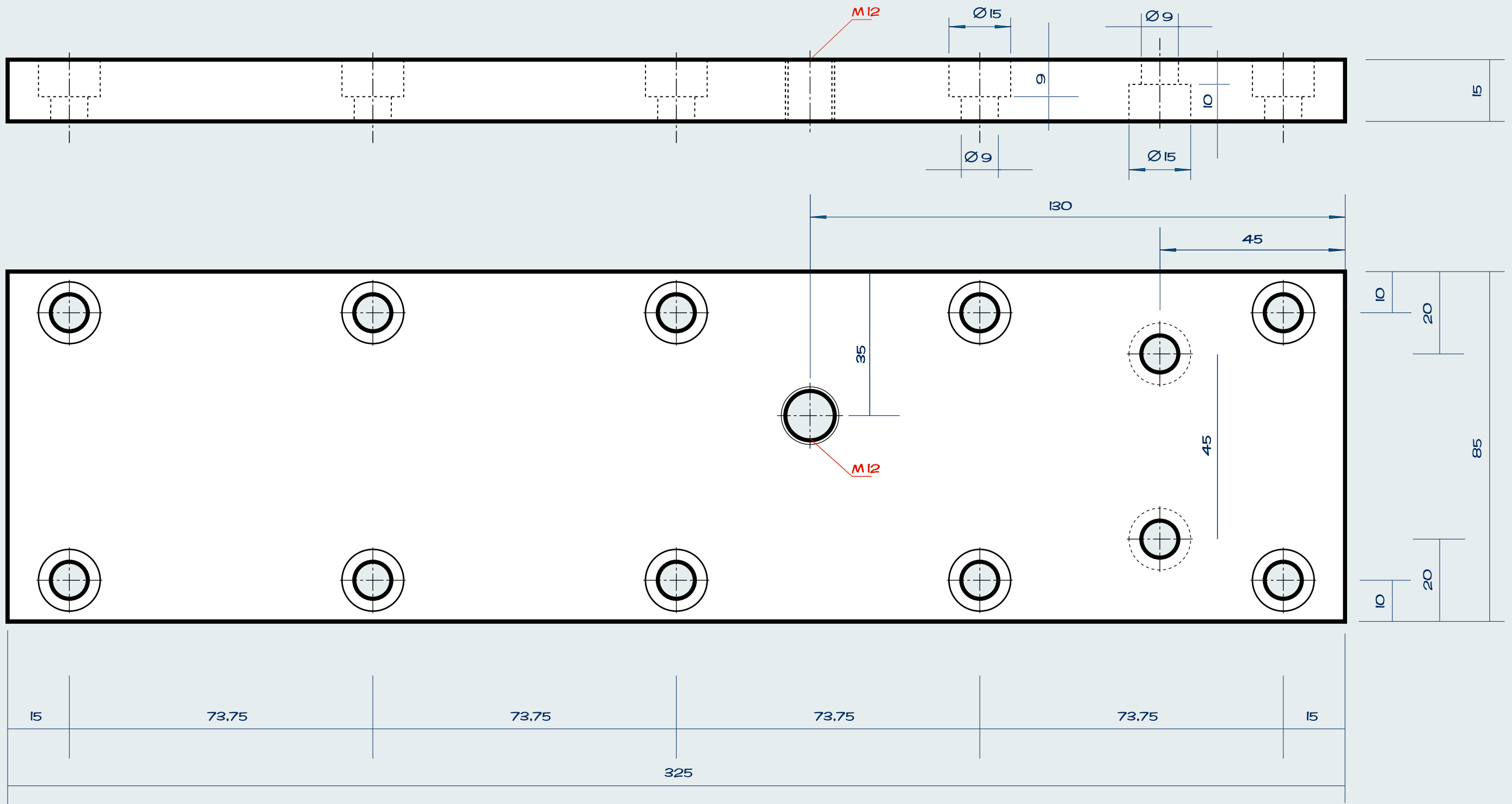

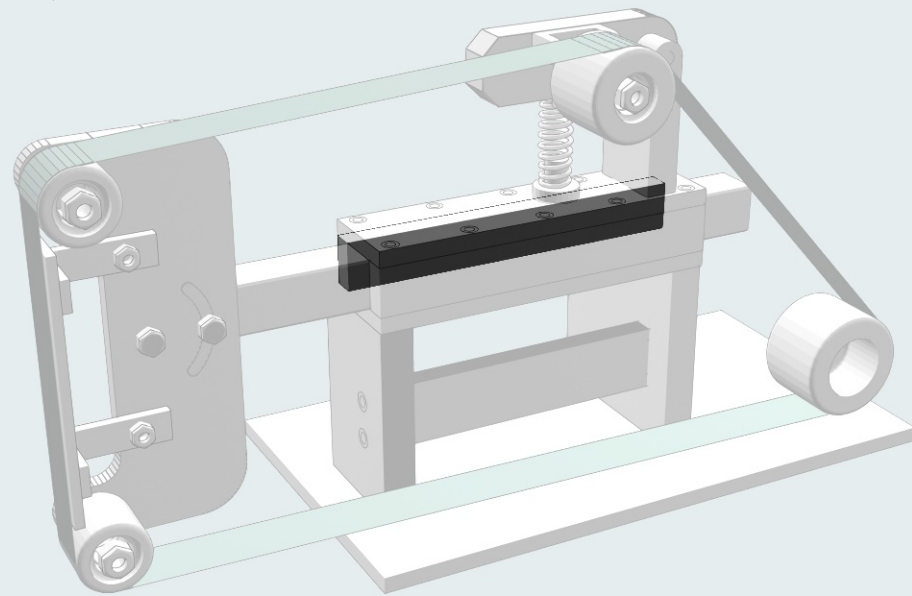
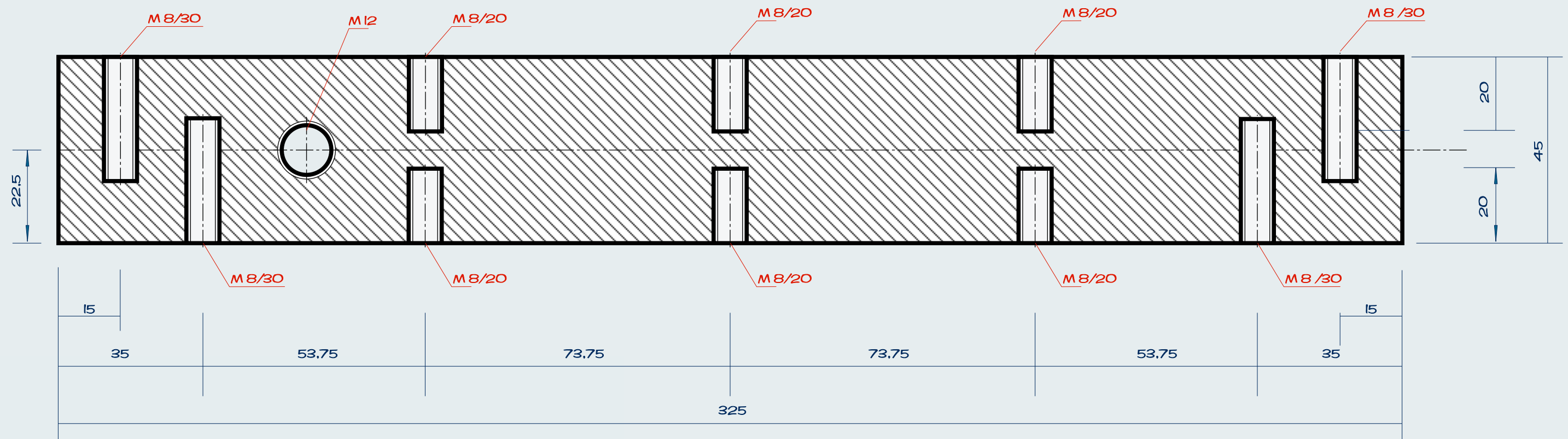
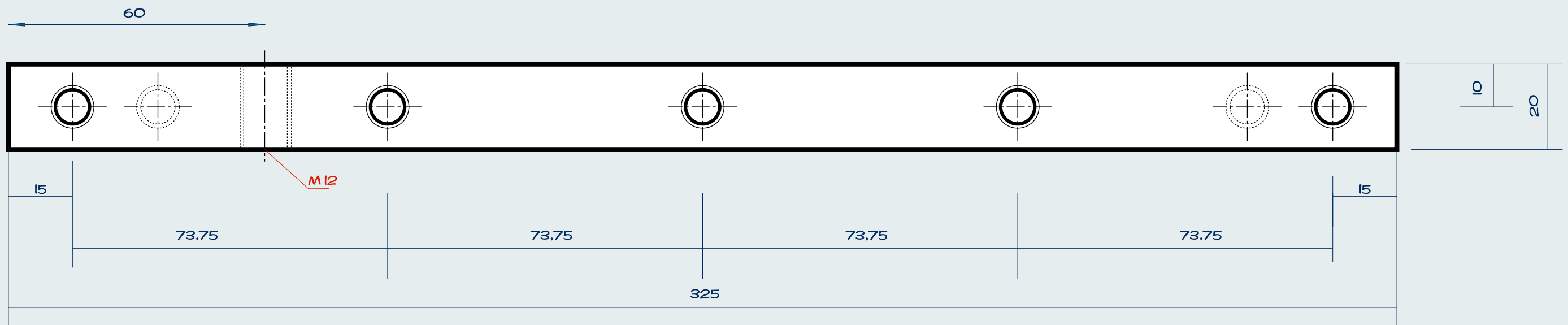

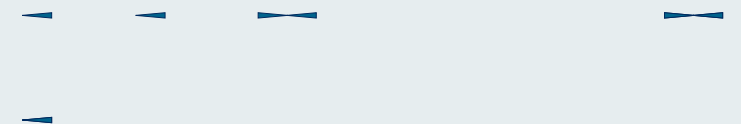
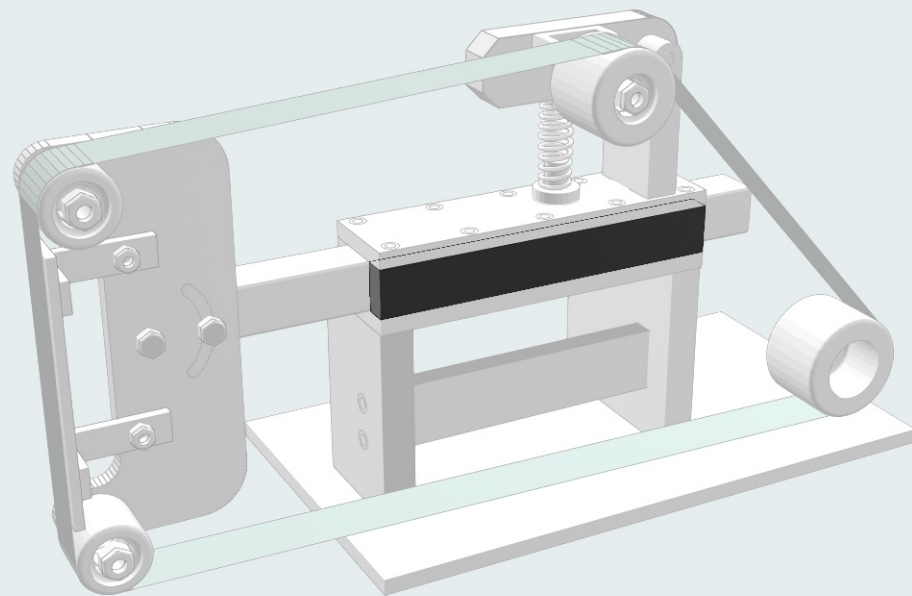
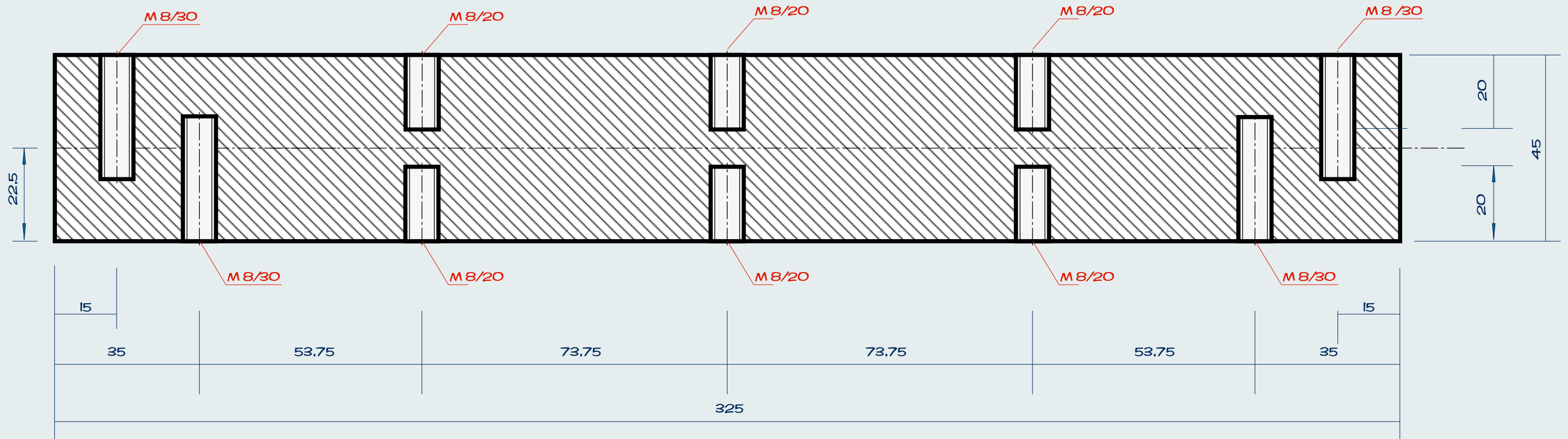
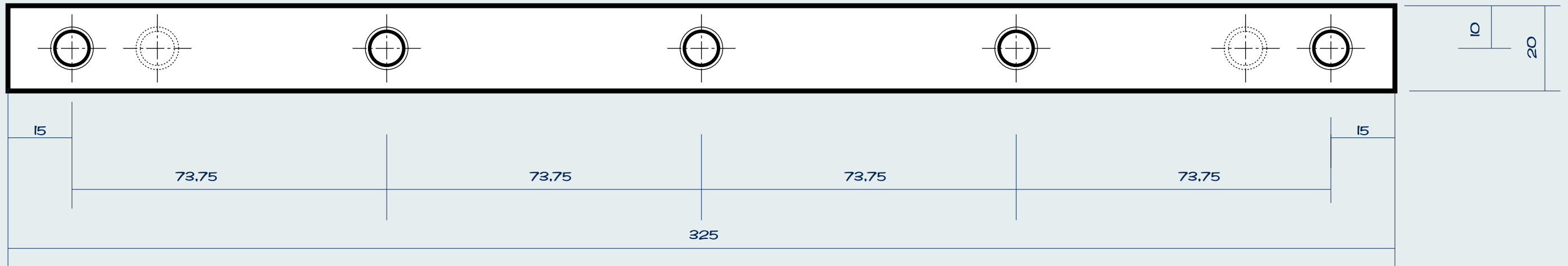

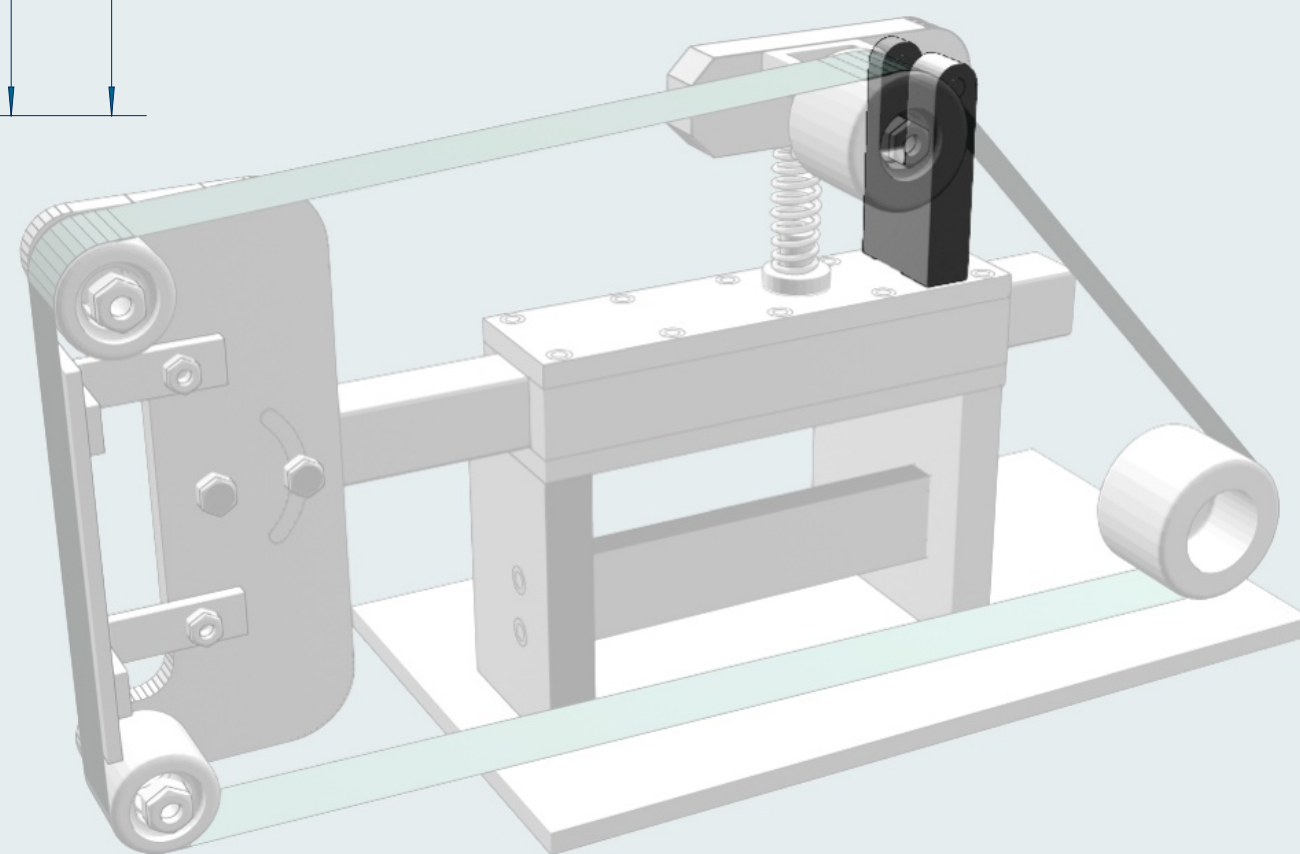
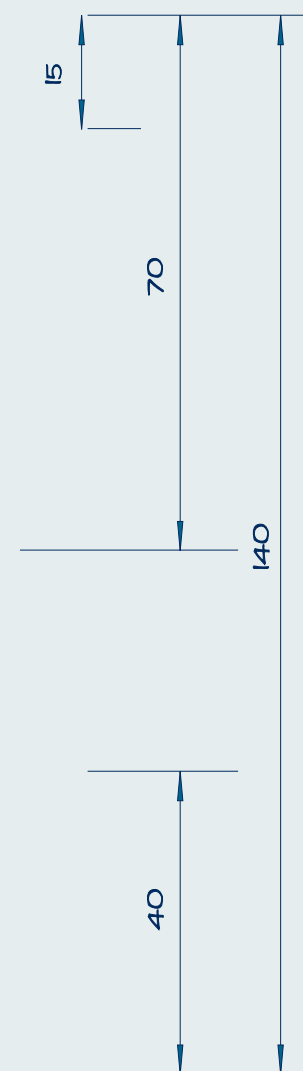
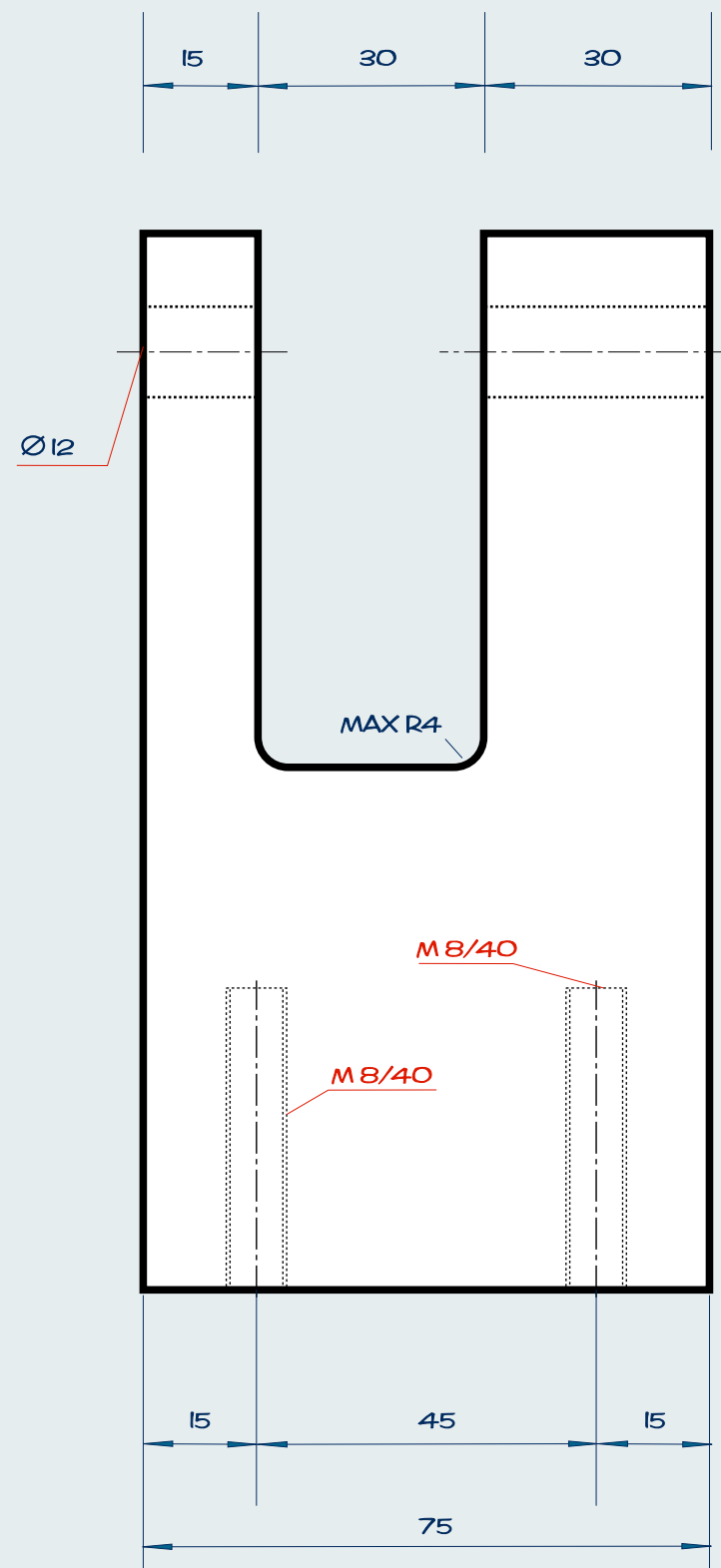
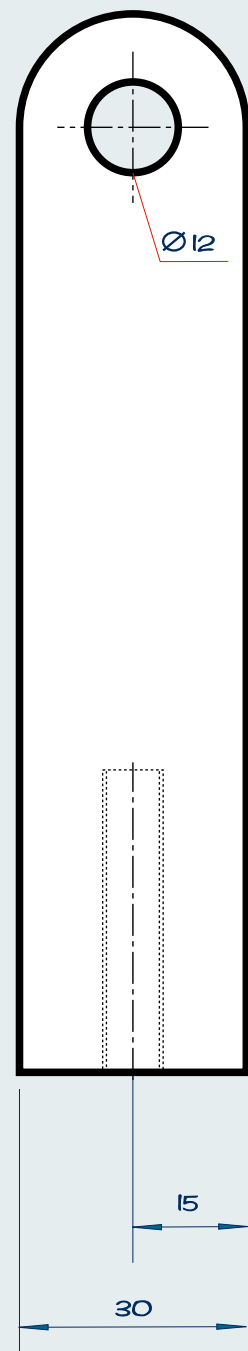

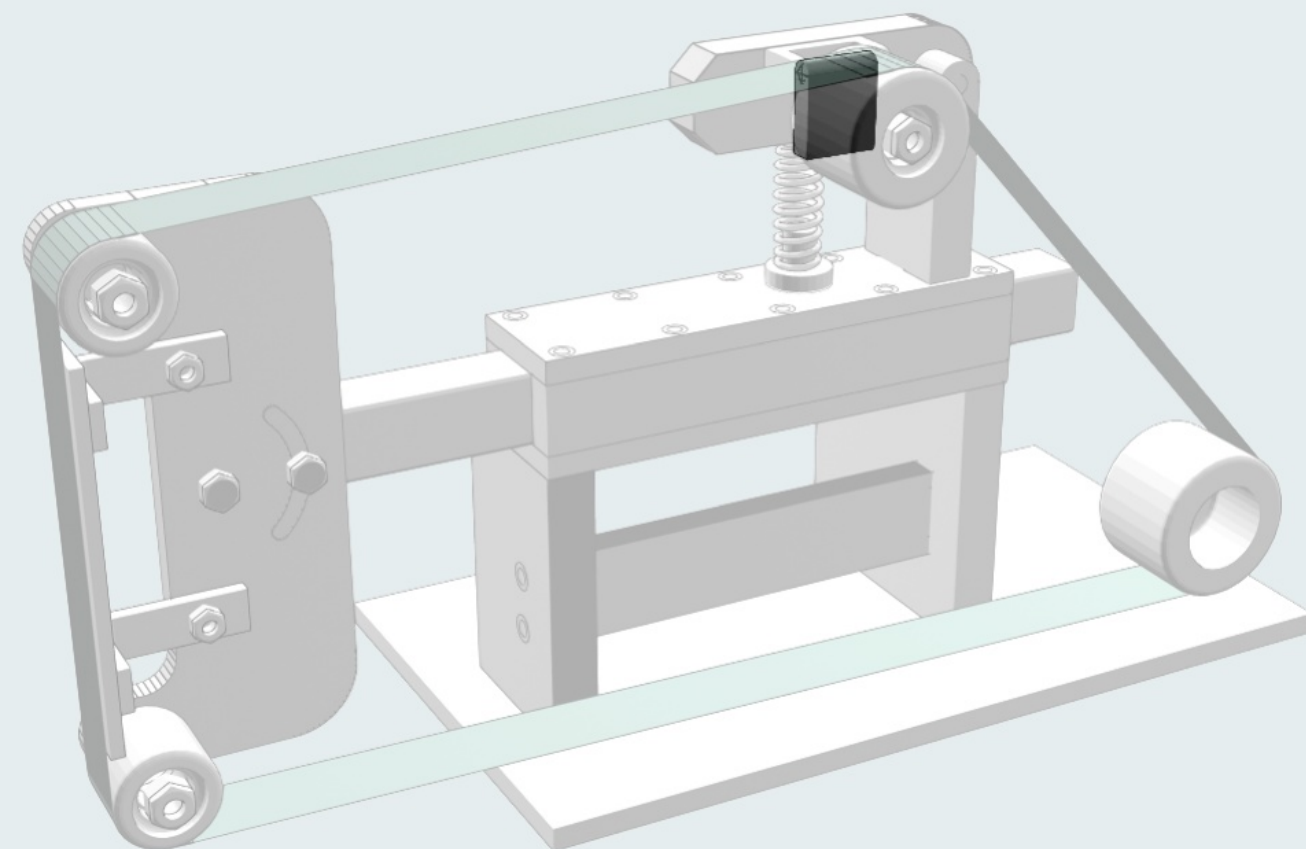
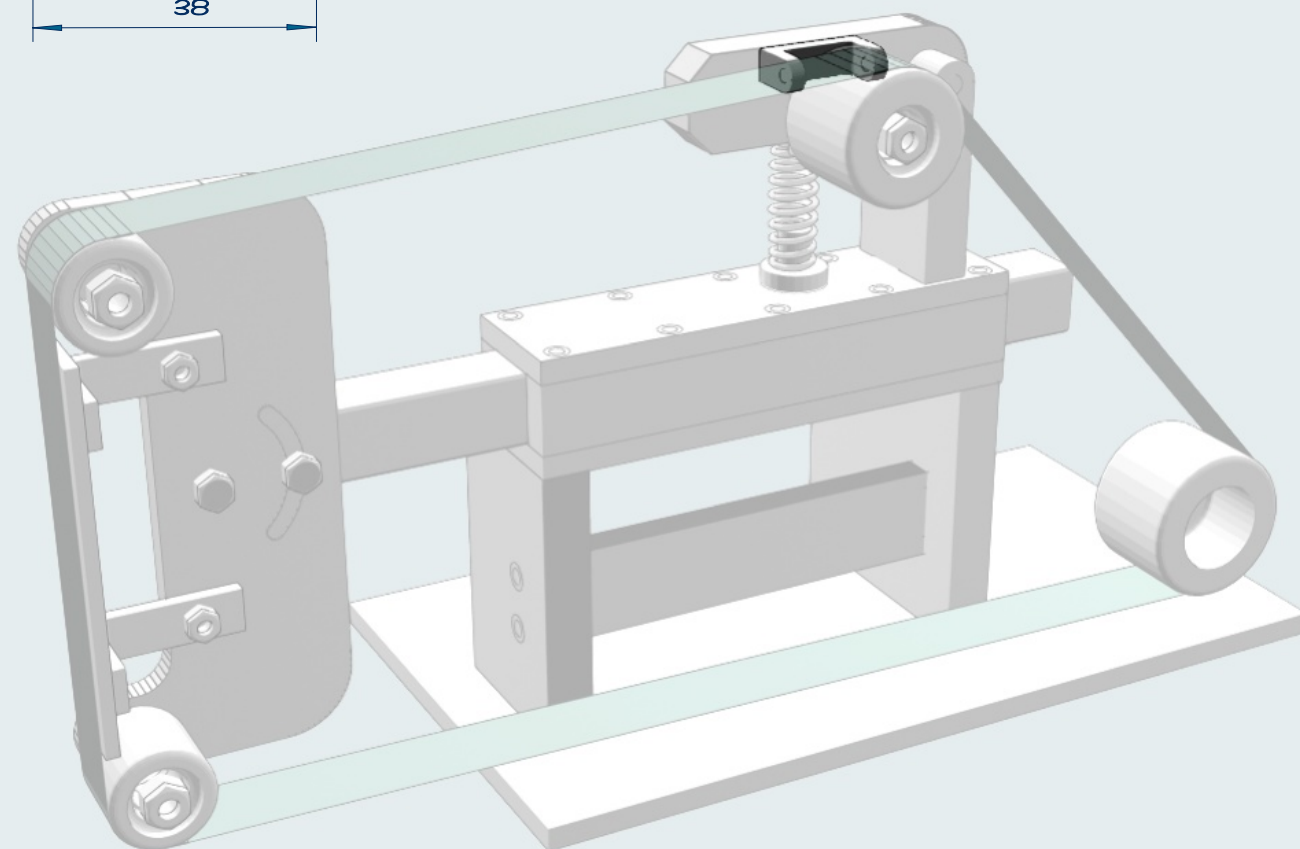
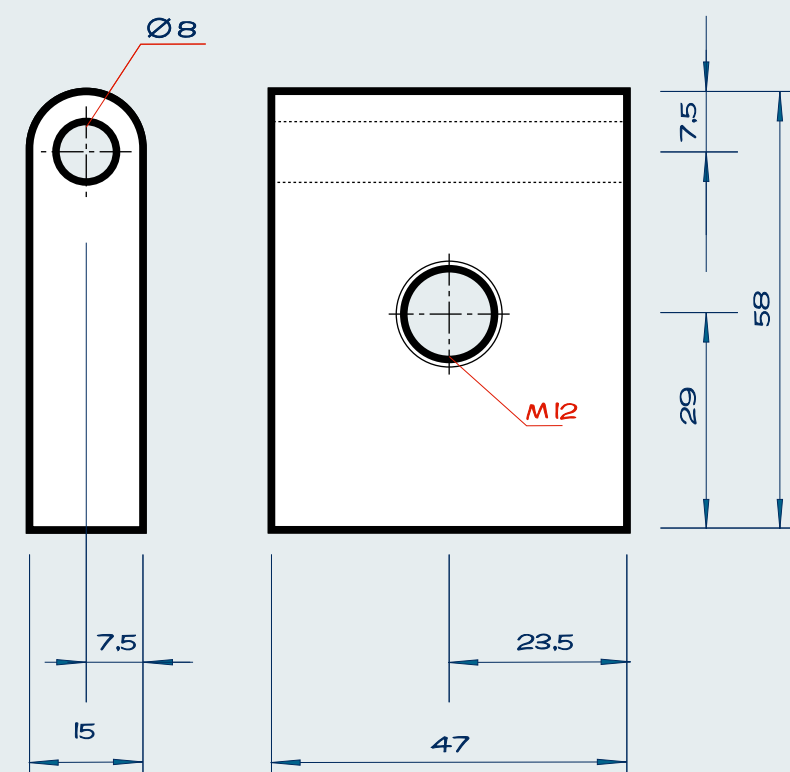
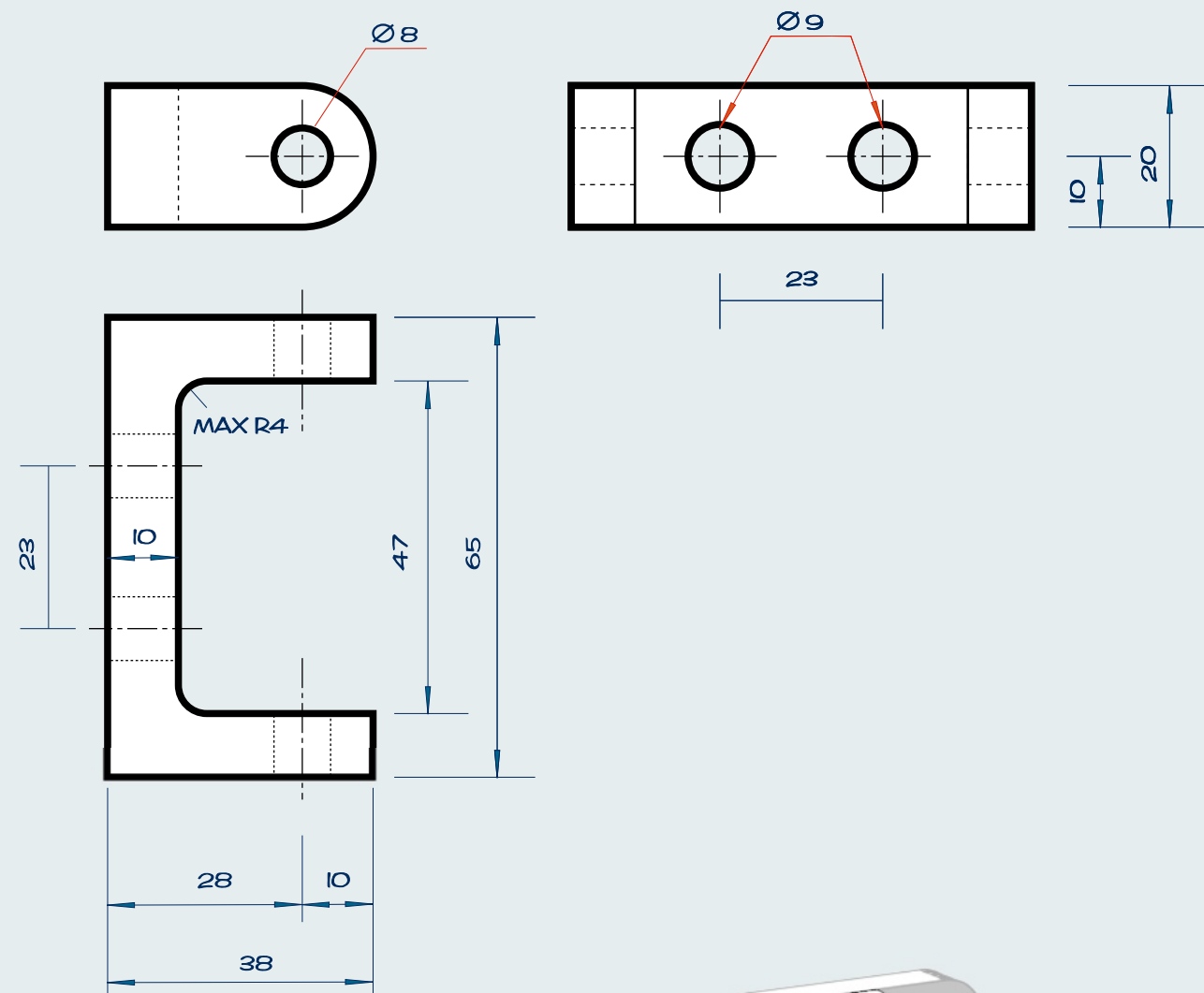

30

15

23

M 8/20

M 8/20

M 12/30

M 8 przelotowy

R 30

Ø 12

115

30

60

30

23

73.5

30

195

20

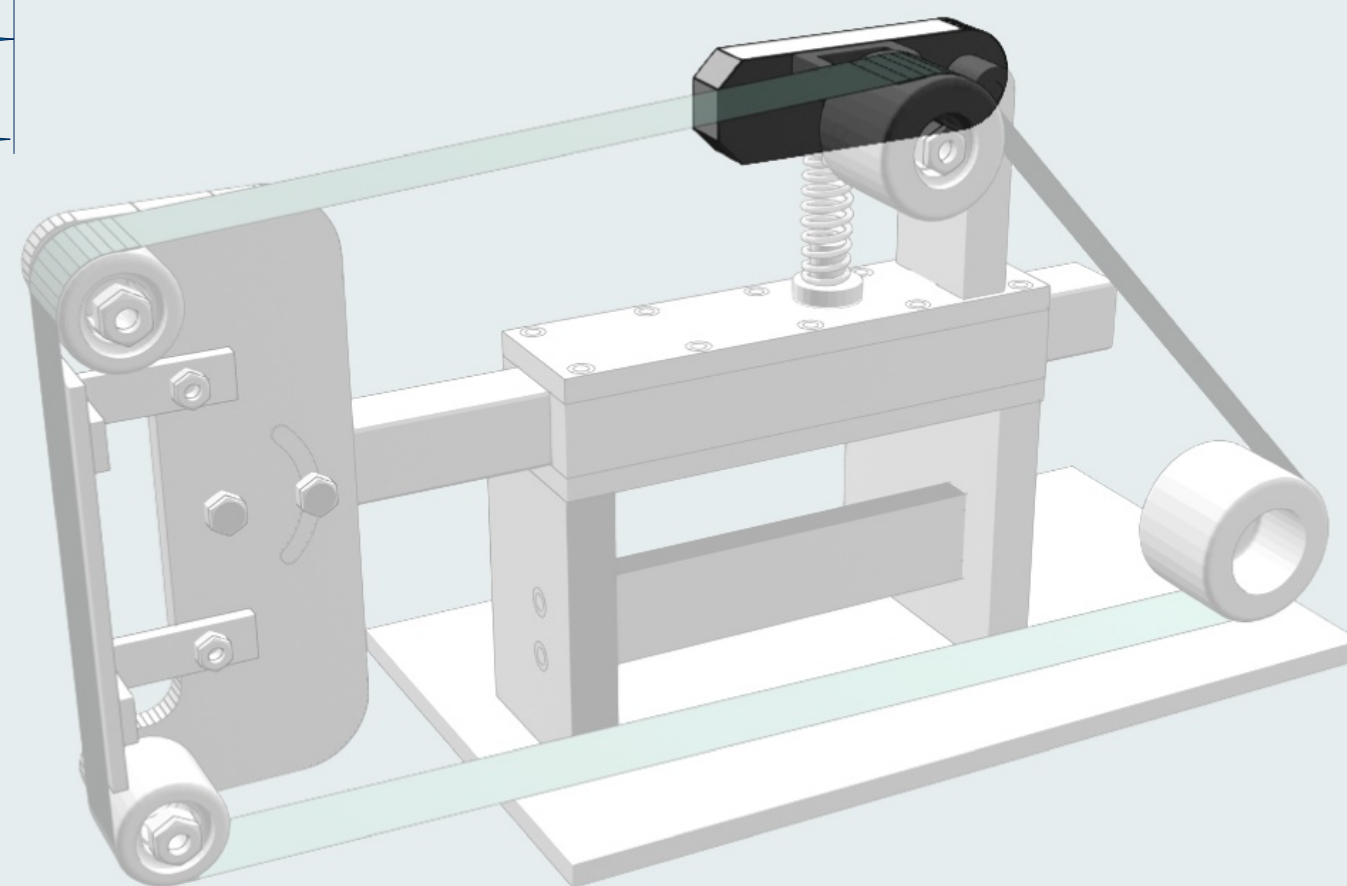

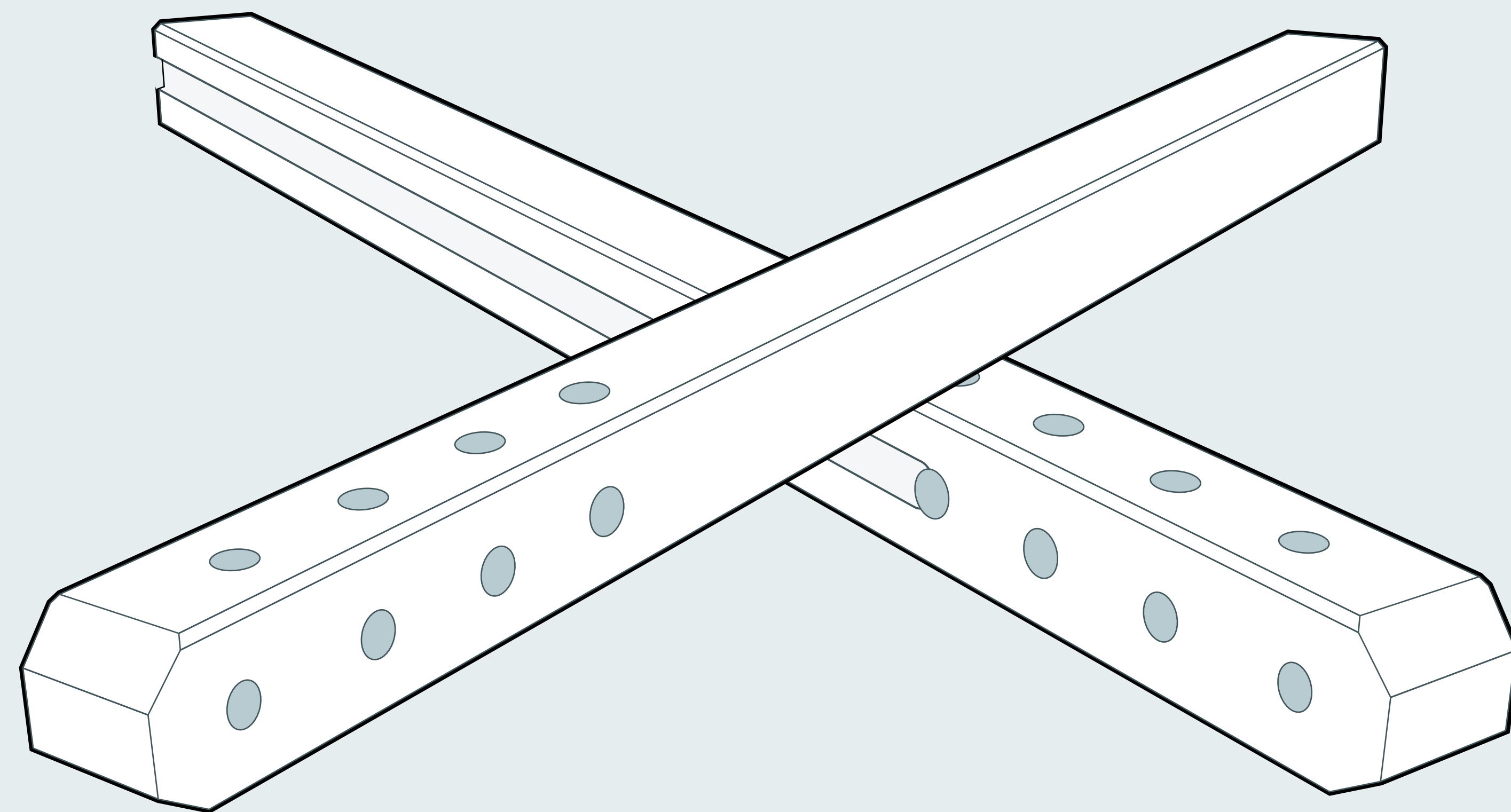
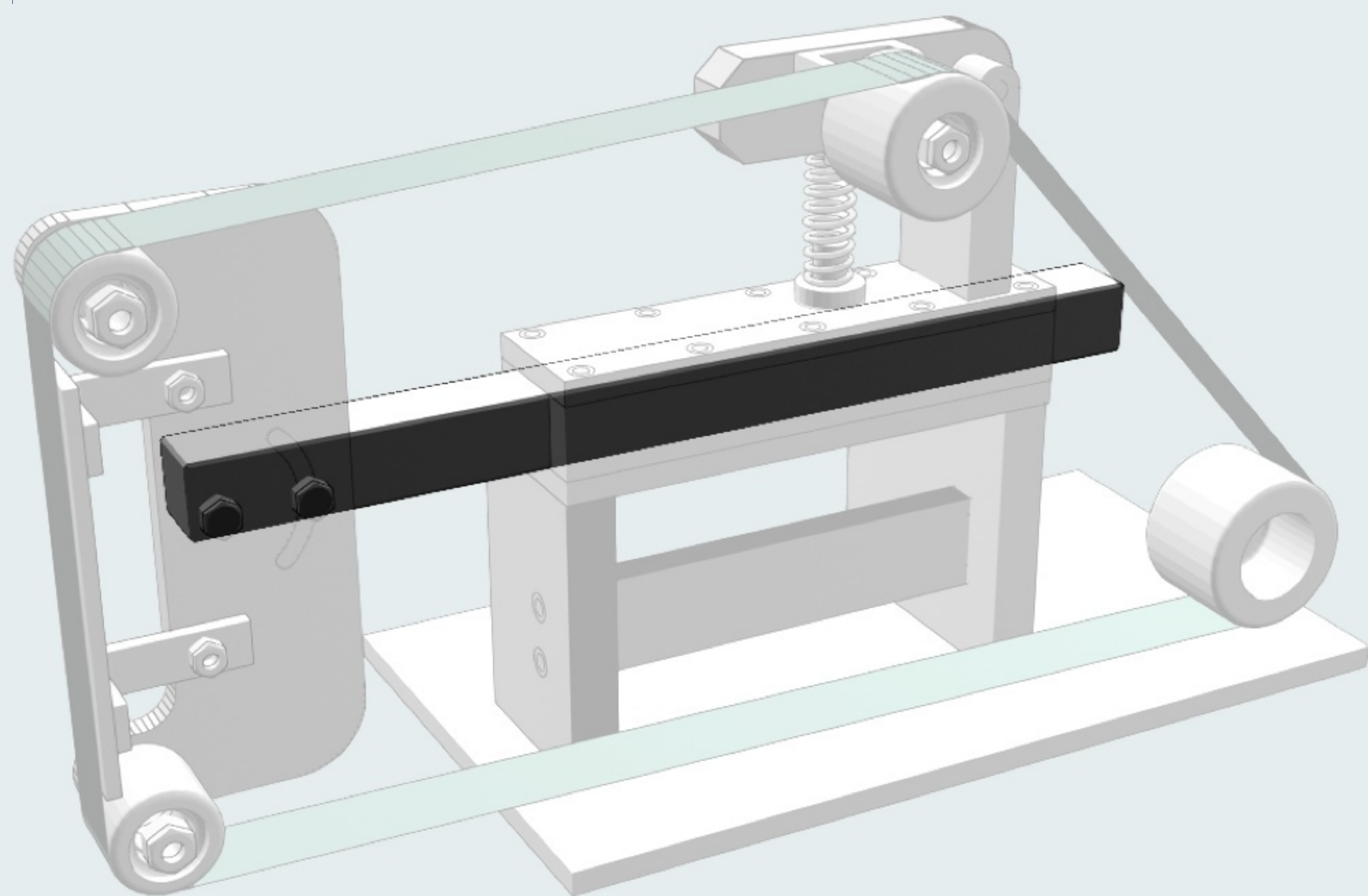

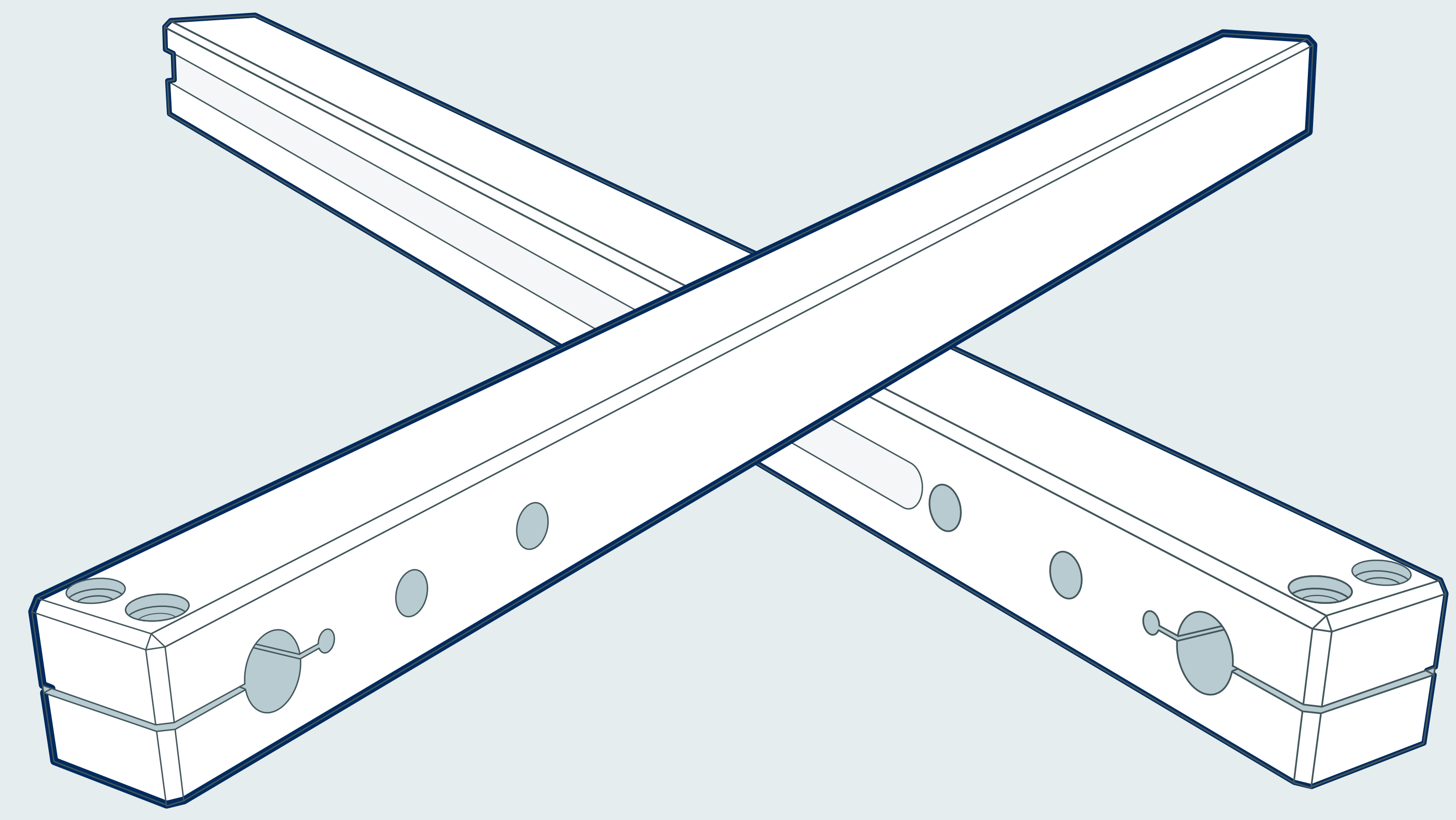
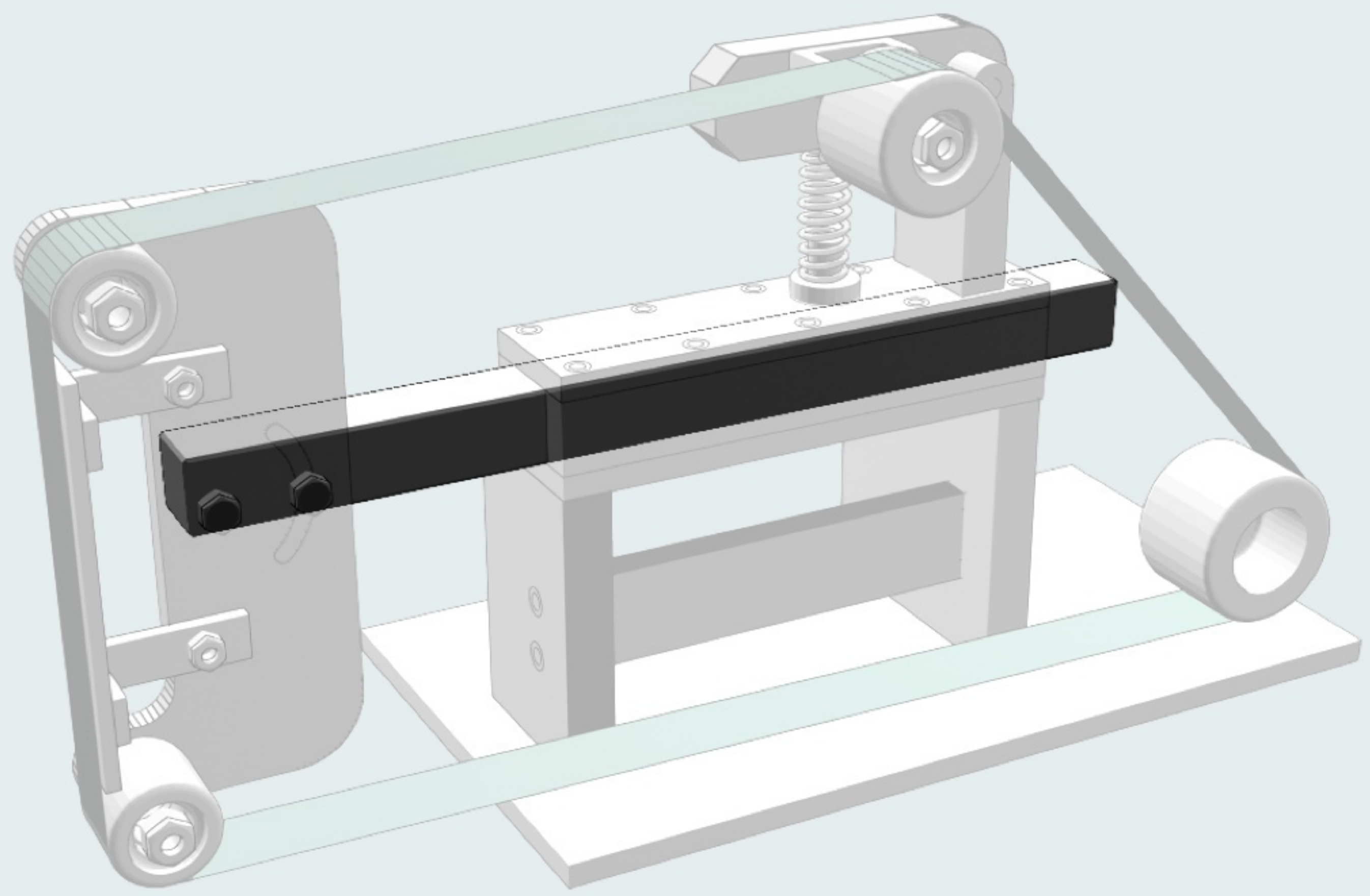
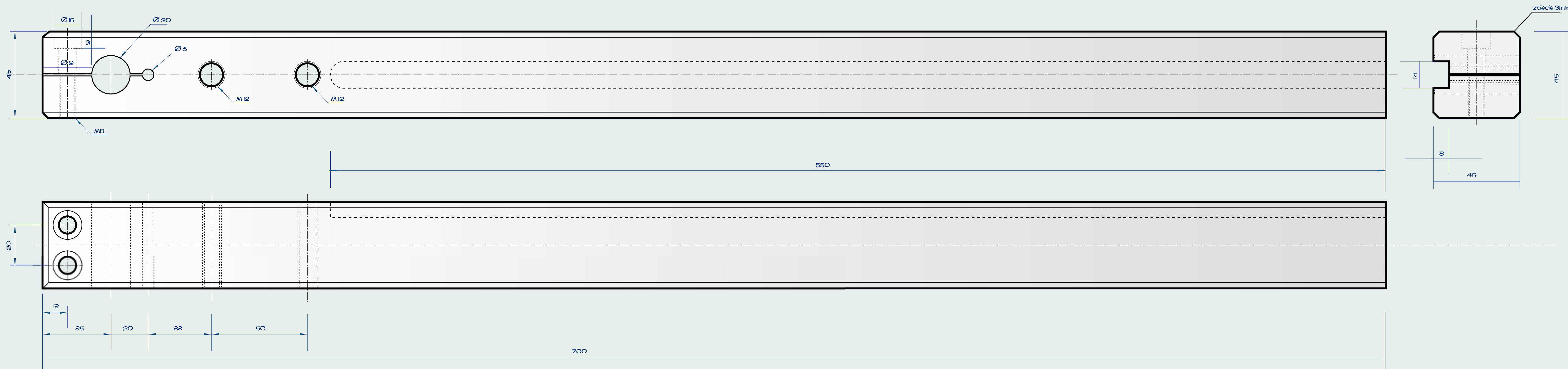

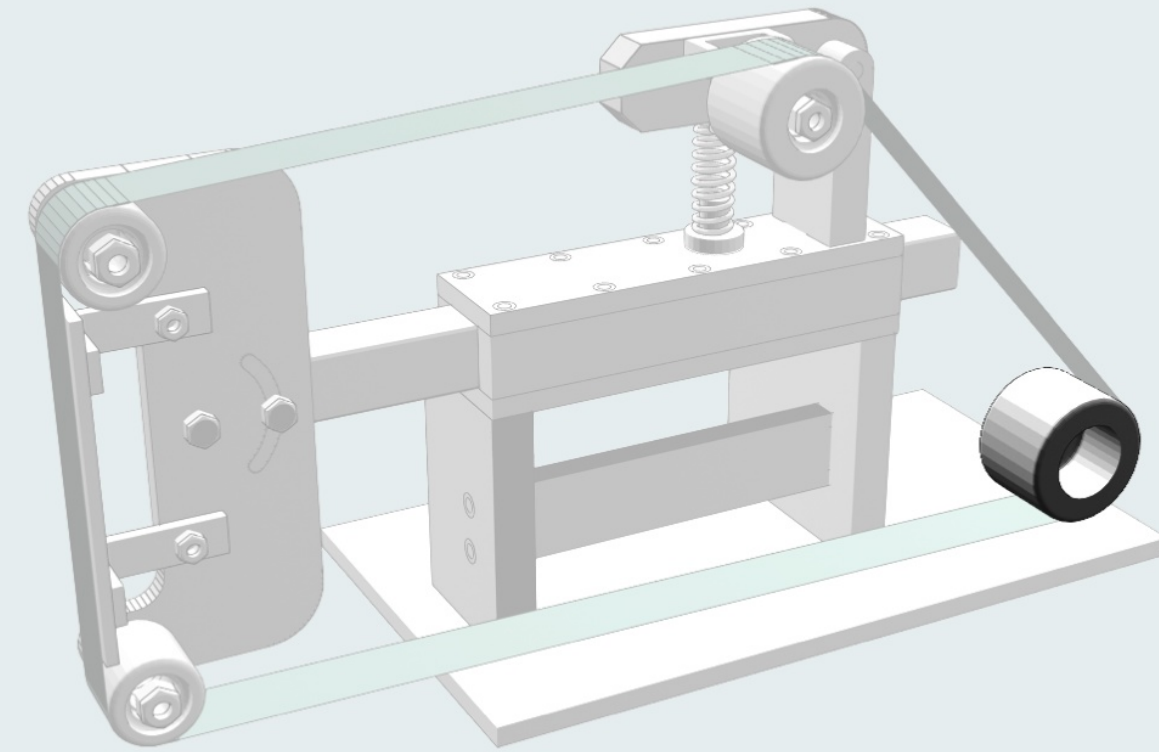
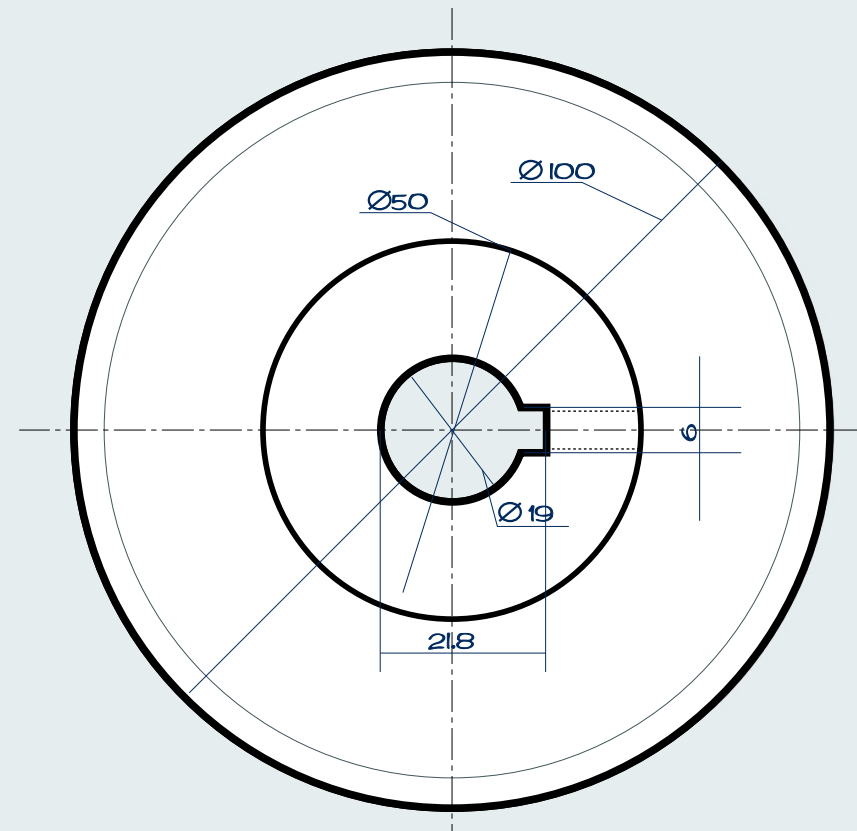
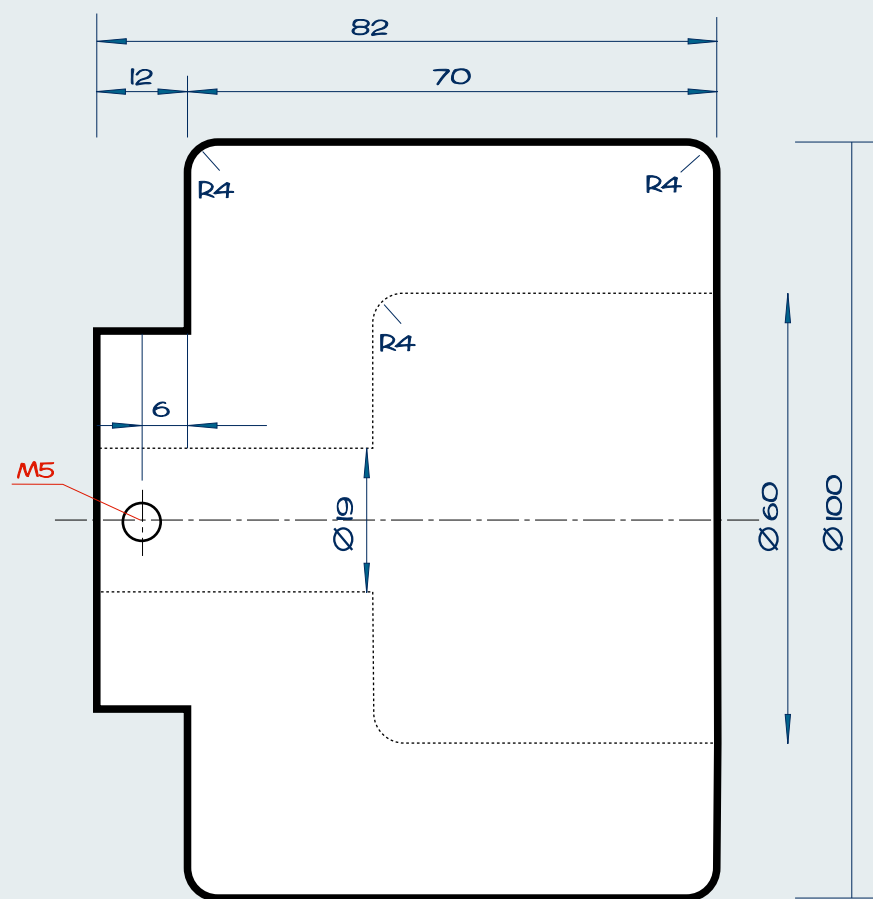

PRZEKRÓJ A-A

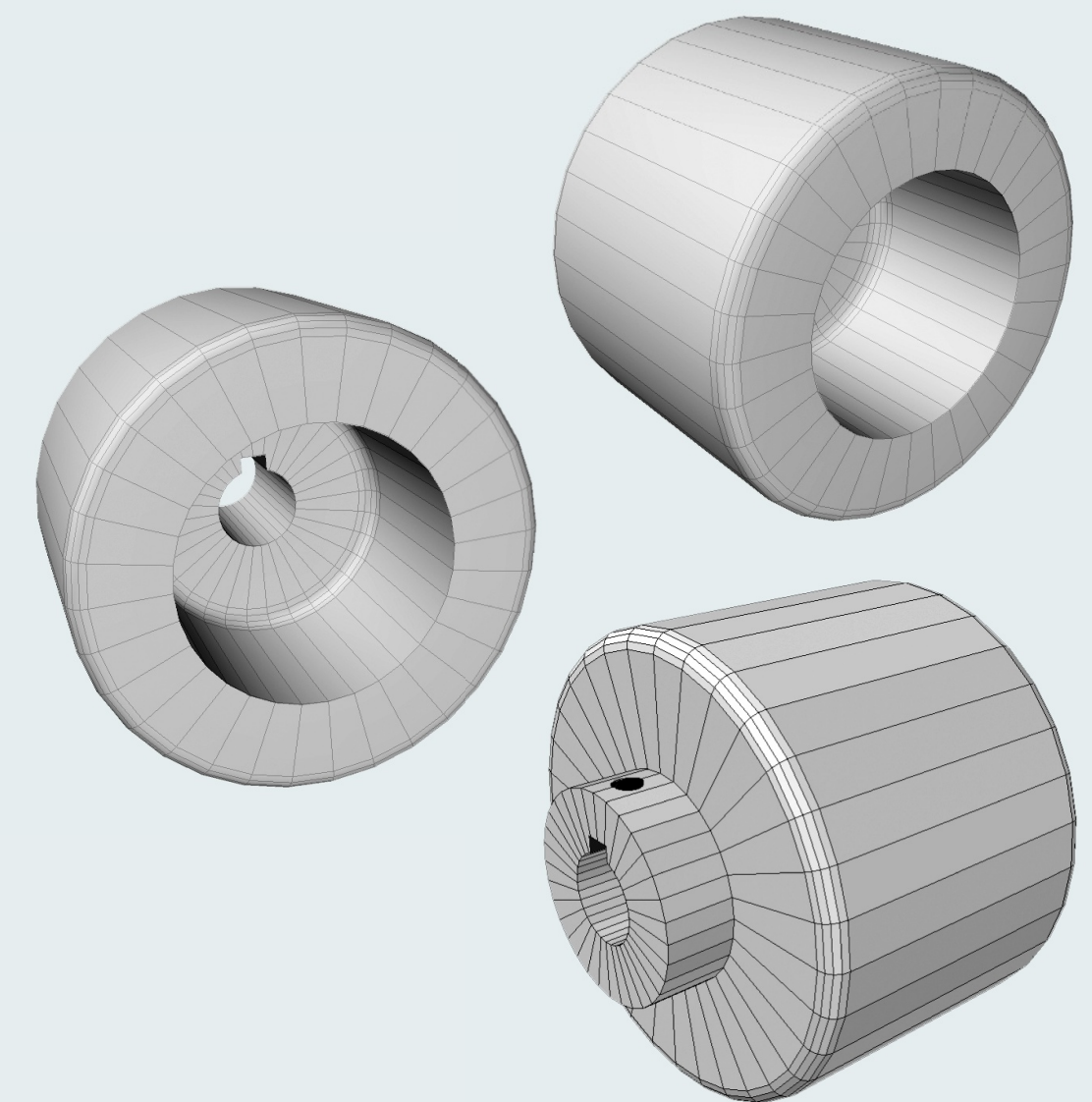
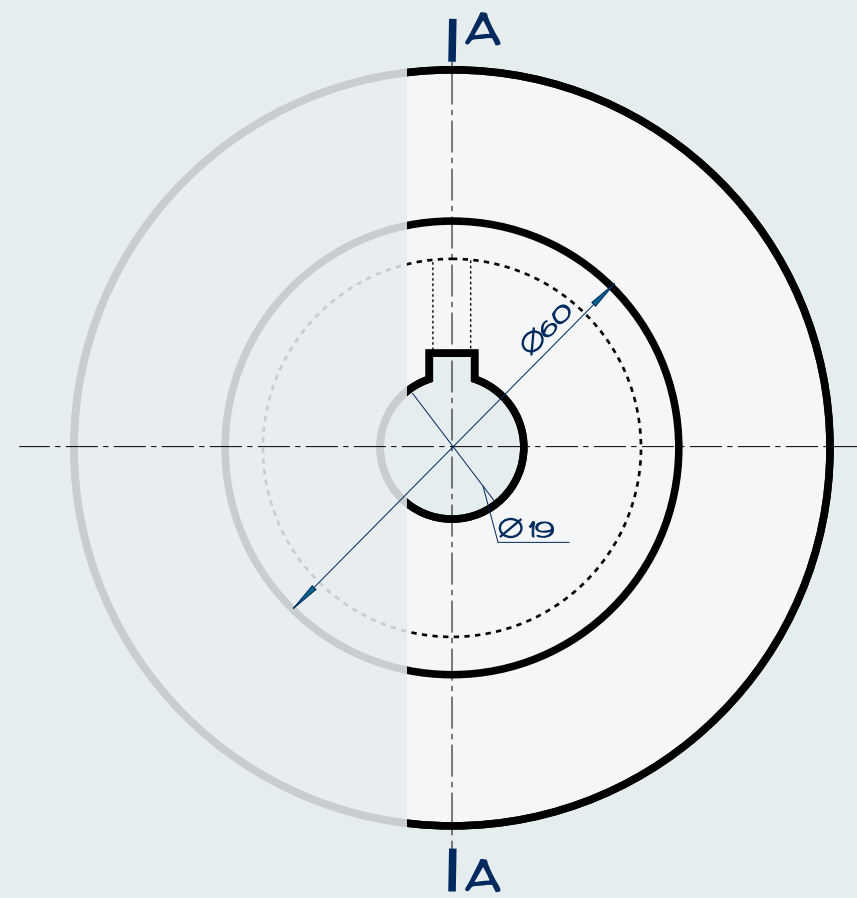
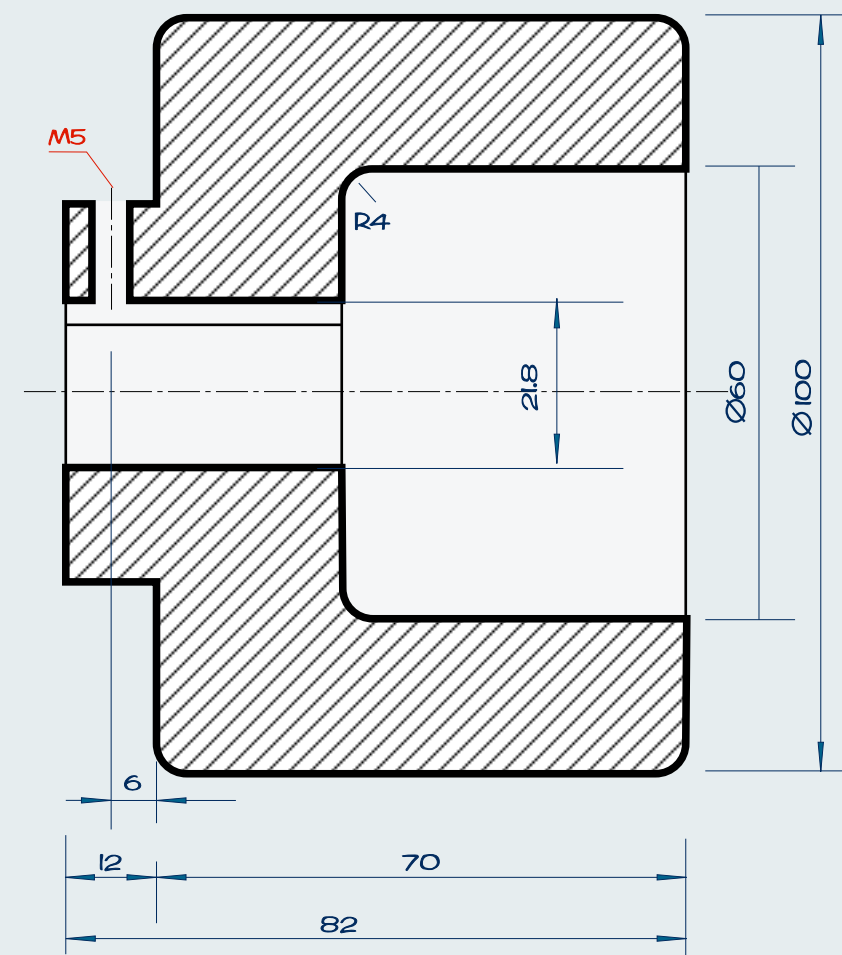

WIDOK PERSPEKTYWICZNY

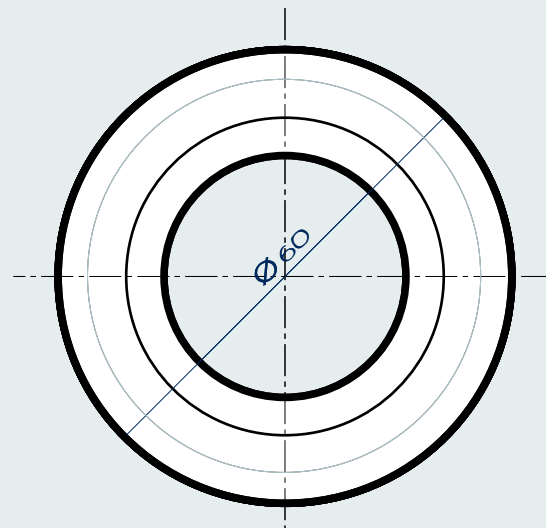
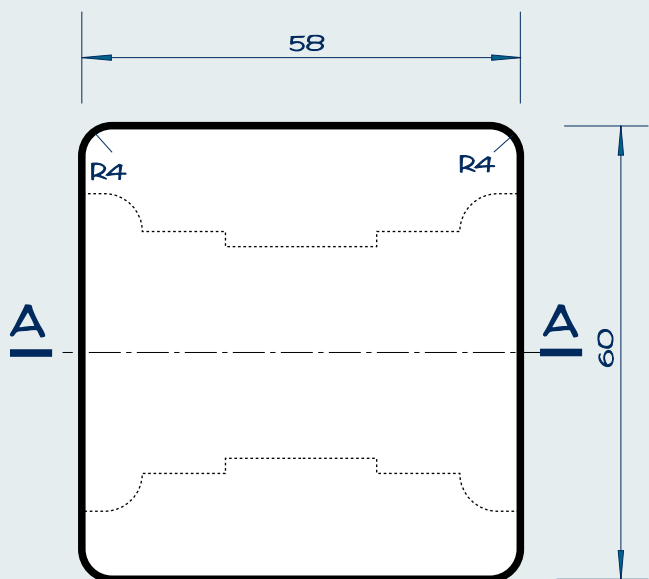

PRZĘKRÓJ A-A

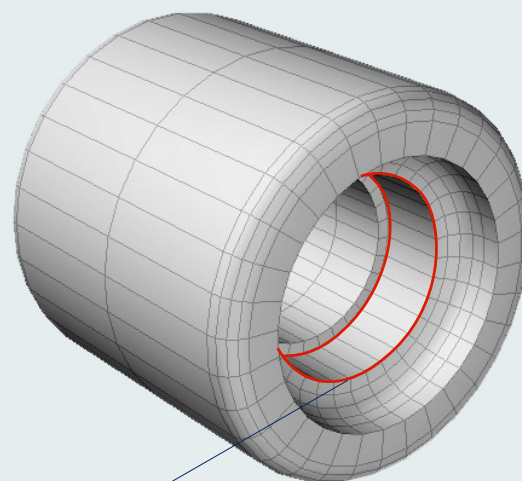
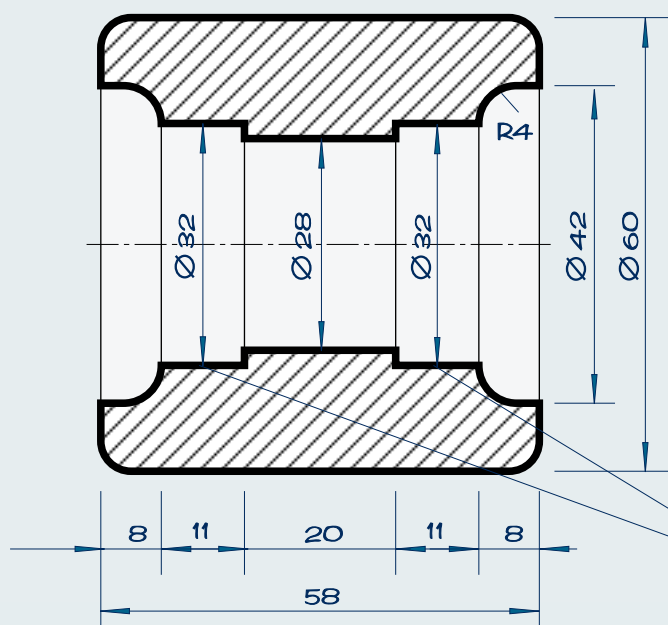

WIDOK PERSPEKTYWICZNY

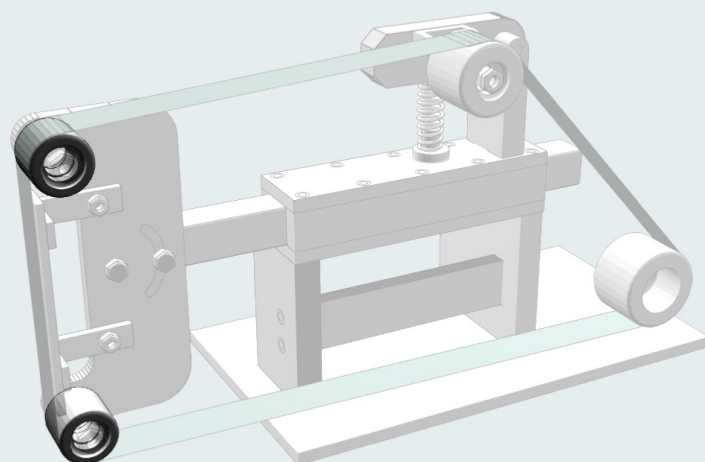

PARA ŁOŻYSK 6201 2RS
DOBRAĆ ODPOWIEDNIE TOLERANCJE
DLA OTWORÓW

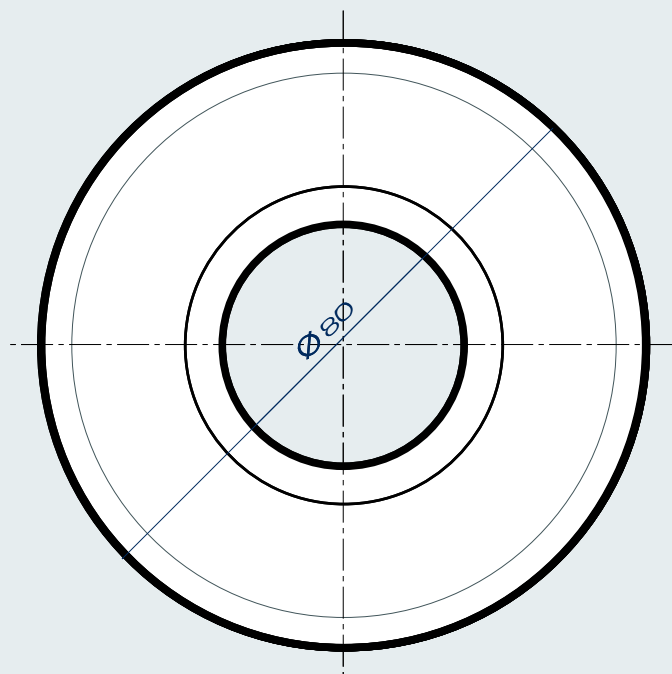
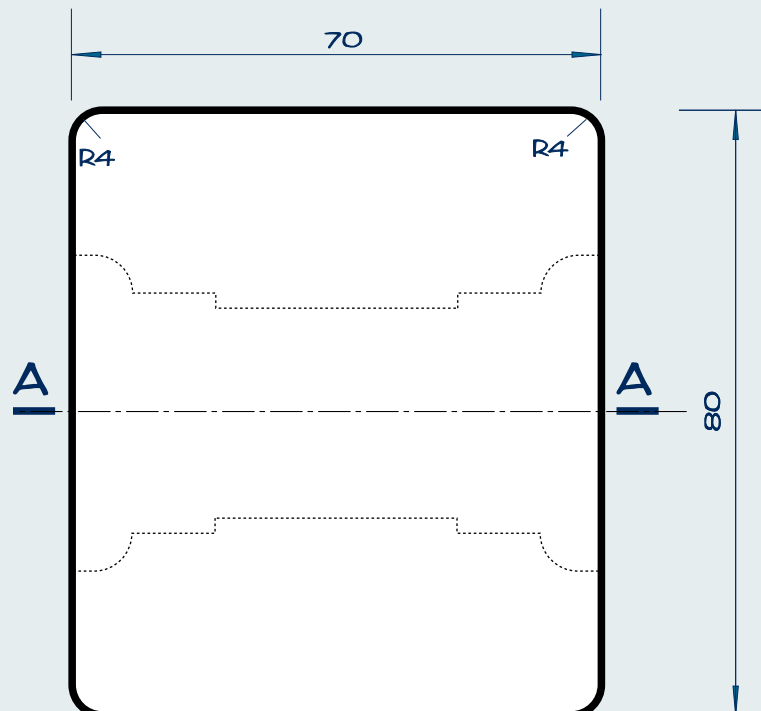

PRZEKRÓJ A-A

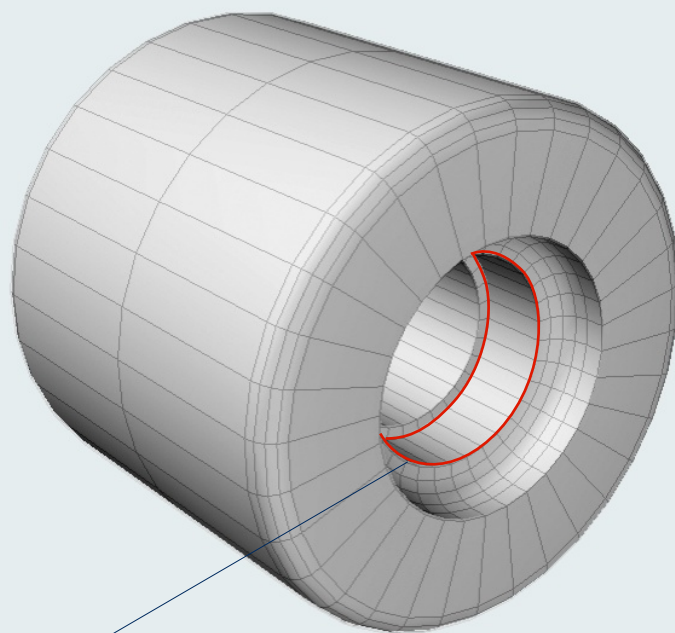
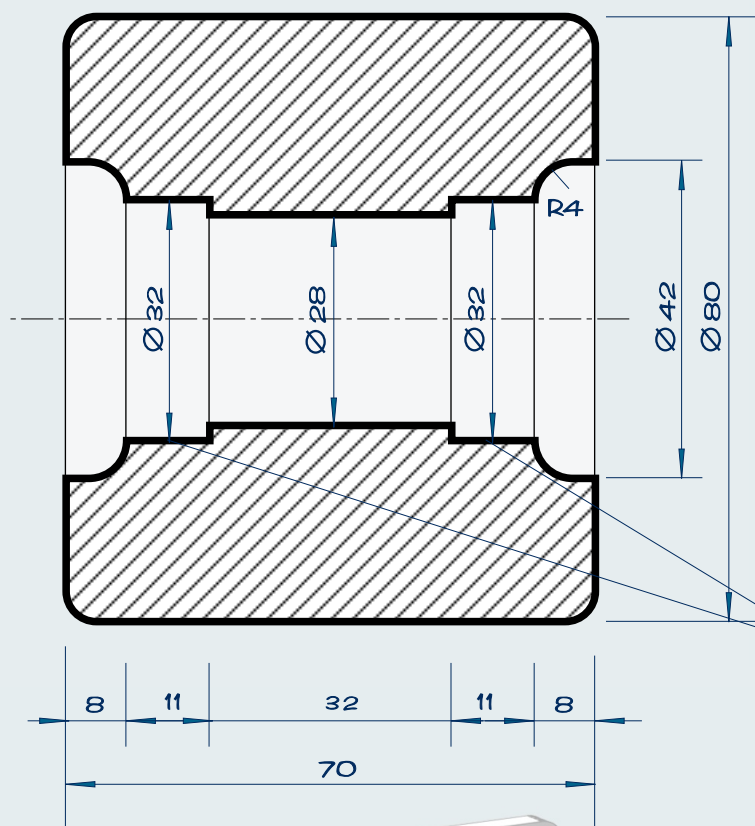

WIDOK PERSPEKTYWICZNY

PARA ŁOŻYSK 6201 2RS
DOBRAĆ ODPOWIEDNIE TOLERANCJE
DLA OTWORÓW

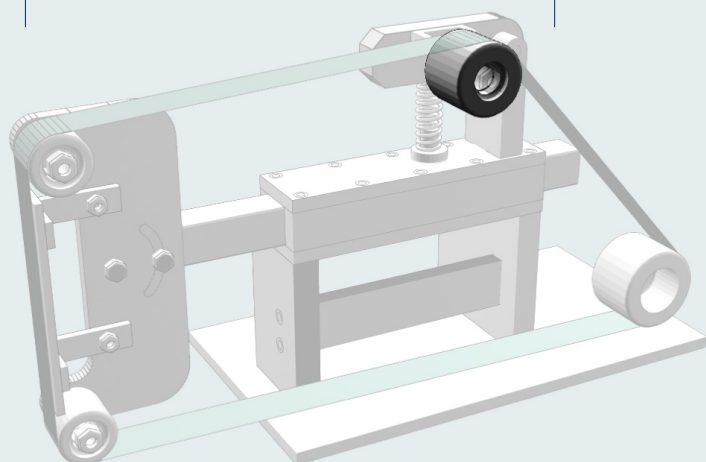

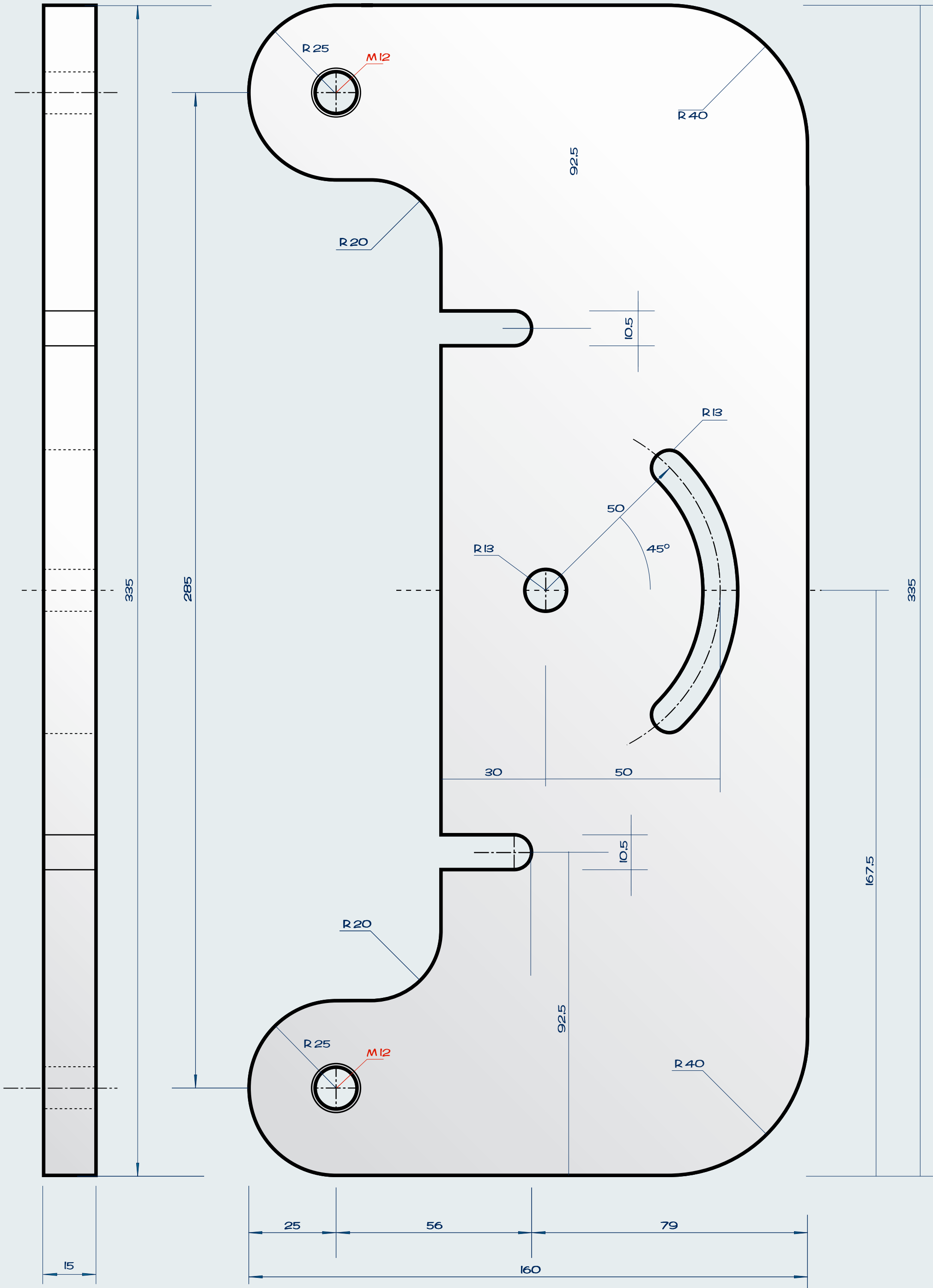

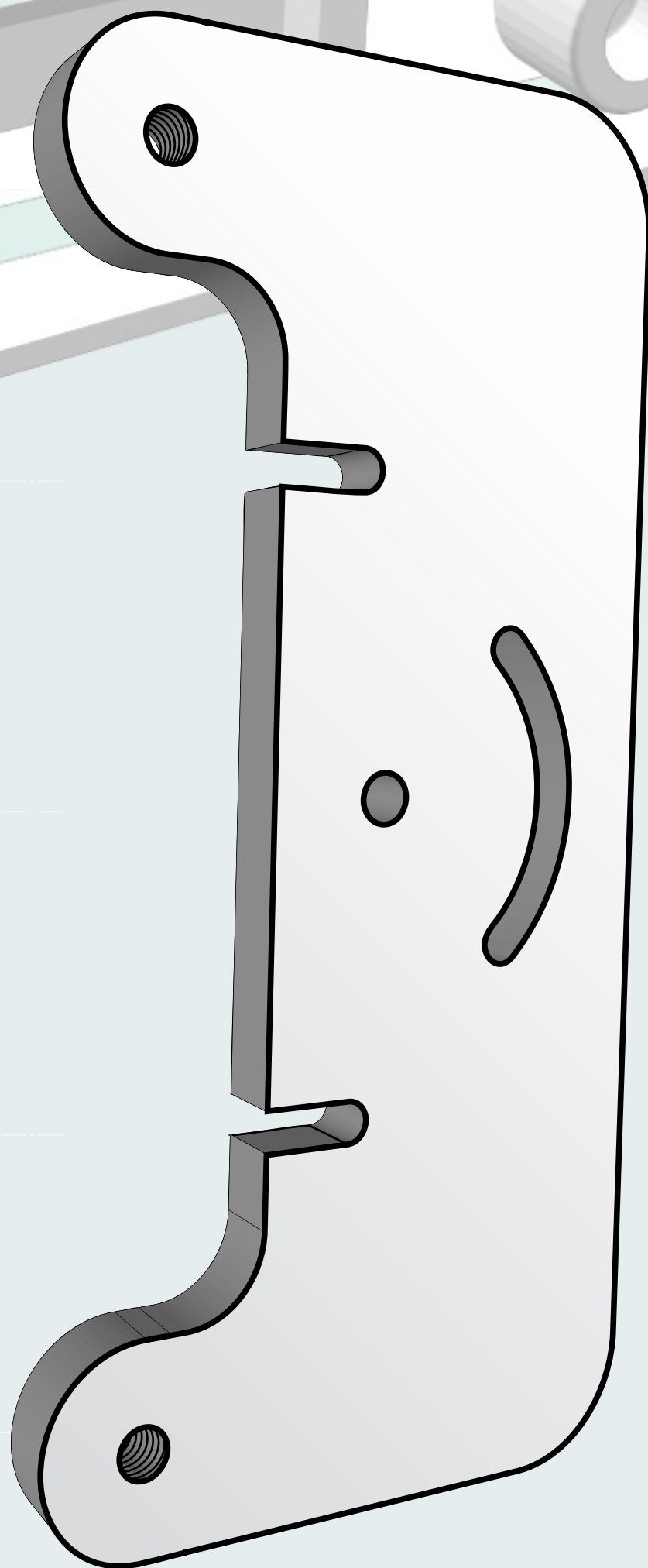
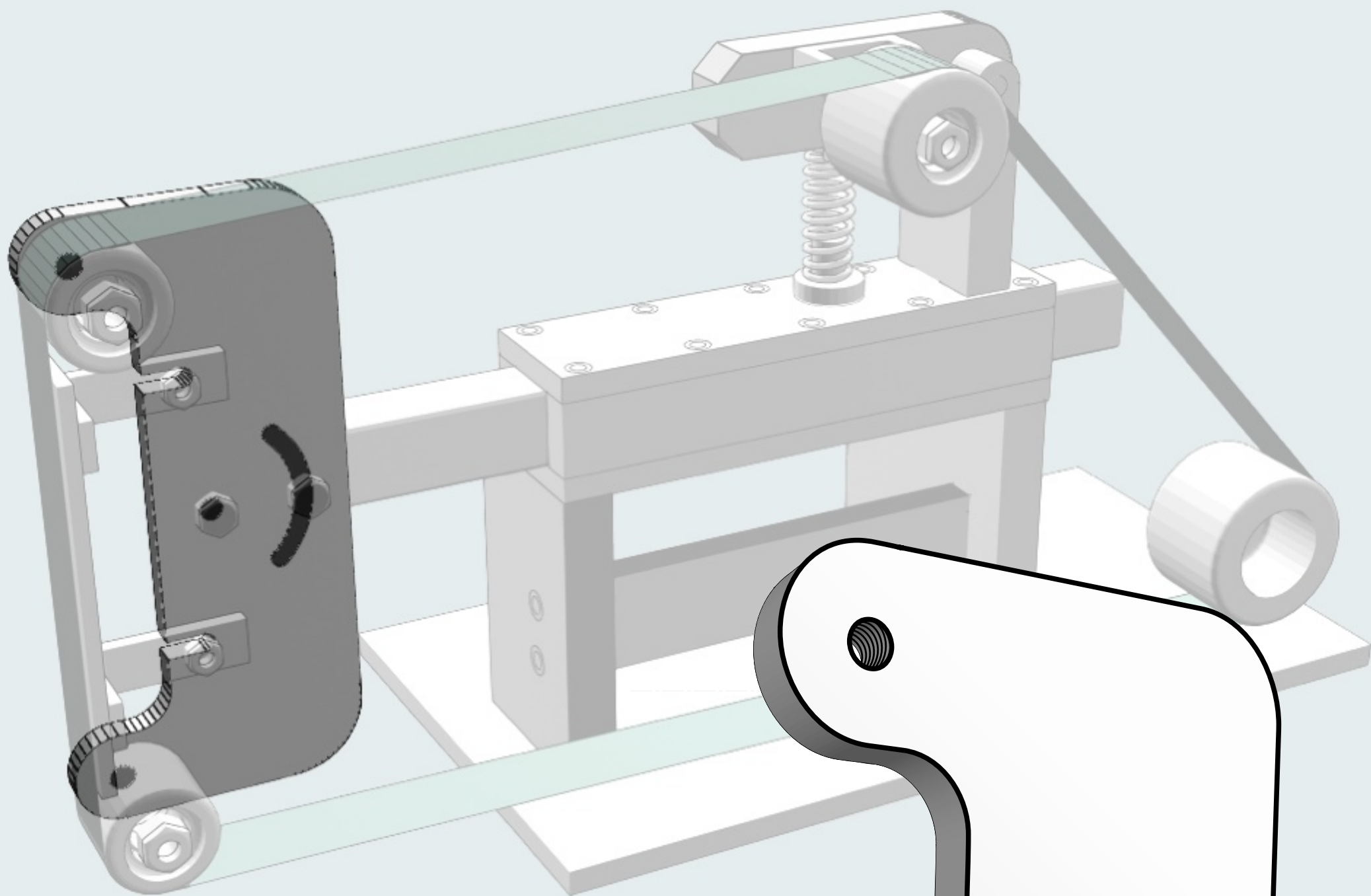

WIDOK PERSPEKTYWICZNY

