

Index

		P./S.
A	Vyhazovač nitridovaný	4-2
A-EX	Vyhazovač nitridovaný - palcový	4-14
AH	Vyhazovač kalený	4-4
AHX	Jádrový kolík - kalený	4-5
AW 275	Pružný vyhazovač	4-27
AW 280	Pružný vyhazovač	4-28/29
AW 281	Pružný vyhazovač - upínací vedení	4-28/29
AW 282	Pružný vyhazovač - vodící pouzdro	4-28/29
AW 283	Pružný vyhazovač - prodloužení	4-28/29
AW 285	Pružný vyhazovač - speciál dle poptávky	4-30
BA	Upínač pro vyhazovače	4-26
BE	Upínač pro vyhazovače	4-26
BT	Upínač pro vyhazovače	4-26
C	Vyhazovač osazený - nitridovaný	4-7
C	Jádrový kolík - palcový	4-15
C-EX	Vyhazovač osazený - nitrid. palcový	4-15
CH	Vyhazovač osazený - kalený	4-9
CX	Jádrový kolík - kalený - palcový	4-16
D	Vyhazovač s kuželovou hlavou - kalený	4-10/11
EVA	Vyhazovač bez hlavy	4-28
ETV	Trubkový vyhazovač bez hlavy	4-28
FK	Plochý vyhazovač - kalený	4-13
FW	Plochý vyhazovač - nitridovaný	4-12
KS	Trubkový vyhazovač - kalený	4-18
PCM	Vysoce výkonné jádrové kolíky (slit.mědi)	4-6
S	Trubkový vyhazovač - nitridovaný	4-17-19
TA	Vyhazovač nitridovaný v lázni	4-3
TC	Vyhazovač osazený nitridovaný v lázni	4-8
WZ 7065	Razník kalený - materiál HWS	4-20
WZ 7075	Razník kalený - materiál HSS	4-20

		P./S.
Info	● Custom-made ejector pins - Quotation/order form	4-21/26
	○ Speciální vyhazovače na poptávku - Poptávka / Objednávkový formulář	

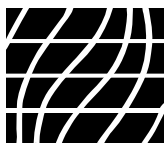

A Typ(e) DIN 1530/ISO 6751

● Ejector pins - nitrided

○ Vyhazovač - nitridovaný

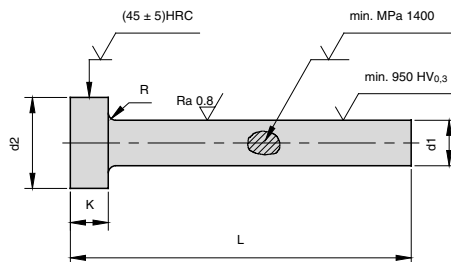
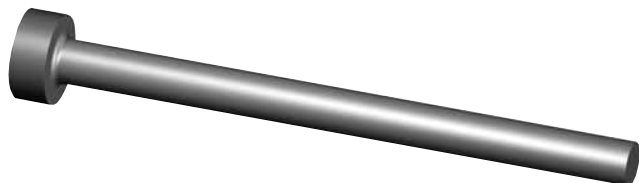

500°-550°C
Mat. 1.2344

REF	L ₀ ⁺² ₀															R	K	d ₂	d ₁
	100	125	160	200	250	315	400	500	630	800	1000	1250	1600	2000	0 -0,05				
EA 1 -L																0.2	2	3	1
EA 1,2 -L																0.2	2	3	1.2
EA 1,5 -L																0.2	1.5	3	1.5
EA 1,6 -L																0.2	1.5	3	1.6
EA 1,7 -L																0.2	2	3.5	1.7
EA 2 -L																0.2	2	4	2
EA 2,2 -L																0.2	2	4	2.2
EA 2,5 -L																0.3	2	5	2.5
EA 2,7 -L																0.3	2	5	2.7
EA 3 -L																0.3	3	6	3
EA 3,1 -L																0.3	3	6	3.1
EA 3,2 -L																0.3	3	6	3.2
EA 3,5 -L																0.3	3	7	3.5
EA 3,7 -L																0.3	3	7	3.7
EA 4 -L																0.3	3	8	4
EA 4,1 -L																0.3	3	8	4.1
EA 4,2 -L																0.3	3	8	4.2
EA 4,5 -L																0.3	3	8	4.5
EA 5 -L																0.3	3	10	5
EA 5,1 -L																0.3	3	10	5.1
EA 5,2 -L																0.3	3	10	5.2
EA 5,5 -L																0.3	3	10	5.5
EA 6 -L																0.5	5	12	6
EA 6,1 -L																0.5	5	12	6.1
EA 6,2 -L																0.5	5	12	6.2
EA 6,5 -L																0.5	5	12	6.5
EA 7 -L																0.5	5	12	7
EA 7,5 -L																0.5	5	12	7.5
EA 8 -L																0.5	5	14	8
EA 8,1 -L																0.5	5	14	8.1
EA 8,2 -L																0.5	5	14	8.2
EA 8,5 -L																0.5	5	14	8.5
EA 9 -L																0.5	5	14	9
EA 9,5 -L																0.5	5	14	9.5
EA 10 -L																0.5	5	16	10
EA 10,1-L																0.5	5	16	10.1
EA 10,2-L																0.5	5	16	10.2
EA 10,5-L																0.5	5	16	10.5
EA 11 -L																0.5	5	16	11
EA 12 -L																0.8	7	18	12
EA 12,2-L																0.8	7	18	12.2
EA 12,5-L																0.8	7	18	12.5
EA 14 -L																0.8	7	22	14
EA 14,2-L																0.8	7	22	14.2
EA 16 -L																0.8	7	22	16
EA 16,2-L																0.8	7	22	16.2
EA 18 -L																0.8	7	24	18
EA 20 -L																1	8	26	20
EA 25 -L																1	10	32	25
EA 32 -L																1	10	40	32

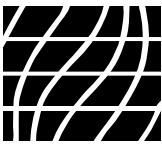

TA Typ(e) DIN 1530/ISO 6751

● Ejector pins - bath nitrided

○ Vyhazovač - nitridovaný v lázni - určeno pro tlakové lití

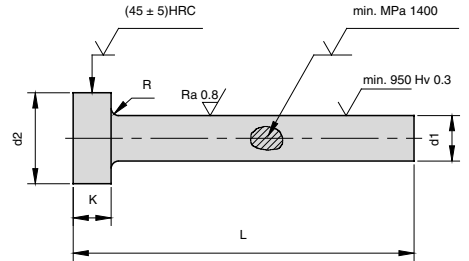
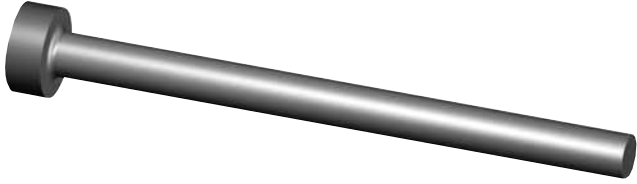

500°-550°C
Mat. 1.2344

REF	L ₀ ⁺²												R	K 0 -0,05	d ₂ 0 -0,2	d ₁ g ⁶		
	100	125	160	200	250	315	400	500	630	800	1000							
TA 1,5 -L															0.2	1.5	3	1.5
TA 2 -L															0.2	2	4	2
TA 2,2 -L															0.2	2	4	2.2
TA 2,5 -L															0.3	2	5	2.5
TA 2,7 -L															0.3	2	5	2.7
TA 3 -L															0.3	3	6	3
TA 3,2 -L															0.3	3	6	3.2
TA 3,5 -L															0.3	3	7	3.5
TA 3,7 -L															0.3	3	7	3.7
TA 4 -L															0.3	3	8	4
TA 4,2 -L															0.3	3	8	4.2
TA 4,5 -L															0.3	3	8	4.5
TA 5 -L															0.3	3	10	5
TA 5,2 -L															0.3	3	10	5.2
TA 5,5 -L															0.3	3	10	5.5
TA 6 -L															0.5	5	12	6
TA 6,2 -L															0.5	5	12	6.2
TA 6,5 -L															0.5	5	12	6.5
TA 7 -L															0.5	5	12	7
TA 8 -L															0.5	5	14	8
TA 8,2 -L															0.5	5	14	8.2
TA 8,5 -L															0.5	5	14	8.5
TA 9 -L															0.5	5	14	9
TA 10 -L															0.5	5	16	10
TA 10,2-L															0.5	5	16	10.2
TA 10,5-L															0.5	5	16	10.5
TA 11 -L															0.5	5	16	11
TA 12 -L															0.8	7	18	12
TA 12,2-L															0.8	7	18	12.2
TA 12,5-L															0.8	7	18	12.5
TA 14 -L															0.8	7	22	14
TA 16 -L															0.8	7	22	16
TA 18 -L															0.8	7	24	18
TA 20 -L															1	8	26	20
TA 25 -L															1	10	32	25

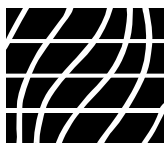

AH Typ(e) DIN 1530/ISO 6751

● Ejector pins - hardened

○ Vyhazovač - kalený

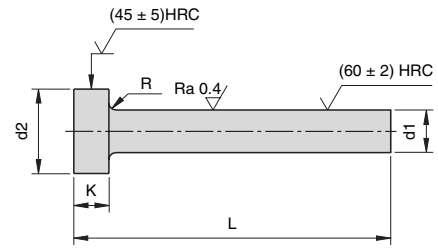
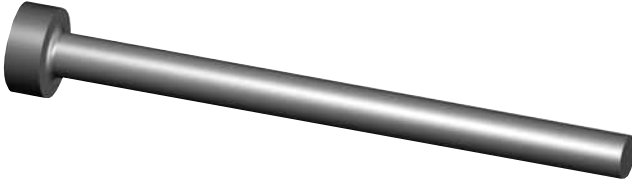

250°C
Mat. 1.2210

REF	L ₀ ⁺²															R	K	d ₂ 0 -0,05	d ₁ g ⁶
	40	63	80	100	125	160	200	250	315	400	500	630	800	1000					
AH 1,5 -L																0.2	1.5	3	1.5
AH 1,6 -L																0.2	1.5	3	1.6
AH 1,7 -L																0.2	1.5	3	1.7
AH 1,8 -L																0.2	1.5	3	1.8
AH 2 -L																0.2	2	4	2
AH 2,1 -L																0.2	2	4	2.1
AH 2,2 -L																0.2	2	4	2.2
AH 2,5 -L																0.3	2	5	2.5
AH 2,7 -L																0.3	2	5	2.7
AH 3 -L																0.3	3	6	3
AH 3,1 -L																0.3	3	6	3.1
AH 3,2 -L																0.3	3	6	3.2
AH 3,5 -L																0.3	3	7	3.5
AH 3,7 -L																0.3	3	7	3.7
AH 4 -L																0.3	3	8	4
AH 4,1 -L																0.3	3	8	4.1
AH 4,2 -L																0.3	3	8	4.2
AH 4,5 -L																0.3	3	8	4.5
AH 4,7 -L																0.3	3	8	4.7
AH 5 -L																0.3	3	10	5
AH 5,1 -L																0.3	3	10	5.1
AH 5,2 -L																0.3	3	10	5.2
AH 5,5 -L																0.3	3	10	5.5
AH 6 -L																0.5	5	12	6
AH 6,1 -L																0.5	5	12	6.1
AH 6,2 -L																0.5	5	12	6.2
AH 6,5 -L																0.5	5	12	6.5
AH 7 -L																0.5	5	12	7
AH 8 -L																0.5	5	14	8
AH 8,1 -L																0.5	5	14	8.1
AH 8,2 -L																0.5	5	14	8.2
AH 8,5 -L																0.5	5	14	8.5
AH 9 -L																0.5	5	14	9
AH 10 -L																0.5	5	16	10
AH 10,1 -L																0.5	5	16	10.1
AH 10,2 -L																0.5	5	16	10.2
AH 10,5 -L																0.5	5	16	10.5
AH 11 -L																0.5	5	16	11
AH 12 -L																0.8	7	18	12
AH 12,1 -L																0.8	7	18	12.1
AH 12,2 -L																0.8	7	18	12.2
AH 12,5 -L																0.8	7	18	12.5
AH 14 -L																0.8	7	22	14
AH 16 -L																0.8	7	22	16
AH 18 -L																0.8	7	24	18
AH 20 -L																1	8	26	20

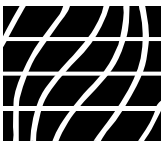

AHX Typ(e) DIN 1530/ISO 6751

● Core pins - hardened

○ Jádrový kolík

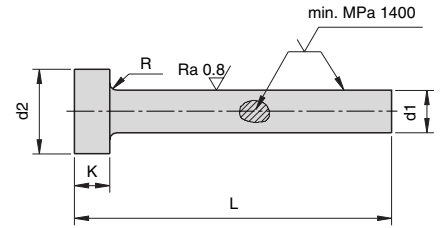
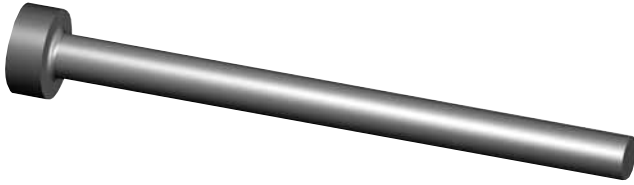

500°-550°C
Mat. 1.2344

REF	L ₀ ⁺²													R	K	d ₂ 0 -0,05	d ₁ g ⁶
	63	80	100	125	160	200	250	315	400	500	630	800	1000				
AHX 1 - L														0.2	1.5	3	1
AHX 1,5 - L														0.2	1.5	3	1.5
AHX 2 - L														0.2	2	4	2
AHX 2,2 - L														0.2	2	4	2.2
AHX 2,5 - L														0.3	2	5	2.5
AHX 2,7 - L														0.3	2	5	2.7
AHX 3 - L														0.3	3	6	3
AHX 3,2 - L														0.3	3	6	3.2
AHX 3,5 - L														0.3	3	7	3.5
AHX 3,7 - L														0.3	3	7	3.7
AHX 4 - L														0.3	3	8	4
AHX 4,2 - L														0.3	3	8	4.2
AHX 4,5 - L														0.3	3	8	4.5
AHX 5 - L														0.3	3	10	5
AHX 5,2 - L														0.3	3	10	5.2
AHX 5,5 - L														0.3	3	10	5.5
AHX 6 - L														0.5	5	12	6
AHX 6,2 - L														0.5	5	12	6.2
AHX 6,5 - L														0.5	5	12	6.5
AHX 7 - L														0.5	5	12	7
AHX 7,5 - L														0.5	5	12	7.5
AHX 8 - L														0.5	5	14	8
AHX 8,2 - L														0.5	5	14	8.2
AHX 8,5 - L														0.5	5	14	8.5
AHX 9 - L														0.5	5	14	9
AHX 9,5 - L														0.5	5	14	9.5
AHX 10 - L														0.5	5	16	10
AHX 10,2-L														0.5	5	16	10.2
AHX 10,5-L														0.5	5	16	10.5
AHX 11 - L														0.5	5	16	11
AHX 12 - L														0.8	7	18	12
AHX 12,2-L														0.8	7	18	12.2
AHX 12,5-L														0.8	7	18	12.5
AHX 14 - L														0.8	7	22	14
AHX 16 - L														0.8	7	22	16
AHX 18 - L														0.8	7	24	18
AHX 20 - L														1	8	26	20
AHX 25 - L														1	10	32	25
AHX 32 - L														1	10	40	32

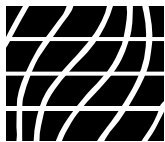

PCM Typ(e) DIN 1530/ISO 6751

● Performance core pins

○ Vysoce výkonné jádrové kolíky

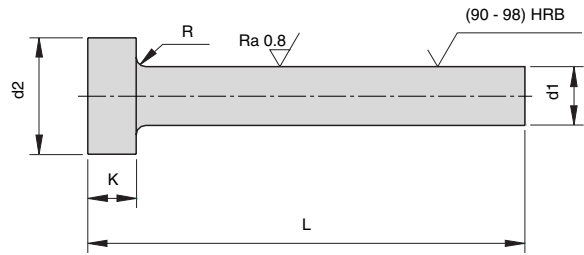
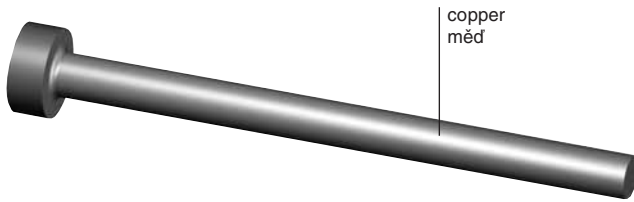

● 350°C - Mat. : Beryllium-free copper-based alloy ● 350°C - Mat. : Slitina mědi bez berylia

REF	L $\begin{smallmatrix} +1 \\ 0 \end{smallmatrix}$				R	K	d ₂	d ₁
	100	160	250	315				
PCM-015-L					0.2	1.5	3	1.5
PCM-020-L					0.2	2	4	2
PCM-025-L					0.3	2	5	2.5
PCM-030-L					0.3	3	6	3
PCM-035-L					0.3	3	7	3.5
PCM-040-L					0.3	3	8	4
PCM-045-L					0.3	3	8	4.5
PCM-050-L					0.3	3	10	5
PCM-060-L					0.5	5	12	6
PCM-070-L					0.5	5	12	7
PCM-080-L					0.5	5	14	8
PCM-100-L					0.5	5	16	10
PCM-120-L					0.8	7	18	12
PCM-140-L					0.8	7	22	14
PCM-160-L					0.8	7	22	16

● High thermal conductivity pins

○ Vysoce tepelně vodivé kolíky

Advantages:

- Reduced cycle time
- 5 times better conductivity than steel
- Improved part quality
- Lower machining costs
- Longer service life

Výhody:

- Kratší doba jednoho cyklu
- 5-krát lepší tepelná vodivost než ocel
- Lepší kvalita výlisků
- Nižší výrobní náklady
- Delší životnost

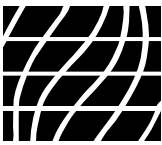

C Typ(e) DIN 1530/ISO 8694

● Ejector pins - nitrided

○ Vyhazovač osazený - nitridovaný

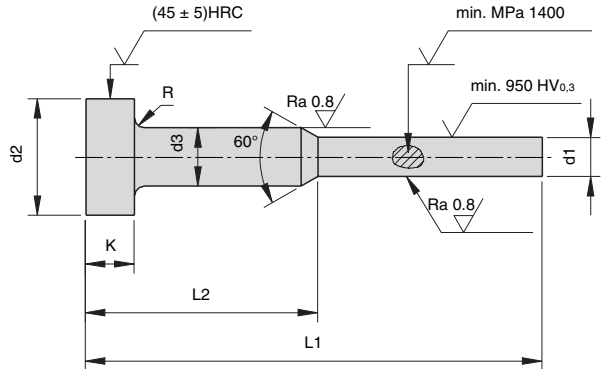

500°-550°C
Mat. 1.2344

REF	L1 ⁺² / ₀											R	K	d ₃	d ₂	d ₁
	63	80	100	125	160	160	160	200	250	250						
	L2 ⁻¹ / ₋₂															
	25	35	50	50	50	63	75	75	75	100						
C 0,7 -L1 -L2												0.2	2	2	4	0.7
C 0,8 -L1 -L2												0.3	2	2	4	0.8
C 0,9 -L1 -L2												0.3	2	2	4	0.9
C 1 -L1 -L2												0.3	2	2	4	1
C 1,1 -L1 -L2												0.3	2	2	4	1.1
C 1,2 -L1 -L2												0.3	2	2	4	1.2
C 1,3 -L1 -L2												0.3	2	2	4	1.3
C 1,4 -L1 -L2												0.3	2	2	4	1.4
C 1,5 -L1 -L2												0.3	3	3	6	1.5
C 1,6 -L1 -L2												0.3	3	3	6	1.6
C 1,7 -L1 -L2												0.3	3	3	6	1.7
C 1,8 -L1 -L2												0.3	3	3	6	1.8
C 1,9 -L1 -L2												0.3	3	3	6	1.9
C 2 -L1 -L2												0.3	3	3	6	2
C 2,1 -L1 -L2												0.3	3	3	6	2.1
C 2,2 -L1 -L2												0.3	3	3	6	2.2
C 2,3 -L1 -L2												0.3	3	3	6	2.3
C 2,4 -L1 -L2												0.3	3	3	6	2.4
C 2,5 -L1 -L2												0.3	3	3	6	2.5
C 2,6 -L1 -L2												0.3	3	3	6	2.6
C 2,7 -L1 -L2												0.3	3	3	6	2.7
C 2,8 -L1 -L2												0.3	3	3	6	2.8
C 2,9 -L1 -L2												0.3	3	3	6	2.9
C 3 -L1 -L2												0.3	3	4	8	3
C 3,1 -L1 -L2												0.3	3	4	8	3.1
C 3,2 -L1 -L2												0.3	3	4	8	3.2
C 3,3 -L1 -L2												0.3	3	4	8	3.3
C 3,4 -L1 -L2												0.3	3	4	8	3.4
C 3,5 -L1 -L2												0.3	3	4	8	3.5

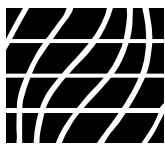

TC Typ(e) DIN 1530/ISO 8694

● Ejector pins - bath nitrided

○ Vyhazovač osazený - nitridovaný v lázni - určeno pro tlakové lití

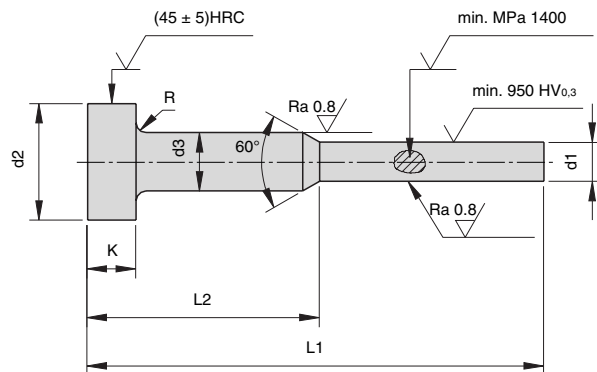

500°-550°C
Mat. 1.2344

REF	L1 ⁺² / ₀										R	K	d ₃	d ₂	d ₁
	63	80	100	125	160	160	160	200	250	250					
	L2 ⁻¹ / ₋₂														
	25	35	50	50	50	63	75	75	75	100					
TC 0,7 -L1 -L2											0.2	2	2	4	0.7
TC 0,8 -L1 -L2											0.3	2	2	4	0.8
TC 0,9 -L1 -L2											0.3	2	2	4	0.9
TC 1 -L1 -L2											0.3	2	2	4	1
TC 1,1 -L1 -L2											0.3	2	2	4	1.1
TC 1,2 -L1 -L2											0.3	2	2	4	1.2
TC 1,3 -L1 -L2											0.3	2	2	4	1.3
TC 1,4 -L1 -L2											0.3	2	2	4	1.4
TC 1,5 -L1 -L2											0.3	3	3	6	1.5
TC 1,6 -L1 -L2											0.3	3	3	6	1.6
TC 1,7 -L1 -L2											0.3	3	3	6	1.7
TC 1,8 -L1 -L2											0.3	3	3	6	1.8
TC 1,9 -L1 -L2											0.3	3	3	6	1.9
TC 2 -L1 -L2											0.3	3	3	6	2
TC 2,1 -L1 -L2											0.3	3	3	6	2.1
TC 2,2 -L1 -L2											0.3	3	3	6	2.2
TC 2,3 -L1 -L2											0.3	3	3	6	2.3
TC 2,4 -L1 -L2											0.3	3	3	6	2.4
TC 2,5 -L1 -L2											0.3	3	3	6	2.5
TC 2,6 -L1 -L2											0.3	3	3	6	2.6
TC 2,7 -L1 -L2											0.3	3	3	6	2.7
TC 2,8 -L1 -L2											0.3	3	3	6	2.8
TC 2,9 -L1 -L2											0.3	3	3	6	2.9
TC 3 -L1 -L2											0.3	3	4	8	3
TC 3,1 -L1 -L2											0.3	3	4	8	3.1
TC 3,2 -L1 -L2											0.3	3	4	8	3.2
TC 3,3 -L1 -L2											0.3	3	4	8	3.3
TC 3,4 -L1 -L2											0.3	3	4	8	3.4
TC 3,5 -L1 -L2											0.3	3	4	8	3.5



D Typ(e) DIN 1530

● Ejector pins - hardened

○ Vyhazovač s kuželovou hlavou - kalený

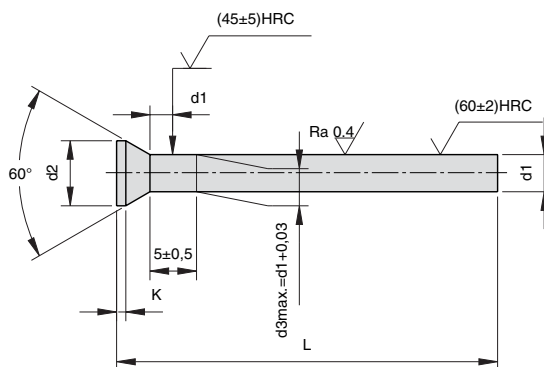
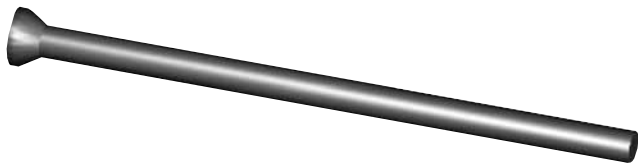

250°C
Mat. 1.2210

REF	L ⁺² / ₀												K ^{+0,2} / ₀	d ₂ ⁰ / _{-0,2}	d ₁ g ⁶
	40	63	71	80	100	125	150	160	175	200	250	315			
D 1 -L													0.5	1.8	1
D 1,1 -L													0.5	1.8	1.1
D 1,2 -L													0.5	2	1.2
D 1,25-L													0.5	2	1.25
D 1,3 -L													0.5	2	1.3
D 1,4 -L													0.5	2.2	1.4
D 1,5 -L													0.5	2.2	1.5
D 1,6 -L													0.5	2.5	1.6
D 1,7 -L													0.5	2.5	1.7
D 1,75-L													0.5	2.8	1.75
D 1,8 -L													0.5	2.8	1.8
D 1,9 -L													0.5	2.8	1.9
D 2 -L													0.5	3	2
D 2,1 -L													0.5	3.2	2.1
D 2,2 -L													0.5	3.2	2.2
D 2,25-L													0.5	3.5	2.25
D 2,3 -L													0.5	3.5	2.3
D 2,4 -L													0.5	3.5	2.4
D 2,5 -L													0.5	3.5	2.5
D 2,6 -L													0.5	4	2.6
D 2,7 -L													0.5	4	2.7
D 2,75-L													0.5	4	2.75
D 2,8 -L													0.5	4	2.8
D 2,9 -L													0.5	4	2.9
D 3 -L													0.5	4.5	3
D 3,1 -L													0.5	4.5	3.1
D 3,2 -L													0.5	4.5	3.2
D 3,25-L													0.5	4.5	3.25
D 3,3 -L													0.5	4.5	3.3
D 3,4 -L													0.5	4.5	3.4
D 3,5 -L													0.5	5	3.5
D 3,6 -L													0.5	5	3.6
D 3,7 -L													0.5	5	3.7
D 3,75-L													0.5	5	3.75
D 3,8 -L													0.5	5	3.8
D 3,9 -L													0.5	5	3.9
D 4 -L													0.5	5.5	4
D 4,1 -L													0.5	5.5	4.1
D 4,2 -L													0.5	5.5	4.2
D 4,25-L													0.5	5.5	4.25
D 4,4 -L													0.5	5.5	4.4
D 4,5 -L													0.5	6	4.5
D 4,6 -L													0.5	6	4.6
D 4,75-L													0.5	6	4.75
D 5 -L													0.5	6.5	5
D 5,1 -L													0.5	6.5	5.1
D 5,2 -L													0.5	6.5	5.2
D 5,25-L													0.5	6.5	5.25

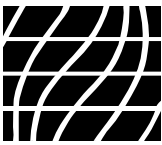

D Typ(e) DIN 1530

● Ejector pins - hardened

○ Vyhazovač s kuželovou hlavou - kalený

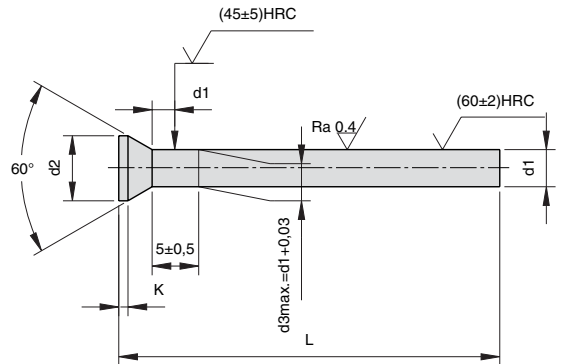
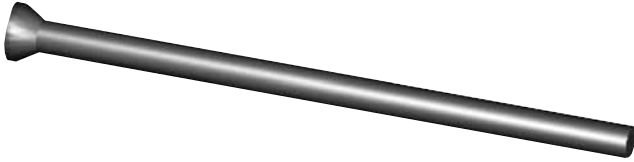

250°C
Mat. 1.2210

REF	L $\begin{smallmatrix} +2 \\ 0 \end{smallmatrix}$												K $\begin{smallmatrix} +0.2 \\ 0 \end{smallmatrix}$	d ₂ $\begin{smallmatrix} 0 \\ -0.2 \end{smallmatrix}$	d ₁ g ⁶
	40	63	71	80	100	125	150	160	175	200	250	315			
D 5,3 -L													0.5	6.5	5.3
D 5,4 -L													0.5	6.5	5.4
D 5,5 -L													0.5	7	5.5
D 5,6 -L													0.5	7	5.6
D 5,75-L													0.5	7	5.75
D 6 -L													0.5	8	6
D 6,2 -L													0.5	8	6.2
D 6,5 -L													1	9	6.5
D 7 -L													1	9	7
D 7,5 -L													1	10	7.5
D 8 -L													1	10	8
D 8,2 -L													1	10	8.2
D 8,5 -L													1	11	8.5
D 9 -L													1	11	9
D 10 -L													1	12	10
D 11 -L													1	13	11
D 12 -L													1	14	12
D 14 -L													1.5	16	14
D 16 -L													1.5	18	16

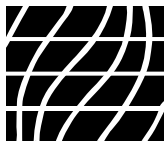

FW Typ(e) DIN 1530/ISO 8693

● Flat ejector pins - nitrided

○ Plochý vyhazovač - nitridovaný

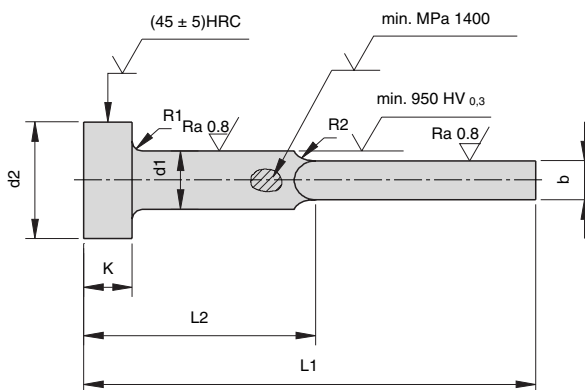
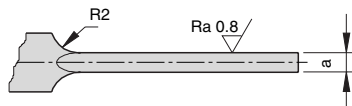
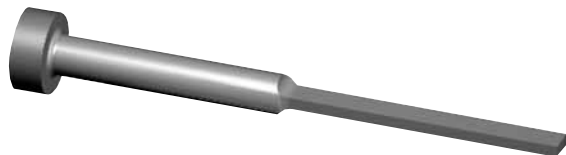

500°- 550°C
Mat. 1.2344

REF	L1 ⁺² / ₀									R ₁	R ₂	K	d ₂	d ₁	a	b
	63	80	100	125	160	200	250	315	400							
	L2 ⁻¹ / ₋₂															
	32	40	50	63	80	100	125	160	200							
FW 0,8-3,5 -L1										0.3	10	3	8	4	0.8	3.5
FW 1,0-3,5 -L1										0.3	10	3	8	4	1	3.5
FW 1,2-3,5 -L1										0.3	10	3	8	4	1.2	3.5
FW 0,8-3,8 -L1										0.3	10	3	8	4	0.8	3.8
FW 1,0-3,8 -L1										0.3	10	3	8	4.2	1	3.8
FW 1,2-3,8 -L1										0.3	10	3	8	4.2	1.2	3.8
FW 1,0-4,5 -L1										0.3	10	3	10	5	1	4.5
FW 1,2-4,5 -L1										0.3	10	3	10	5	1.2	4.5
FW 1,5-4,5 -L1										0.3	10	3	10	5	1.5	4.5
FW 1,6-4,5 -L1										0.3	10	3	10	5	1.6	4.5
FW 1,8-4,5 -L1										0.3	10	3	10	5	1.8	4.5
FW 1,0-5,5 -L1										0.5	10	5	12	6	1	5.5
FW 1,2-5,5 -L1										0.5	10	5	12	6	1.2	5.5
FW 1,5-5,5 -L1										0.5	10	5	12	6	1.5	5.5
FW 1,6-5,5 -L1										0.5	10	5	12	6	1.6	5.5
FW 1,8-5,5 -L1										0.5	10	5	12	6	1.8	5.5
FW 2,0-5,5 -L1										0.5	10	5	12	6	2	5.5
FW 1,2-7,5 -L1										0.5	10	5	14	8	1.2	7.5
FW 1,5-7,5 -L1										0.5	10	5	14	8	1.5	7.5
FW 1,6-7,5 -L1										0.5	10	5	14	8	1.6	7.5
FW 1,8-7,5 -L1										0.5	10	5	14	8	1.8	7.5
FW 2,0-7,5 -L1										0.5	10	5	14	8	2	7.5
FW 1,5-9,5 -L1										0.5	10	5	16	10	1.5	9.5
FW 1,8-9,5 -L1										0.5	10	5	16	10	1.8	9.5
FW 2,0-9,5 -L1										0.5	10	5	16	10	2	9.5
FW 2,0-11,5-L1										0.8	10	7	18	12	2	11.5
FW 2,5-11,5-L1										0.8	10	7	18	12	2.5	11.5
FW 2,0-12,0-L1										0.8	10	7	18	12.5	2	12
FW 2,5-12,0-L1										0.8	10	7	18	12.5	2.5	12
FW 2,0-15,0-L1										0.8	10	7	22	16	2	15
FW 2,5-15,0-L1										0.8	10	7	22	16	2.5	15
FW 2,0-15,5-L1										0.8	10	7	22	16	2	15.5
FW 2,5-15,5-L1										0.8	10	7	22	16	2.5	15.5

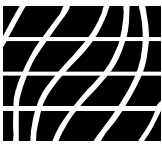

FK Typ(e) DIN 1530/ISO 8693

● Flat ejector pins - hardened

○ Plochý vyhazovač - kalený

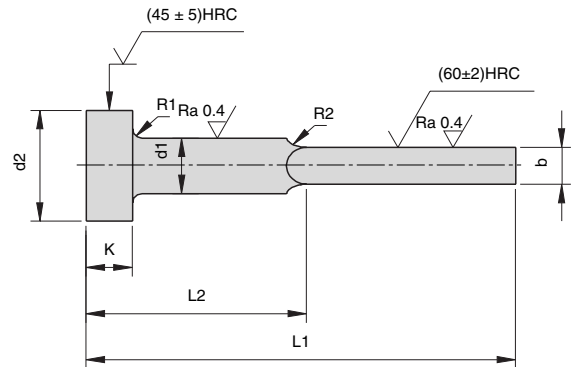
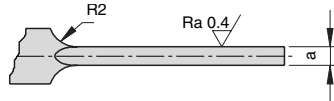
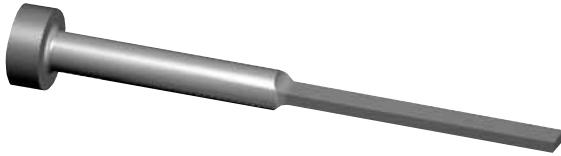

250°C
Mat. 1.2210

REF	L1 ⁺² / ₀									R ₁	R ₂	K	d ₂	d ₁	a	b
	63	80	100	125	160	200	250	315	400							
	L2 ⁻¹ / ₋₂															
	32	40	50	63	80	100	125	160	200							
FK 1,0-3,5 -L1										0.3	10	3	8	4	1	3.5
FK 1,2-3,5 -L1										0.3	10	3	8	4	1.2	3.5
FK 0,8-3,8 -L1										0.3	10	3	8	4.2	0.8	3.8
FK 1,0-3,8 -L1										0.3	10	3	8	4.2	1	3.8
FK 1,2-3,8 -L1										0.3	10	3	8	4.2	1.2	3.8
FK 1,0-4,5 -L1										0.3	10	3	10	5	1	4.5
FK 1,2-4,5 -L1										0.3	10	3	10	5	1.2	4.5
FK 1,5-4,5 -L1										0.3	10	3	10	5	1.5	4.5
FK 1,0-5,5 -L1										0.5	10	5	12	6	1	5.5
FK 1,2-5,5 -L1										0.5	10	5	12	6	1.2	5.5
FK 1,5-5,5 -L1										0.5	10	5	12	6	1.5	5.5
FK 2,0-5,5 -L1										0.5	10	5	12	6	2	5.5
FK 1,2-7,5 -L1										0.5	10	5	14	8	1.2	7.5
FK 1,5-7,5 -L1										0.5	10	5	14	8	1.5	7.5
FK 2,0-7,5 -L1										0.5	10	5	14	8	2	7.5
FK 1,5-9,5 -L1										0.5	10	5	16	10	1.5	9.5
FK 2,0-9,5 -L1										0.5	10	5	16	10	2	9.5
FK 2,0-11,5-L1										0.8	10	7	18	12	2	11.5
FK 2,5-11,5-L1										0.8	10	7	18	12	2.5	11.5
FK 2,0-15,5-L1										0.8	10	7	22	16	2	15.5
FK 2,5-15,5-L1										0.8	10	7	22	16	2.5	15.5

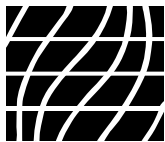

A-EX Typ(e)

● Ejector pins - inch - nitrided

○ Vyhazovač - palcové míry - nitridovaný

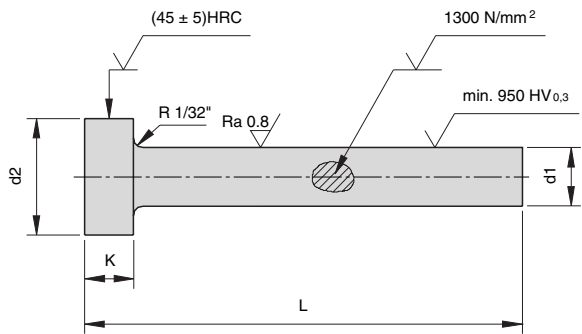
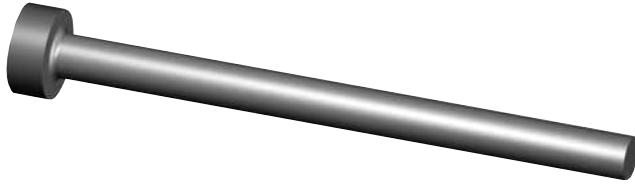

$d_1 = +0,005"$ } OS = ● Oversize
 ○ Přesah

500°- 550°C
 Mat. H13

REF	L $\begin{matrix} +0,375" \\ -0,000" \end{matrix}$								K	d ₂	d ₁	
	6"	10"	10"OS	14"	14"OS	18"	18"OS	25"				36"
EX 3 -L										1/8"	1/4"	3/64"
EX 5 -L										1/8"	1/4"	1/16"
EX 6 -L										1/8"	1/4"	5/64"
EX 7 -L										1/8"	1/4"	3/32"
EX 8 -L										1/8"	1/4"	7/64"
EX 9 -L										1/8"	1/4"	1/8"
EX 10-L										1/8"	1/4"	9/64"
EX 11-L										5/32"	9/32"	5/32"
EX 12-L										3/16"	11/32"	11/64"
EX 13-L										3/16"	3/8"	3/16"
EX 14-L										3/16"	3/8"	13/64"
EX 15-L										3/16"	13/32"	7/32"
EX 16-L										3/16"	13/32"	15/64"
EX 17-L										3/16"	7/16"	1/4"
EX 18-L										1/4"	7/16"	17/64"
EX 19-L										1/4"	7/16"	9/32"
EX 20-L										1/4"	1/2"	19/64"
EX 21-L										1/4"	1/2"	5/16"
EX 22-L										1/4"	9/16"	21/64"
EX 23-L										1/4"	9/16"	11/32"
EX 24-L										1/4"	5/8"	23/64"
EX 25-L										1/4"	5/8"	3/8"
EX 27-L										1/4"	11/16"	13/32"
EX 29-L										1/4"	11/16"	7/16"
EX 31-L										1/4"	3/4"	15/32"
EX 33-L										1/4"	3/4"	1/2"
EX 35-L										1/4"	13/16"	9/16"
EX 37-L										1/4"	7/8"	5/8"
EX 39-L										1/4"	15/16"	11/16"
EX 41-L										1/4"	1"	3/4"
EX 45-L										1/4"	1 1/8"	7/8"
EX 47-L										1/4"	1 1/4"	1"

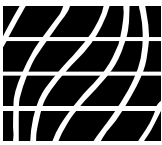

C-EX Typ(e)

● Ejector pins - inch - nitrided

○ Vyhazovač osazený - palcové míry - nitridovaný

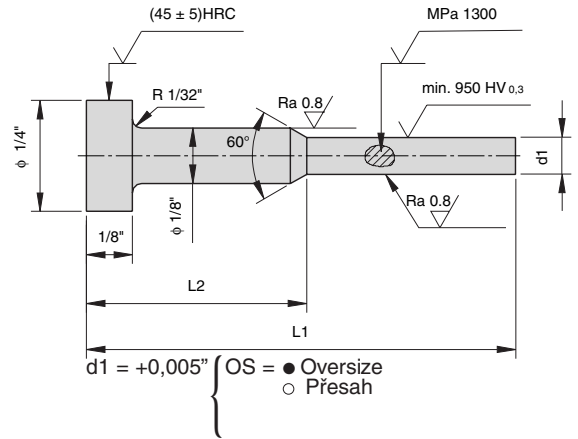

500°- 550°C
Mat. H13

REF	L1 $+0,375"$ $-0,000"$							d ₁ $+0,000"$ $-0,001"$
	6"	6"	10"	10"OS	10"	10"OS	14	
	1/2	2	1/2	1/2	2	2	2	
EX 3 -L2/L1								3/64"
EX 5 -L2/L1								1/16"
EX 6 -L2/L1								5/64"
EX 7 -L2/L1								3/32"
EX 8 -L2/L1								7/64"

C Typ(e)

● Core pins - inch

○ Jádrový kolík - palcové míry

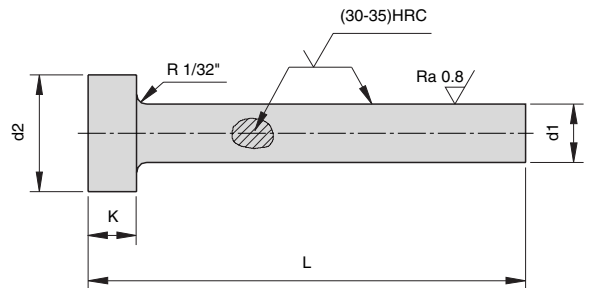
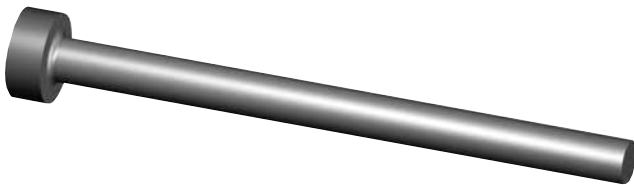

500°- 550°C
Mat. H13

REF	L $+0,375"$ $-0,000"$			K $+0,000"$ $-0,002"$	d ₂ $+0,000"$ $-0,010"$	d ₁ $+0,001"$ $-0,000"$
	3"	6"	10"			
C 7 -L				1/8"	1/4"	3/32"
C 8 -L				1/8"	1/4"	7/64"
C 9 -L				1/8"	1/4"	1/8"
C 10-L				1/8"	1/4"	9/64"
C 11-L				5/32"	9/32"	5/32"
C 12-L				3/16"	11/32"	11/64"
C 13-L				3/16"	3/8"	3/16"
C 14-L				3/16"	3/8"	13/64"
C 15-L				3/16"	13/32"	7/32"
C 17-L				3/16"	7/16"	1/4"
C 19-L				1/4"	7/16"	9/32"
C 21-L				1/4"	1/2"	5/16"
C 23-L				1/4"	9/16"	11/32"
C 25-L				1/4"	5/8"	3/8"
C 27-L				1/4"	11/16"	13/32"
C 29-L				1/4"	11/16"	7/16"
C 31-L				1/4"	3/4"	15/32"
C 33-L				1/4"	3/4"	1/2"
C 35-L				1/4"	13/16"	9/16"
C 37-L				1/4"	7/8"	5/8"
C 41-L				1/4"	1"	3/4"

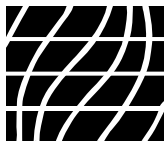

CX Typ(e)

● Core pins - inch - hardened

○ Jádrový kolík - palcové míry

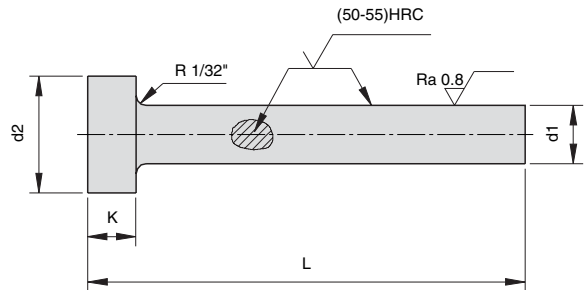
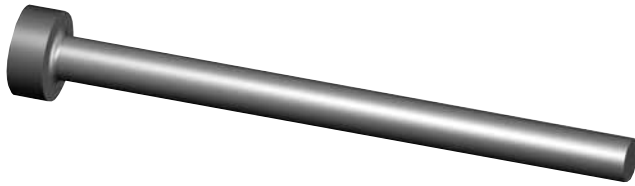

500°- 550°C
Mat. H13

REF	L $+0.375^{+0.000}$ -0.000			K	d ₂ $+0.000^{+0.000}$ -0.010	d ₁ $+0.001^{+0.001}$ -0.000
	3"	6"	10"			
CX 7 -L				1/8"	1/4"	3/32"
CX 8 -L				1/8"	1/4"	7/64"
CX 9 -L				1/8"	1/4"	1/8"
CX 10 -L				1/8"	1/4"	9/64"
CX 11 -L				5/32"	9/32"	5/32"
CX 12 -L				3/16"	11/32"	11/64"
CX 13 -L				3/16"	3/8"	3/16"
CX 14 -L				3/16"	3/8"	13/64"
CX 15 -L				3/16"	16/32"	7/32"
CX 17 -L				3/16"	7/16"	1/4"
CX 19 -L				1/4"	7/16"	9/32"
CX 21 -L				1/4"	1/2"	5/16"
CX 23 -L				1/4"	9/16"	11/32"
CX 25 -L				1/4"	5/8"	3/8"
CX 27 -L				1/4"	11/16"	13/32"
CX 29 -L				1/4"	11/16"	7/16"
CX 31 -L				1/4"	3/4"	15/32"
CX 33 -L				1/4"	3/4"	1/2"
CX 35 -L				1/4"	13/16"	9/16"
CX 37 -L				1/4"	7/8"	5/8"
CX 41 -L				1/4"	1"	3/4"

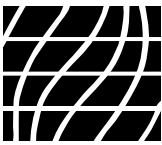

S Typ(e) DIN 16756/ISO 8405

● Ejector sleeves - nitrided

○ Trubkový vyhazovač - nitridovaný

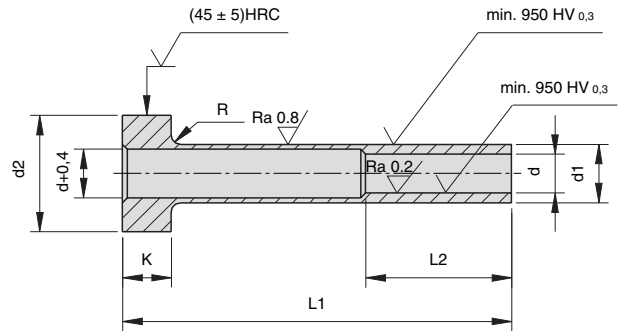
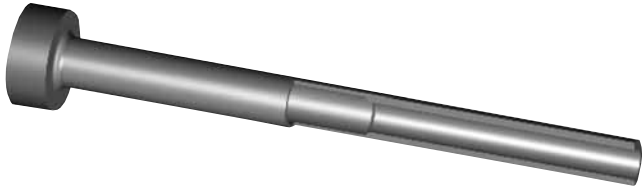

500°- 550°C
Mat. 1.2344

REF	L1 ⁺² / ₀																	L2	R	K	d ₂ ₀ ⁰ _{-0,05}	d ₁ _{g⁶}	d _{H⁵}			
	60	75	80	95	100	110	125	150	170	175	200	225	250	275	300	325	350							375	400	
S 153 -L																				30	0.3	3	6	3	1.5	
S 163 -L																					30	0.3	3	6	3	1.6
S 173 -L																					30	0.3	3	6	3	1.7
S 183 -L																					30	0.3	3	6	3	1.8
S 24 -L																					35	0.3	3	8	4	2
S 224 -L																					35	0.3	3	8	4	2.2
S 255 -L																					35	0.3	3	10	5	2.5
S 275 -L																					45	0.3	3	10	5	2.7
S 285 -L																					45	0.3	3	10	5	2.8
S 35 -L																					45	0.3	3	10	5	3
S 325 -L																					45	0.3	3	10	5	3.2
S 356 -L																					45	0.5	5	12	6	3.5
S 376 -L																					45	0.5	5	12	6	3.7
S 46 -L																					45	0.5	5	12	6	4
S 428 -L																					45	0.5	5	14	8	4.2
S 458 -L																					45	0.5	5	14	8	4.5
S 58 -L																					45	0.5	5	14	8	5
S 528 -L																					45	0.5	5	14	8	5.2
S 610 -L																					45	0.5	5	16	10	6
S 6210 -L																					45	0.5	5	16	10	6.2
S 6510 -L																					45	0.5	5	16	10	6.5
S 812 -L																					45	0.8	7	18	12	8
S 8212 -L																					45	0.8	7	18	12	8.2
S 8512 -L																					45	0.8	7	18	12	8.5
S 1014 -L																					45	0.8	7	22	14	10
S 10214 -L																					45	0.8	7	22	14	10.2
S 10514 -L																					55	0.8	7	22	14	10.5
S 1114 -L																					55	0.8	7	22	14	11
S 1216 -L																					45	0.8	7	22	16	12
S 12516 -L																					55	0.8	7	22	16	12.5
S 1418 -L																					55	0.8	9	24	18	14
S 1620 -L																					55	0.8	9	26	20	16
S 1822 -L																					55	0.8	9	28	22	18

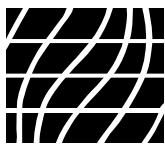

KS Typ(e) DIN 16756/ISO 8405

● Ejector sleeves - hardened

○ Trubkový vyhazovač - kalený

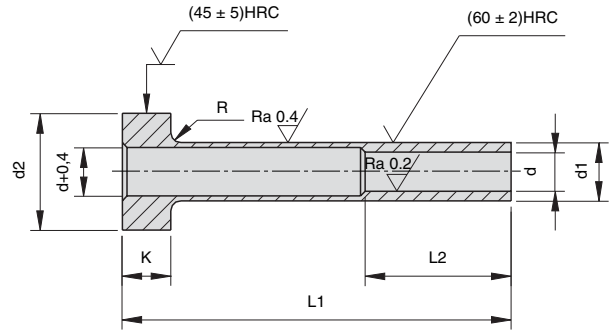
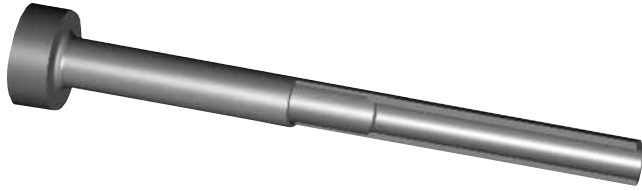

200° - 250°C
Mat. 1.2210

REF	L1 ⁺² / ₀																				L2	R	K	d ₂ _{0 -0.05}	d ₁ _{0 -0.2}	d H ⁶			
	50	60	70	75	80	90	100	110	125	150	170	175	200	225	250	275	300	325	350	400							450	500	
KS 153 -L1																							35	0.3	3	6	3	1.5	
KS 163 -L1																								35	0.3	3	6	3	1.6
KS 173 -L1																								35	0.3	3	6	3	1.7
KS 183 -L1																								35	0.3	3	6	3	1.8
KS 24 -L1																								35	0.3	3	8	4	2
KS 224 -L1																								35	0.3	3	8	4	2.2
KS 255 -L1																								35	0.3	3	10	5	2.5
KS 275 -L1																								45	0.3	3	10	5	2.7
KS 35 -L1																								45	0.3	3	10	5	3
KS 325 -L1																								45	0.3	3	10	5	3.2
KS 356 -L1																								45	0.5	5	12	6	3.5
KS 376 -L1																								45	0.5	5	12	6	3.7
KS 46 -L1																								45	0.5	5	12	6	4
KS 428 -L1																								45	0.5	5	14	8	4.2
KS 458 -L1																								45	0.5	5	14	8	4.5
KS 58 -L1																								45	0.5	5	14	8	5
KS 528 -L1																								45	0.5	5	14	8	5.2
KS 558 -L1																								45	0.5	5	14	8	5.5
KS 610 -L1																								45	0.5	5	16	10	6
KS 6210 -L1																								45	0.5	5	16	10	6.2
KS 6510 -L1																								45	0.5	5	16	10	6.5
KS 812 -L1																								45	0.8	7	18	12	8
KS 8212 -L1																								45	0.8	7	18	12	8.2
KS 8512 -L1																								45	0.8	7	18	12	8.5
KS 1014 -L1																								45	0.8	7	22	14	10
KS 10514-L1																								55	0.8	7	22	14	10.5
KS 1114 -L1																								55	0.8	7	22	14	11
KS 1216 -L1																								45	0.8	7	22	16	12
KS 12516-L1																								55	0.8	7	22	16	12.5
KS 1418 -L1																								55	0.8	9	24	18	14
KS 1620 -L1																								55	0.8	9	26	20	16
KS 1822 -L1																								55	0.8	9	28	22	18

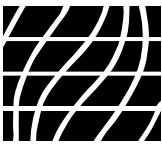

S Typ(e)

● Ejector Sleeves - inch - nitrided

○ Trubkový vyhazovač - palcové míry - nitridovaný

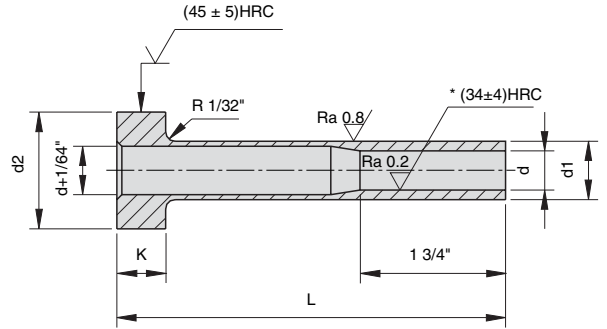

500°- 550°C
Mat. H13

* min 950 Hv 0.3 ● Upon request ○ Na požádání

REF	L ^{+0.375"} _{-0.000"}												K ^{+0.000"} _{-0.002"}	d ₂ ^{+0.000"} _{-0.010"}	d ₁ ^{+0.000"} _{-0.001"}	d ^{+0.0005"} _{-0.0000"}
	3"	4"	5"	6"	7"	8"	9"	10"	11"	12"						
S 13 -L												3/16"	3/8"	3/16"	3/32"	
S 15 -L												3/16"	12/32"	7/32"	1/8"	
S 17 -L												3/16"	7/16"	1/4"	5/32"	
S 21 -L												1/4"	1/2"	5/16"	3/16"	
S 23 -L												1/4"	9/16"	11/32"	7/32"	
S 25 -L												1/4"	5/8"	3/8"	1/4"	
S 29 -L												1/4"	11/16"	7/16"	5/16"	
S 33 -L												1/4"	3/4"	1/2"	3/8"	
S 37 -L												1/4"	7/8"	5/8"	7/16"	
S 39 -L												1/4"	15/16"	11/16"	1/2"	
S 41 -L												1/4"	1"	3/4"	9/16"	
S 45 -L												1/4"	1 1/8"	7/8"	5/8"	
S 47 -L												1/4"	1 1/4"	1"	3/4"	



WZ 7065 Typ(e) D
DIN 9861- HWS

WZ 7075 Typ(e) D
DIN 9861- HSS

● Punches - hardened

○ Razníky - kalené

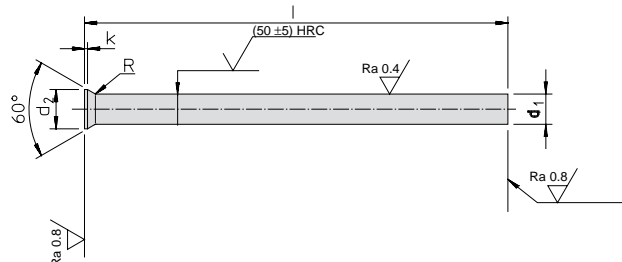
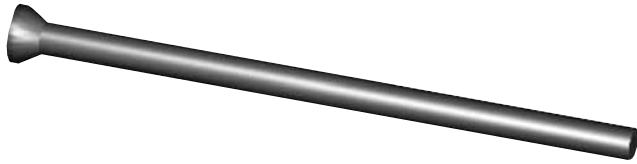

R = ● rounded-off ○ zaobleno

Mat. HWS 12% Cr 62 ± 2 HRC

Mat. HSS 62 ± 2 HRC

REF	d ₁ h ⁶	L ^{+0,5} ₀			d ₂ -0,05	Step Krok	K +0,2 0	REF	d ₁ h ⁶	L ^{+0,5} ₀				d ₂ -0,05	Step Krok	K +0,2 0
		71	80	100						71	80	100	130			
WZ 7065 0,50	-L				0.9	0.05	0.2	WZ 7075 0,50	-L					0.9	0.05	0.2
WZ 7065 0,55	L				1.0	0.05	0.2	WZ 7075 0,55	L					1.0	0.05	0.2
WZ 7065 0,60	-L				1.1	0.05	0.2	WZ 7075 0,60	-L					1.1	0.05	0.2
WZ 7065 0,65	-L				1.2	0.05	0.2	WZ 7075 0,65	-L					1.2	0.05	0.2
WZ 7065 0,70-0,75	-L				1.3	0.05	0.2	WZ 7075 0,70-0,75	-L					1.3	0.05	0.2
WZ 7065 0,80-0,85	-L				1.4	0.05	0.4	WZ 7075 0,80-0,85	-L					1.4	0.05	0.4
WZ 7065 0,90-0,95	-L				1.6	0.05	0.4	WZ 7075 0,90-0,95	-L					1.6	0.05	0.4
WZ 7065 1,00-1,10	-L				1.8	0.05	0.5	WZ 7075 1,00-1,10	-L					1.8	0.05	0.5
WZ 7065 1,15-1,30	-L				2.0	0.05	0.5	WZ 7075 1,15-1,30	-L					2.0	0.05	0.5
WZ 7065 1,35-1,50	-L				2.2	0.05	0.5	WZ 7075 1,35-1,50	-L					2.2	0.05	0.5
WZ 7065 1,55-1,70	-L				2.5	0.05	0.5	WZ 7075 1,55-1,70	-L					2.5	0.05	0.5
WZ 7065 1,75-1,90	-L				2.8	0.05	0.5	WZ 7075 1,75-1,90	-L					2.8	0.05	0.5
WZ 7065 1,95-2,00	-L				3.0	0.05	0.5	WZ 7075 1,95-2,00	-L					3.0	0.05	0.5
WZ 7065 2,05-2,20	-L				3.2	0.05	0.5	WZ 7075 2,05-2,20	-L					3.2	0.05	0.5
WZ 7065 2,25-2,50	-L				3.5	0.05	0.5	WZ 7075 2,25-2,50	-L					3.5	0.05	0.5
WZ 7065 2,55-2,95	-L				4.0	0.05	0.5	WZ 7075 2,55-2,95	-L					4.0	0.05	0.5
WZ 7065 3,00-3,40	-L				4.5	0.05	0.5	WZ 7075 3,00-3,40	-L					4.5	0.05	0.5
WZ 7065 3,50-3,90	-L				5.0	0.05	0.5	WZ 7075 3,50-3,90	-L					5.0	0.05	0.5
WZ 7065 4,00-4,40	-L				5.5	0.05	0.5	WZ 7075 4,00-4,40	-L					5.5	0.05	0.5
WZ 7065 4,50-4,90	-L				6.0	0.05	0.5	WZ 7075 4,50-4,90	-L					6.0	0.05	0.5
WZ 7065 5,00-5,40	-L				6.5	0.05	0.5	WZ 7075 5,00-5,40	-L					6.5	0.05	0.5
WZ 7065 5,50-5,90	-L				7.0	0.05	0.5	WZ 7075 5,50-5,90	-L					7.0	0.05	0.5
WZ 7065 6,00-6,40	-L				8.0	0.05	1.0	WZ 7075 6,00-6,40	-L					8.0	0.05	1.0
WZ 7065 6,50-7,40	-L				9.0	0.05	1.0	WZ 7075 6,50-7,40	-L					9.0	0.05	1.0
WZ 7065 7,50-8,40	-L				10.0	0.05	1.0	WZ 7075 7,50-8,40	-L					10.0	0.05	1.0
WZ 7065 8,50-9,40	-L				11.0	0.10	1.0	WZ 7075 8,50-9,40	-L					11.0	0.10	1.0
WZ 7065 9,50-10,40	-L				12.0	0.10	1.0	WZ 7075 9,50-10,40	-L					12.0	0.10	1.0
WZ 7065 10,50-11,40	-L				13.0	0.10	1.0	WZ 7075 10,50-11,40	-L					13.0	0.10	1.0
WZ 7065 11,50-12,40	-L				14.0	0.10	1.0	WZ 7075 11,50-12,40	-L					14.0	0.10	1.0
WZ 7065 12,50-13,40	-L				15.0	0.10	1.0	WZ 7075 12,50-13,40	-L					15.0	0.10	1.0
WZ 7065 13,50-14,40	-L				16.0	0.10	1.0	WZ 7075 13,50-14,40	-L					16.0	0.10	1.0
WZ 7065 14,50-15,00	-L				17.0	0.10	1.5	WZ 7075 14,50-15,00	-L					17.0	0.10	1.5
WZ 7065 15,10-16,00	-L				18.0	0.10	1.5	WZ 7075 15,10-16,00	-L					18.0	0.10	1.5
WZ 7065 16,50-17,00	-L				19.0	0.50	1.5	WZ 7075 16,50-17,00	-L					19.0	0.50	1.5
WZ 7065 17,50-18,00	-L				20.0	0.50	1.5	WZ 7075 17,50-18,00	-L					20.0	0.50	1.5
WZ 7065 18,50-19,00	-L				21.0	0.50	1.5	WZ 7075 18,50-19,00	-L					21.0	0.50	1.5
WZ 7065 19,50-20,00	-L				22.0	0.50	1.5	WZ 7075 19,50-20,00	-L					22.0	0.50	1.5
WZ 7065 21,00	-L				23.0	0.50	1.5	WZ 7075 21,00	-L					23.0	0.50	1.5
WZ 7065 22,00	-L				24.0	0.50	1.5	WZ 7075 22,00	-L					24.0	0.50	1.5
WZ 7065 23,00	-L				25.0	0.50	1.5	WZ 7075 23,00	-L					25.0	0.50	1.5
WZ 7065 24,00	-L				26.0	0.50	1.5	WZ 7075 24,00	-L					26.0	0.50	1.5
WZ 7065 25,00	-L				27.0	0.50	1.5	WZ 7075 25,00	-L					27.0	0.50	1.5
WZ 7065 26,00	-L				28.0	0.50	1.5	WZ 7075 26,00	-L					28.0	0.50	1.5
WZ 7065 27,00	-L				29.0	0.50	1.5	WZ 7075 27,00	-L					29.0	0.50	1.5
WZ 7065 28,00	-L				30.0	0.50	1.5	WZ 7075 28,00	-L					30.0	0.50	1.5
WZ 7065 29,00	-L				31.0	0.50	1.5	WZ 7075 29,00	-L					31.0	0.50	1.5
WZ 7065 30,00	-L				32.0	0.50	1.5	WZ 7075 30,00	-L					32.0	0.50	1.5

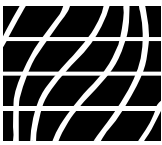

● Custom-made ejector pins and sleeves

○ Vyhazovače a trubkové vyhazovače - dle poptávky

Info

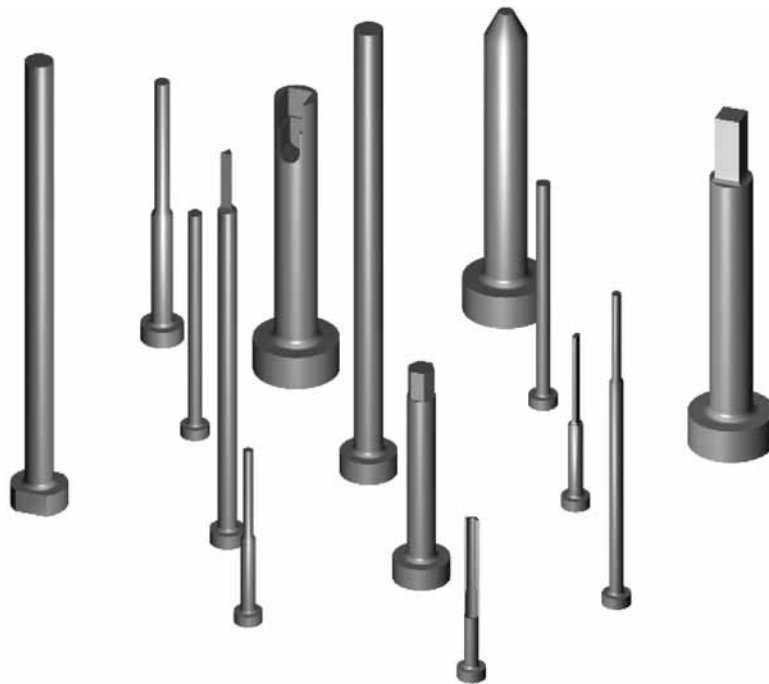

● Special ejector pins, core pins and ejector sleeves

When you want pins with special shapes such as tapers or contours – special head sizes – special hardness, special material up to any length.

Now into specials in an expanded way, we have the manufacturing, heat treating, and sophisticated quality control equipment to meet your requirements for special ejector pins, core pins, ejector sleeves.

Special pins match the precision manufacturing of all our standards in every detail.

○ Speciální vyhazovače, jádrové kolíky a trubkové vyhazovače

Pokud potřebujete vyhazovače speciálního tvaru jako např. jiné osazení nebo velikost hlavy, odlišnou tvrdostí a nebo materiálem v jakékoliv délce.

Zlepšili jsme možnosti výroby speciálních vyhazovačů. Máme výkonné přístroje pro zjišťování kvality všech druhů speciálních kolíků, jádrových kolíků, trubkových vyhazovačů. Je zajištěn nejrychlejší servis.

Speciální kolíky se přesností a kvalitou vyrovnají našim standardním produktům.

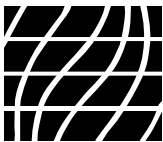

● Custom-made ejector pins

○ Vyhazovače a trubkové vyhazovače - dle poptávky

Info

● Please specify required tolerances on all dimensions

○ Prosím, zadejte tolerance všech potřebných rozměrů

Comments:

Poznámky:

Company: _____

Firma: _____

Contact: _____

Kontakt: _____

Tel. _____

Tel. _____

Fax: _____

Fax: _____

Quantity: _____

Počet: _____

Mat.: _____

Mat.: _____

Hardness: _____ HRC

Tvrđost: _____ HRC

Delivery date: _____

Dodací termín: _____

Nitrite: Yes

Nitridace: Ano

Signature: _____

Podpis: _____

Order number: _____

Číslo objednávky: _____

	● Dimensions ○ Rozměry	● Tolerances ○ Tolerance
d1		
d2		
K		
R		
L		

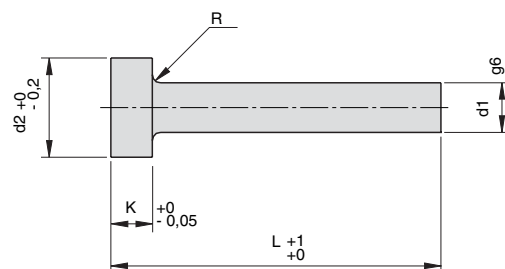

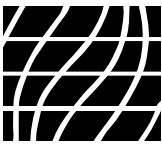

● Custom-made ejector pins

○ Vyhazovače a trubkové vyhazovače - dle poptávky

Info

● Please specify required tolerances on all dimensions

○ Prosím, zadejte tolerance všech potřebných rozměrů

Comments:

Poznámky:

Company: _____

Firma: _____

Contact: _____

Kontakt: _____

Tel. _____

Tel. _____

Fax: _____

Fax: _____

Quantity: _____

Počet: _____

Mat.: _____

Mat.: _____

Hardness: _____ HRC

Tvrdost: _____ HRC

Delivery date: _____

Dodací termín: _____

Nitrite: Yes

Nitridace: Ano

Signature: _____

Podpis: _____

Order number: _____

Číslo objednávky: _____

	● Dimensions ○ Rozměry	● Tolerances ○ Tolerance
d1		
d2		
d3		
L1		
L2		
K		
R		

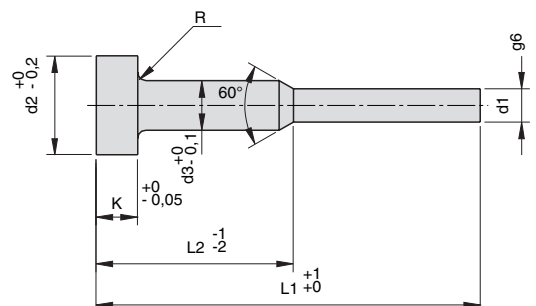

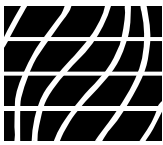

● Custom-made ejector pins

○ Vyhazovače a trubkové vyhazovače - dle poptávky

Info

● Please specify required tolerances on all dimensions

○ Prosím, zadejte tolerance všech potřebných rozměrů

Comments:

Poznámky:

Company: _____

Firma: _____

Contact: _____

Kontakt: _____

Tel. _____

Tel. _____

Fax: _____

Fax: _____

Quantity: _____

Počet: _____

Mat.: _____

Mat.: _____

Hardness: _____ HRC

Tvrdost: _____ HRC

Delivery date: _____

Dodací termín: _____

Nitrite: Yes

Nitridace: Ano

Signature: _____

Podpis: _____

Order number: _____

Číslo objednávky: _____

	● Dimensions ○ Rozměry	● Tolerances ○ Tolerance
d1		
d2		
d3		
d4		
L1		
L2		
L3		
K		
R		

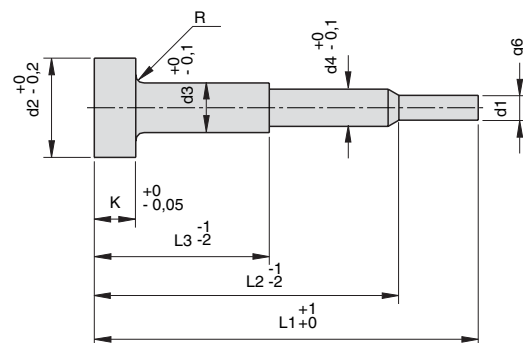

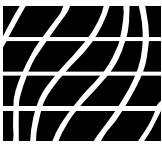

● Custom-made ejector sleeves

○ Vyhazovače a trubkové vyhazovače - dle poptávky

Info

● Please specify required tolerances on all dimensions

○ Prosím, zadejte tolerance všech potřebných rozměrů

Comments:

Poznámky:

Company: _____

Firma: _____

Contact: _____

Kontakt: _____

Tel. _____

Tel. _____

Fax: _____

Fax: _____

Quantity: _____

Počet: _____

Mat.: _____

Mat.: _____

Hardness: _____ HRC

Tvrdość: _____ HRC

Delivery date: _____

Dodací termín: _____

Nitrite: Yes

Nitridace: Ano

Signature: _____

Podpis: _____

Order number: _____

Číslo objednávky: _____

	● Dimensions ○ Rozměry	● Tolerances ○ Tolerance
d		
d1		
d2		
L1		
L2		
K		
R		

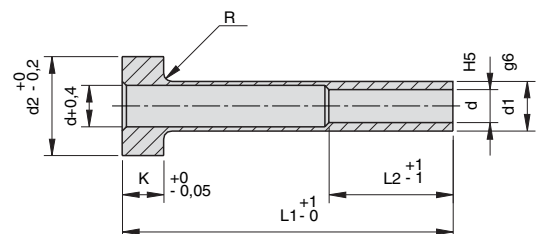



● Custom-made ejector sleeves

○ Vyhazovače a trubkové vyhazovače - dle poptávky

Info

● Please specify required tolerances on all dimensions

○ Prosím, zadejte tolerance všech potřebných rozměrů

Comments:

Poznámky:

Company: _____

Firma: _____

Contact: _____

Kontakt: _____

Tel. _____

Tel. _____

Fax: _____

Fax: _____

Quantity: _____

Počet: _____

Mat.: _____

Mat.: _____

Hardness: _____ HRC

Tvrdost: _____ HRC

Delivery date: _____

Dodací termín: _____

Nitrite: Yes

Nitridace: Ano

Signature: _____

Podpis: _____

Order number: _____

Číslo objednávky: _____

	● Dimensions ○ Rozměry	● Tolerances ○ Tolerance
d1		
d2		
K		
R1		
R2		
a		
b		
L1		
L2		

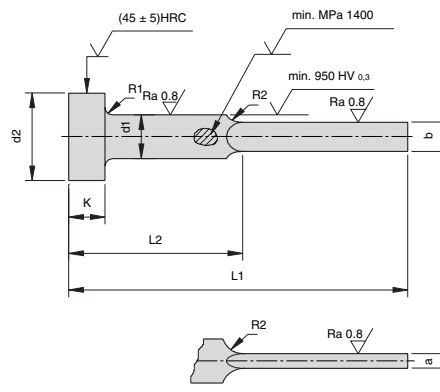

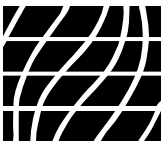

BE - BA - BT CUMSA

● Retainers for Ejector pins and Ejector sleeves

○ Upínač pro vyhazovač a trubkový vyhazovač

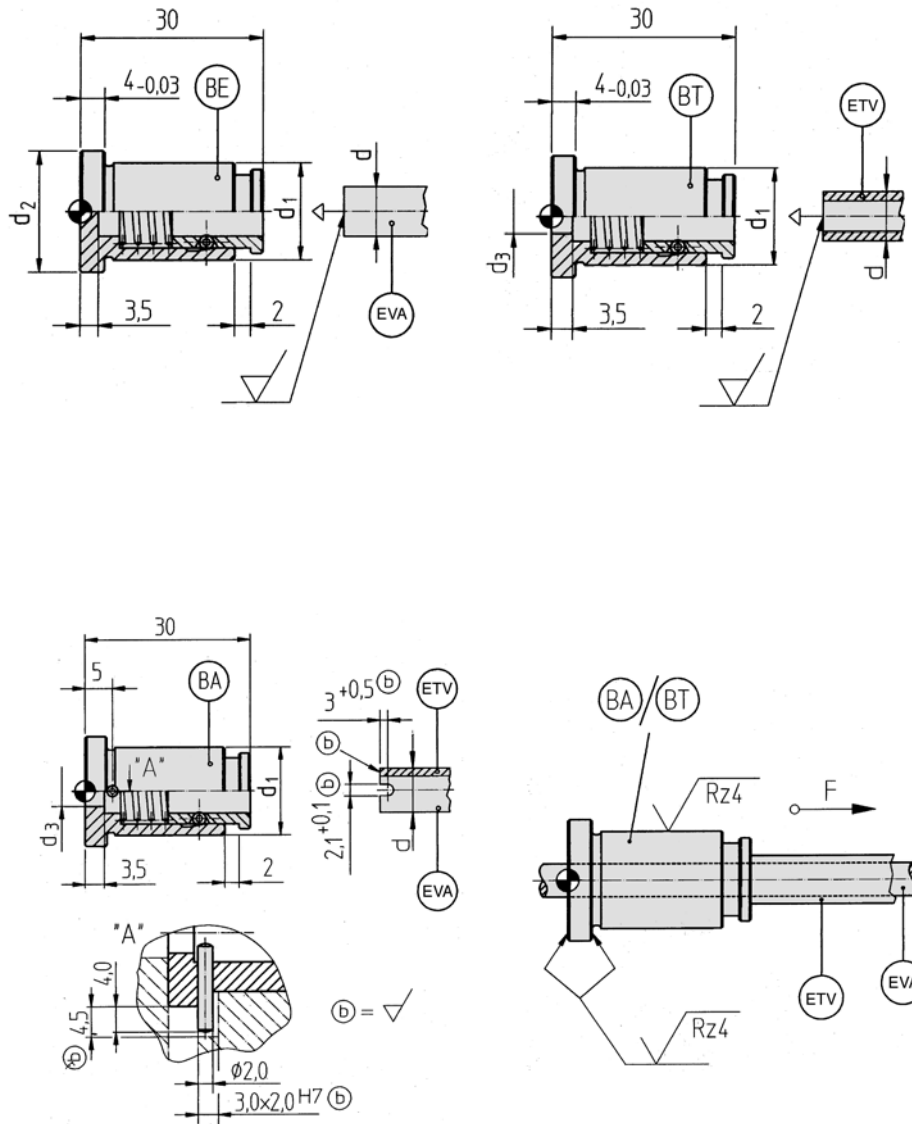

Mat. 1.7264 - 60 HRC
T max 100°C

REF BE	REF BA	REF BT	d	d ₁	d ₂	d ₃	F [N]
BE 031115			3	11	15	-	≤2550
BE 041216			4	12	16	-	≤2550
BE 051317			5	13	17	-	≤3800
	BA 061418	BT 061418	6	14	18	4.2	≤3800
	BA 081620	BT 081620	8	16	20	6	≤5100
	BA 101822	BT 101822	10	18	22	7	≤6400
	BA 122024	BT 122024	12	20	24	9	≤7600

● CAD datum point
○ CAD Referenční bod

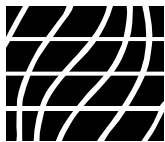

EVA

● Ejector pins without head

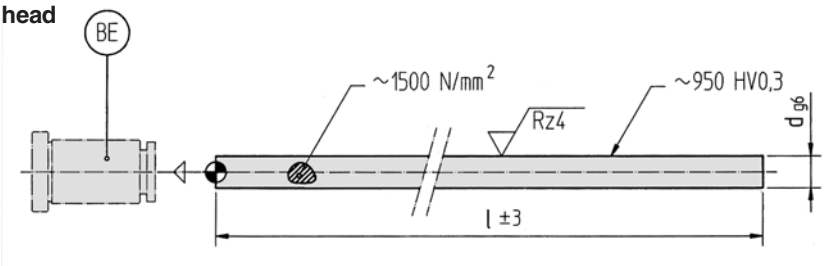

○ Vyhazovač bez hlavy

- Locking recess (BA) has to be carried out by customer
- Vybrání proti pootočení (BA) provádí zákazník

- CAD datum point
- CAD-Referenční bod

Mat. 1.2510-60 ± 2 HRC

REF	d	L	REF	d	L	REF	d	L
EVA 3-600	3	600	EVA 6-800	6	800	EVA 10-1000	10	1000 _{.10}
EVA 3-800	3	800	EVA 8-355	8	355	EVA 12-355	12	355
EVA 4-600	4	600	EVA 8-600	8	600	EVA 12-400	12	400
EVA 5-600	5	600	EVA 8-800	8	800	EVA 12-600	12	600
EVA 5-800	5	800	EVA 8-1000	8	1000 _{.10}	EVA 12-800	12	800
EVA 6-100	6	100	EVA 10-355	10	355	EVA 12-1000	12	1000 _{.10}
EVA 6-400	6	400	EVA 10-600	10	600			
EVA 6-600	6	600	EVA 10-800	10	800			

● Special sizes upon request ○ Speciální velikosti na poptávku

ETV

● Ejector sleeves without head

○ Trubkový vyhazovač bez hlavy

- Only for injection molds
- Important: The length should be adjusted by cutting off at the clearance hole end
- Locking recess (BA) has to be carried out by customer

- Pouze pro vstříkovací formy
- Důležité: Délka může být upravena zkrácením na straně otvoru s vůlí (d2)
- Vybrání proti pootočení (BA) provádí zákazník

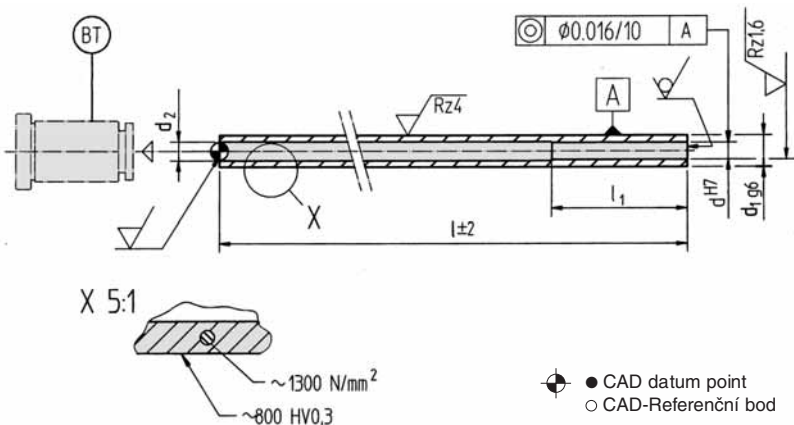

- CAD datum point
- CAD-Referenční bod

Mat. 1.8550 - ● nitrided ○ nitridováno

REF	d	d ₁	d ₂	L	L ₂	REF	d	d ₁	d ₂	L	L ₂
ETV 6-3-300	3	6	3,2	300	30	ETV 10-6-300	6	10	6,2	300	40
ETV 6-3-400	3	6	3,2	500	30	ETV 10-6-400	6	10	6,2	400	40
ETV 6-3-500	3	6	3,2	500	30	ETV 10-6-500	6	10	6,2	500	40
ETV 6-3-600	3	6	3,2	600	30	ETV 10-6-600	6	10	6,2	600	40
ETV 6-3-800	3	6	3,2	800	30	ETV 10-6-800	6	10	6,2	800	40
ETV 8-5-300	5	8	5,2	300	35	ETV 12-8-300	8	12	8,2	300	45
ETV 8-5-400	5	8	5,2	400	35	ETV 12-8-400	8	12	8,2	400	45
ETV 8-5-500	5	8	5,2	500	35	ETV 12-8-500	8	12	8,2	500	45
ETV 8-5-600	5	8	5,2	600	35	ETV 12-8-600	8	12	8,2	600	45
ETV 8-5-800	5	8	5,2	800	35	ETV 12-8-800	8	12	8,2	800	45

● Special sizes upon request ○ Speciální velikosti na poptávku

**DP CUMSA**

● Installation example

○ Příklad použití

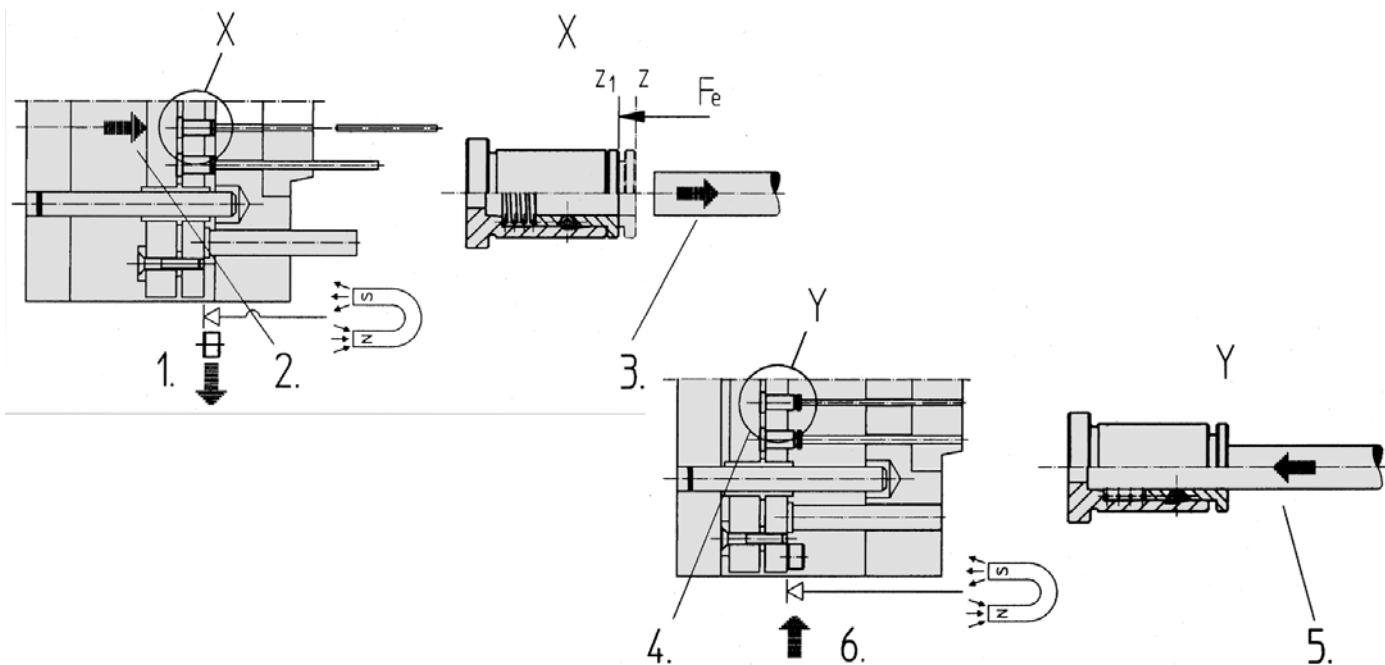

● Installation example

1. Remove the magnetic spreader
2. Move the ejector plates forward from 'Z' into the final front position 'Z1'
3. Remove the ejectors and sleeves from the opened tool separation.
4. Return the ejector plates into the rear position.
5. Replace new ejectors and sleeves with light pressure
6. Replace the magnetic spreader

○ Příklad použití

1. Vytáhnout magnetickou rozpěrku
2. Posunout vyhazovací desky z polohy 'Z' dozadu do koncové polohy 'Z1'
3. Při otevřeném nástroji vyjmout vyhazovače a trubkové vyhazovače
4. Vyhazovací desky posunout do koncové zadní polohy
5. Malým tlakem nasadit nové vyhazovače nebo trubkové vyhazovače
6. Znovu umístit magnetickou rozpěrku

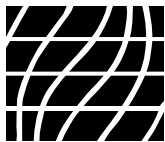

AW 275 CUMSA

● Flexible ejector (with mounting thread)

○ Pružný vyhazovač (se závitem pro připevnění)

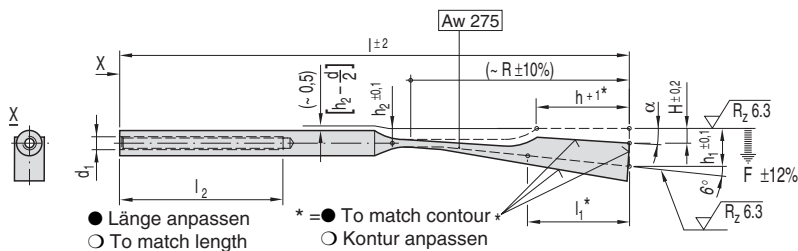

○ délku upravit

* ○ tvar přizpůsobit

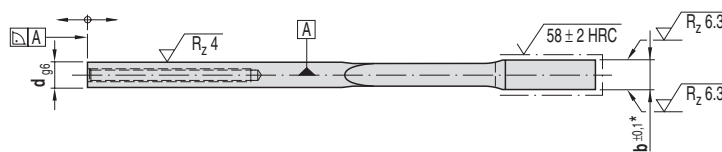

Mat. 1.8159 - 45 ±3 HRC

REF	d	b*	d ₁	h*	h ₁	h ₂	H	l	l ₁	l ₂	R	α	F
											±10%		±12%(N)
AW 275 06 - 6,2	M4		M4	22	9.0	3.5	3.5	125	25	40	58	-3,50°	40
AW 275 06 - 8,2	M4		M4	22	9.0	3.5	3.5	125	25	40	58	-3,50°	40
AW 275 08 - 8,2	M5		M5	25	11.5	4.5	4.5	140	30	50	63	-4,00°	80
AW 275 08 - 10,2	M5		M5	25	11.5	4.5	4.5	140	30	50	63	-4,00°	80
AW 275 08 - 12,2	M5		M5	25	11.5	4.5	4.5	140	30	50	63	-4,00°	80
AW 275 10 - 14,2	M6		M6	30	15.0	5.5	5.5	175	38	60	75	-4,25°	120
AW 275 10 - 16,2	M6		M6	30	15.0	5.5	5.5	175	38	60	75	-4,25°	120
AW 275 10 - 18,2	M6		M6	30	15.0	5.5	5.5	175	38	60	75	-4,25°	120

● Typical Applications

○ Příklady použití

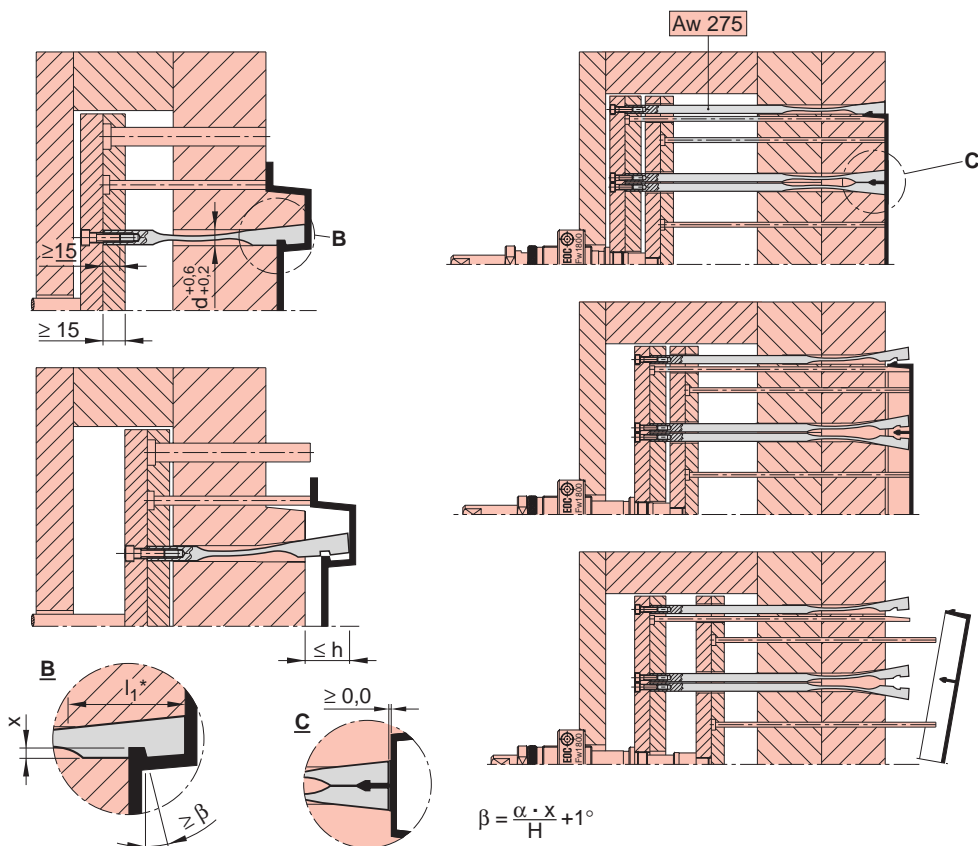

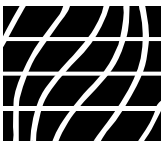

AW 280 CUMSA

● Flexible Ejector (with mounting thread)

○ Pružný vyhazovač (se závitem pro připevnění)

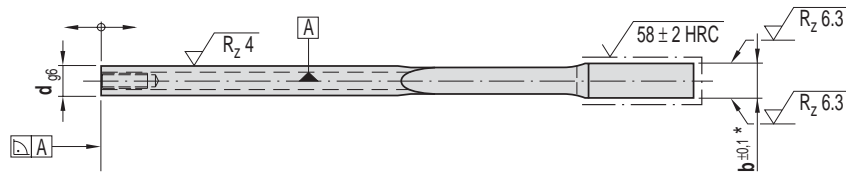
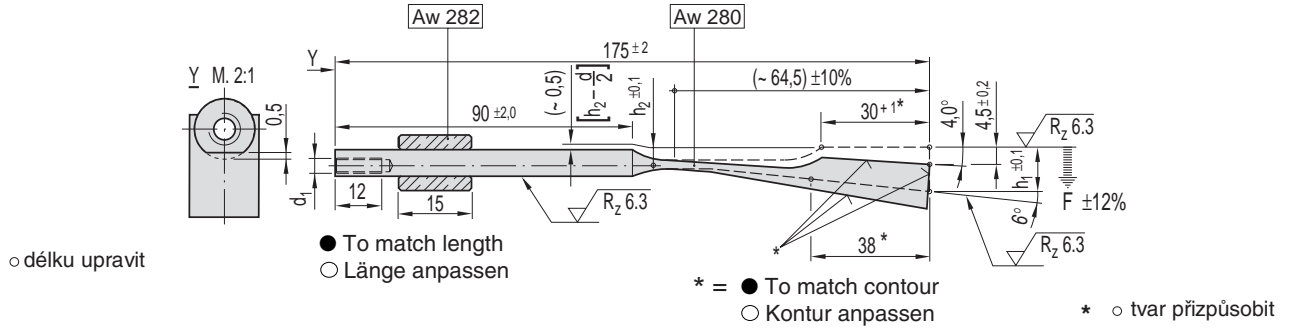

Mat. 1.8159 - 45 ±3 HRC

REF	d	b'	d ₁	h ₁	h ₂	F	Incl.-Včetně	REF	d	b'	d ₁	h ₁	h ₂	F	Incl.-Včetně
AW 280 06 - 6,2	M4		10,0	3,5	40	AW 282 6	AW 280 08 - 12,2	M5	11,2	4,5	80	AW 282 8			
AW 280 06 - 8,2	M4		10,0	3,5	40	AW 282 6	AW 280 10 - 15,2	M6	13,6	5,5	120	AW 282 10			
AW 280 08 - 10,2	M5		11,2	4,5	80	AW 282 6	AW 280 10 - 18,2	M6	13,6	5,5	120	AW 282 10			

AW 281 CUMSA

● Flexible Ejector - Clamping guides (for AW 280)
○ Pružný vyhazovač - Upínací vedení (pro AW 280)

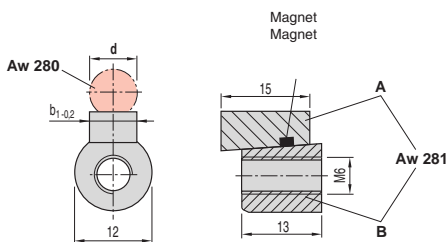

Mat. 1.2510 - 52 ±3 HRC

AW 282 CUMSA

● Flexible Ejector - Guide Bushes
○ Pružný vyhazovač - Vodicí pouzdro

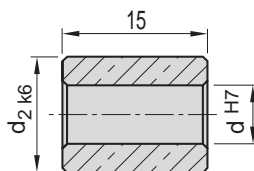

Mat. Bronze

AW 283 CUMSA

● Flexible Ejector - Extensions
○ Pružný vyhazovač - Prodloužení

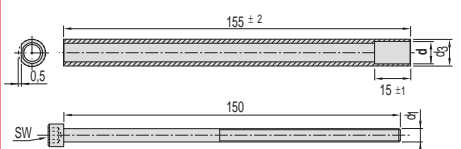

Mat. 1.7225 - 50 ±3 HRC

REF	d	b ₁	l ₃	REF	d	d ₂	REF	d	d ₁	SW	d ₃	l ₄
AW 281 6		6	13.5	AW 282 6		12	AW 283 6	M4	3	8	14.5	
AW 281 8		8	14.5	AW 282 8		12	AW 283 8	M5	4	10	15.5	
AW 281 10		10	15.5	AW 282 10		16	AW 283 10	M6	5	12	16.5	



AW 280, AW 281, AW 282, AW 283 CUMSA

● Flexible Ejector - Installation instructions
Typical applications

○ Pružný vyhazovač - pokyny pro montáž
Typické aplikace

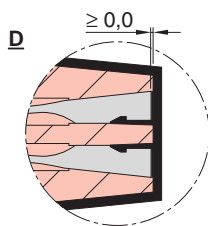
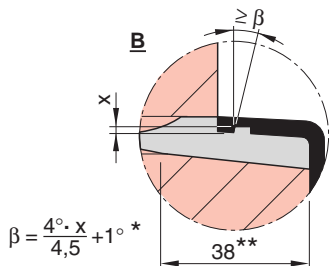
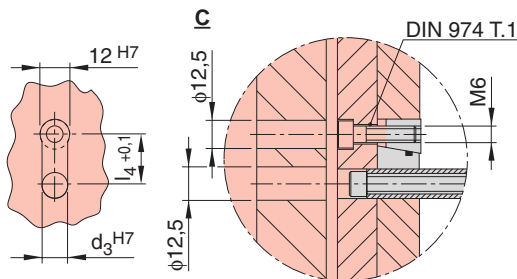
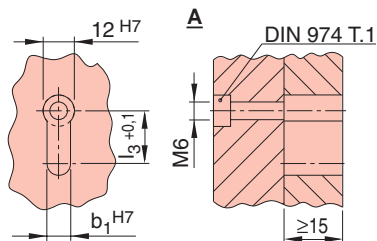
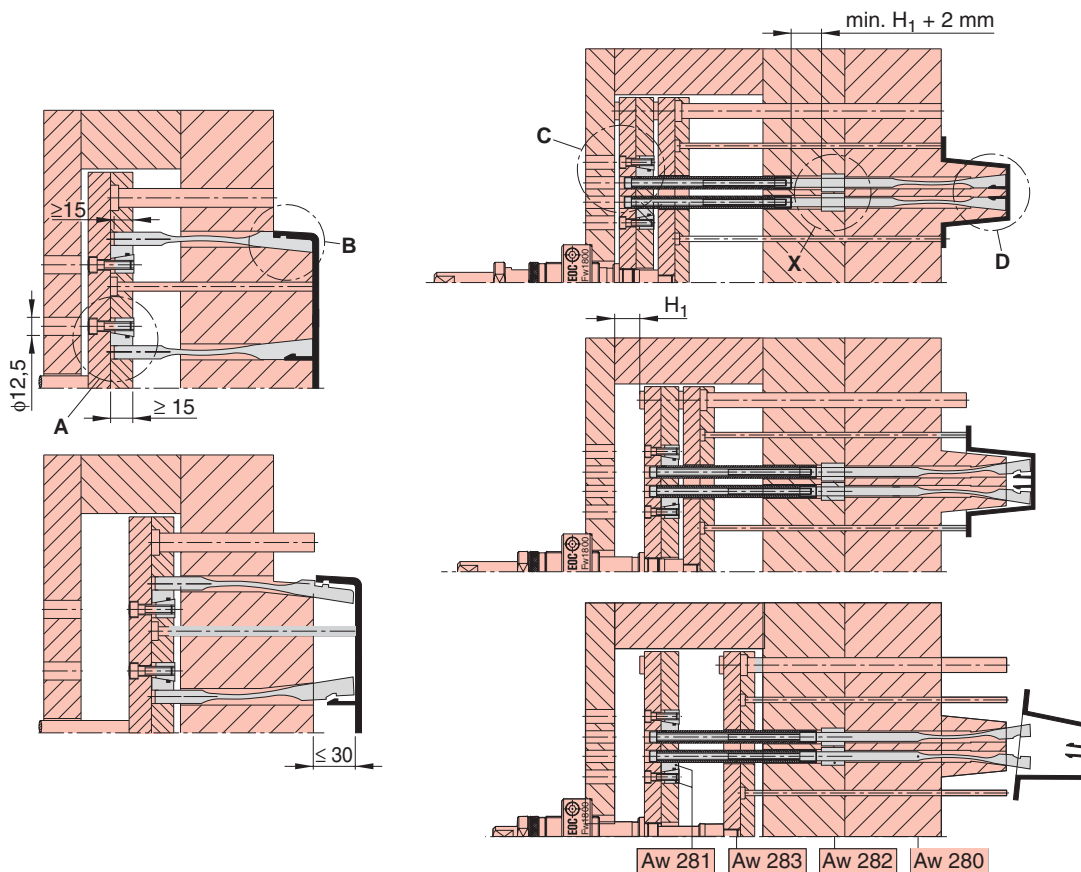

X

- For large buckling lengths, please use guide bushes AW 282
- Pro větší délky doplňte vhodné vodičí pouzdro AW 282

* = ● depending on surface roughness
○ závislé na drsnosti povrchu

** = ● To match the contour
○ tvar přizpůsobit

